

DESIGNED BY	DRAWN BY	CHECKED BY	DATE	REVIEWED	DATE	APPROVED	DATE	NO.	DATE	BY	REVISIONS
			10/31/43		12/31/43			1			4
			10/31/43		12/31/43			2			5
			10/31/43		12/31/43			3			6

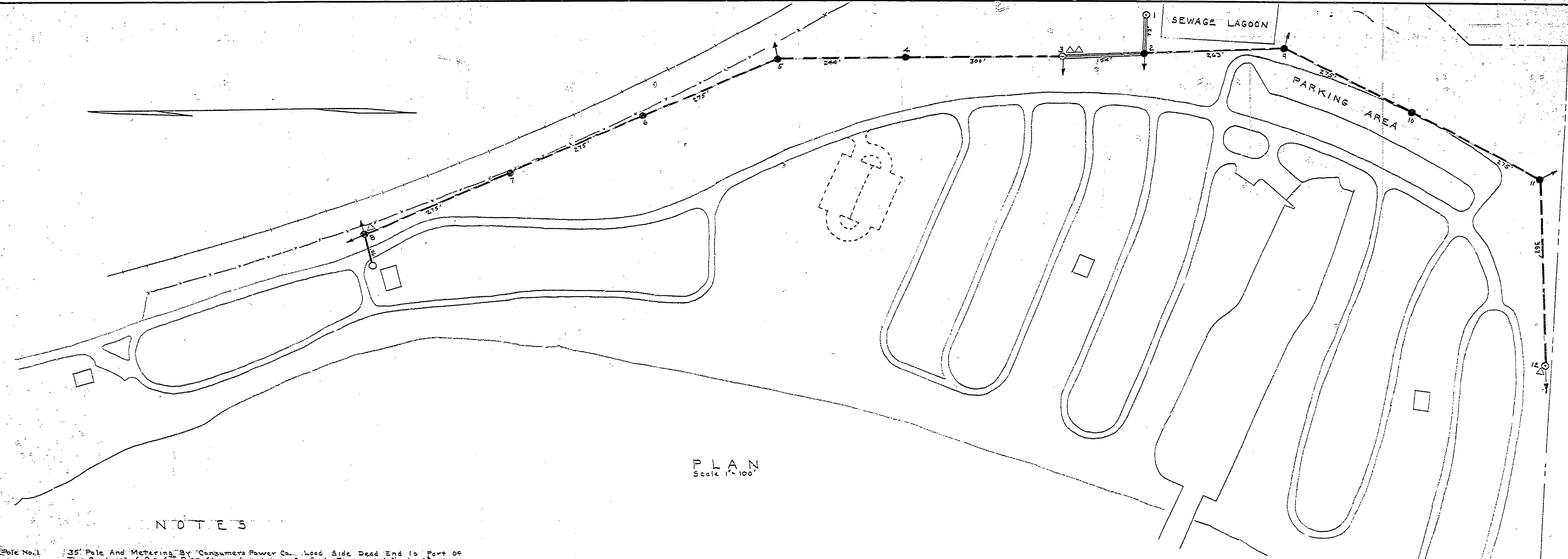

NOTES

- Pole No. 1 35' Pole And Metering By Consumers Power Co. Load Side Dead End Is Part Of This Contract (2-6" Disc Strain Insulators On Each Phase & 1 Neutral)
- Pole No. 2 40' Class 4 2-6" Messenger With 15' Guy Lead To Twineye Rod And Screw Anchor (See Detail For Additional Information) 1 Porcelain Insulator In Messenger
- Pole No. 3 40' Class 4 Southern Yellow Pine Install 6 Pin Double Arm And Dead End X & Y Phases To The South And Dead End Y Phase To The North In Pole Position. Install 2' Arm With 10' Arm For Cutout At Below Line Arm. Install Wood Pin In 2' Arm West Side Pole Position For Neutral. Cluster Mount 1 150 KVA & 1 10 KVA Transformer At 25' Mounting Height As Per Consumers Power Co. Specifications Page 10-181 Of Their Overhead Construction Standards. Connect 100 KVA To X Phase. Connect Primary Open Wye. Secondary Connection To Be 4 Wire Open Delta 10M Messenger 1/4" Guy Lead. 1 Porcelain Insulator In Guy Messenger To Screw Anchor. Primary Guy Attached 24" Below. Maximum Combined Transformer Weight 1500 Lb.
- Pole No. 4, 6, 7, 10 35' Class 6 Pole. 15' Pole Top Wood Pin For Phase Wire. Neutral Wire 6" Down On Neutral Bracket (See Detail).
- Pole No. 5, 11 35' Class 6 Pole. Vertical Pull Off (2-6" Disc Strain Insulators On Phase Wire, Neutral Pull Off On Neutral Wire) 5' Spacing. Install 10M Messenger With 10' Guy Lead. 1 Porcelain Insulator In Guy Messenger To Screw Anchor. Attach Guy Midway Between Phase & Neutral Wire.
- Pole No. 9 Same As Poles 5 & 11 Except Guy Lead 15'
- Pole No. 8, 12 40' Class 4 Southern Yellow Pine Pole. Install 6 Pin Single Cross Arm At Pole Top. Dead End Phase Wire On 2-6" Disc Strain Insulator And 20" Strap At Pole Position. 150 KVA Transformer 5' Down As Per Page 10-82 I of Consumers Power Co. Specifications. Dead End Neutral In Secondary Position. On 1 Wire Rack. Install 2-6" Messenger With 15' Guy Lead. 1 Porcelain Insulator In Guy Messenger To Twineye Rod And Screw Anchor.
- Pole No. 8 Additional Information. Install Guy Guayd. Install 6M Messenger With 15' Guy Lead. 1 Porcelain Insulator In Guy Messenger To Screw Anchor Against Service.

Connections To The Existing Secondary Are A Part Of This Contract. Primary Voltage Is 7200/12540 Grounded Wye.

KEY

- 1 Phase Wire = 4 Aluminum Cable Steel Reinforced & 1-#4 ACSR Neutral
- 2 Phase Wires Each #4 ACSR & 1-#4 ACSR Neutral
- Existing Pole Or Pole By Others (All Equipment Listed For Pole Detail Part Of Contract)
- Proposed Poles
- Secondary Service Drop 3-#6 Copper
- Anchor Guy
- Transformer

