

DESIGNED BY	W. W. VALENS	DATE	3-5-55
DRAWN BY	J. YEMPA	REVIEWED	LANDSCAPE
CHECKED BY		DATE	
APPROVED		DATE	
REVISIONS		NO.	DATE
		1	
		2	
		3	
		4	
		5	
		6	

MATERIAL

CLASS "A" STONE: CLASS "A" STONE SHALL BE SOUND, TOUGH, DURABLE ROCK, FREE FROM STRUCTURAL DEFECTS. INDIVIDUAL STONES SHALL WEIGH NOT LESS THAN 350 LBS. AND MEASURE NOT LESS THAN 12 INCHES IN LEAST DIMENSION.

CLASS "B" STONE: CLASS "B" STONE SHALL BE SOUND, TOUGH, DURABLE ROCK, FREE FROM STRUCTURAL DEFECTS. INDIVIDUAL STONES SHALL BE RANDOM SHAPED WEIGHING NOT LESS THAN 20 LBS. AND MEASURING NOT LESS THAN 6 INCHES IN LEAST DIMENSION.

CLASS "C" STONE: CLASS "C" STONE SHALL BE QUARRY SPALLS, CRUSHED ROCK OR GRAVEL CONTAINING STONES NOT LARGER THAN 4 INCHES IN GREATEST DIMENSION.

PLACEMENT

CLASS "A" STONE: CLASS "A" STONE SHALL BE RANDOM PLACED EXCEPT THAT THE LAYER OF STONE SHALL BE NOT LESS THAN TWO STONES THICK AND THE SURFACE STONES SHALL CONFORM WITHIN REASONABLE LIMITS TO THE GRADE AND SLOPE SHOWN ON THE TYPICAL SECTION.

CLASS "B" STONE: CLASS "B" STONE SHALL BE RANDOM PLACED AND THE MOUND SHAPED TO RECEIVE THE CLASS "A" STONE AS SHOWN IN THE TYPICAL SECTION.

CLASS "C" STONE: CLASS "C" STONE SHALL BE SPREAD IN A UNIFORM LAYER NOT LESS THAN 12 INCHES OR MORE THAN 18 INCHES THICK. OMIT CLASS "C" STONE WHERE GROUND ELEVATION IS ABOVE 594.00.

NOTE: SOME SETTLEMENT OF THE LAKE BOTTOM MAY OCCUR DURING CONSTRUCTION OF THE BREAKWATER AND THE CLASS "A" & "B" STONE QUANTITIES WERE COMPUTED WITH AN ALLOWANCE FOR SETTLEMENT OF ONE-THIRD THE DEPTH OF THE UNDERLYING MARL AS SHOWN IN THE TEST BORINGS. IN ADDITION 10% WAS ADDED TO ALL STONE QUANTITIES FOR SHRINKAGE AND LOSS.

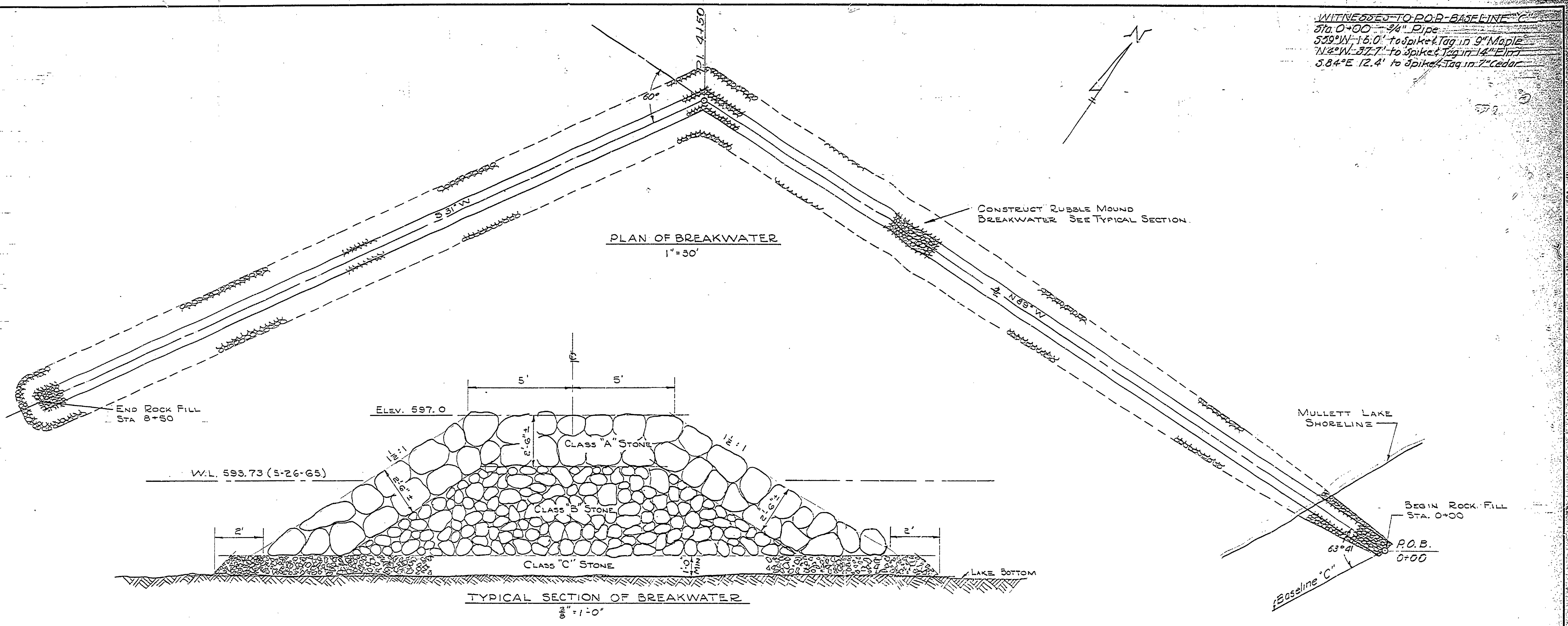

WITNESSED TO P.O.B. BASELINE "C"
 STA. 0+00 - 94" PIPE
 509°W-16.0' to spike & tag in 9" Maple
 N42°W-37.7' to spike & tag in 14" Elm
 S84°E-12.4' to spike & tag in 7" Cedar

