

WITNESSES TO STA 1000/50100 (P/NWD)
 N116°E, 45.50', 15' MARK
 S78°E, 46.20', 15' MARK

BM #30 ELEV. 607.25
 EX. SPICE IN EXIST. SIDE
 OF 50' WIDE. 21' LT.
 STA 51171

WITNESSES TO STA 57100.06 (T/IRON)
 NORTH, 42.65', 10' MARK
 N77°E, 46.36', 5' MARK

NOTE:
 RESERVE TWO PARKING
 SPACES FOR HANDICAPPED
 PERSONS, 12' WIDE
 (SIGN BY OWNER)

NOTE:
 605.4 - EXISTING GROUND ELEVATION
 605.4 - TOP OF GRAVEL ON PARKING LOT

- NOTES:
1. CLEARING OF TREES SHALL BE STRICTLY LIMITED TO THOSE AREAS ON WHICH PARKING SURFACE ARE TO BE CONSTRUCTED.
 2. WORK AROUND TREES TO BE SAVED SHALL BE CONDUCTED SO AS TO CAUSE AS LITTLE DISTURBANCE TO TREES AS POSSIBLE.
 3. CONTRACTOR SHALL REMOVE & SALVAGE ALL PLAYGROUND EQUIPMENT, FLAG POLE & GUARD RAIL POST THAT FALL WITHIN CONSTRUCTION LIMITS. THIS SHALL BE CONSIDERED INCIDENTAL TO THIS PROJECT.
 4. PLACE 3" OF TOPSOIL, THEN SEED, FERTILIZE & MULCH ALL DISTURBED AREAS, AND AREAS OF EXPOSED CUT & FILL.

TH #2 24 11 3/4 10+32

0'-0.5'	TOPSOIL
0.5'-1'	YELLOW SAND WITH SMALL STONES
1'-3'	SILT
3'-5'	LEARN YELLOW SAND WITH SMALL STONES
5'	WATER

TH #3 50 20+00 50+00

0'-0.5'	TOPSOIL
0.5'-1.5'	SAND WITH SMALL STONES

PROFILE
 SCALE: VERT. 1" = 5'
 HORIZ. 1" = 30'

SECTION E-E

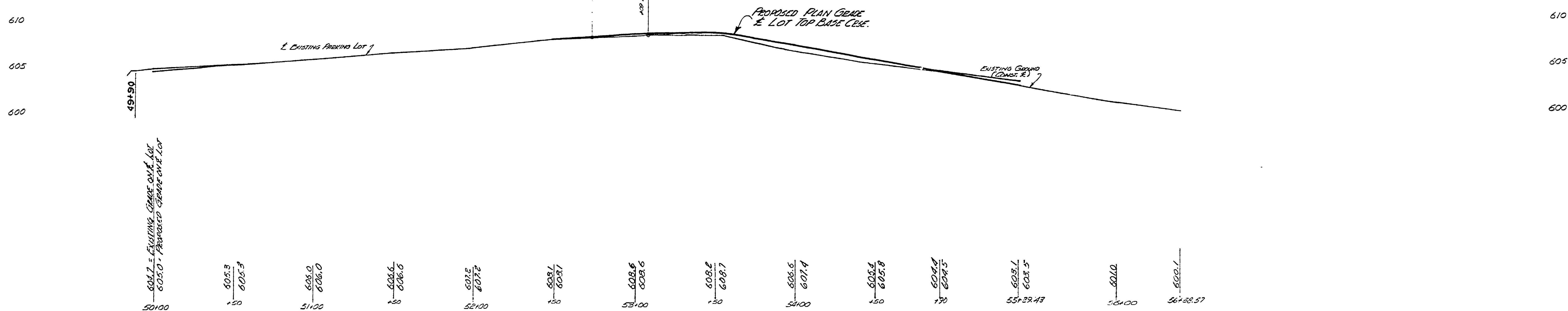

SURVEYED BY E. POON	10-74	DRAWN BY J. LEMMON	10-74	NO.	DATE	BY	REVISIONS	NO.	DATE	BY	REVISIONS	MICHIGAN DEPARTMENT OF NATURAL RESOURCES	EXPANSION OF DAY-USE PARKING AREA - PLAN & PROFILE	SHEET NO. 2 OF 3	ALOMA STATE PARK
DESIGNED BY A. PETRANICHUS	10-74	CHECKED BY	DATE	1.				3.					FOR PROJECT NO. 64-1542 EXPANSION OF DAY-USE PARKING AREA & IMPROVEMENT	SHEET 2 OF 3	PLAN NO. E-115