

DRAWN BY W. J. K. W.K.P.	CHECKED BY W. V. K.	REVIEWED BY SECTIONS ARCHITECTURAL ENGINEERING LANDSCAPE	DATE 6/2/58	APPROVED BY [Signature]	ASSISTANT CHIEF IN CHARGE DATE 6/2/58	NO. DATE BY	REVISIONS		
							1 10-14-53	2 10-19-50	3

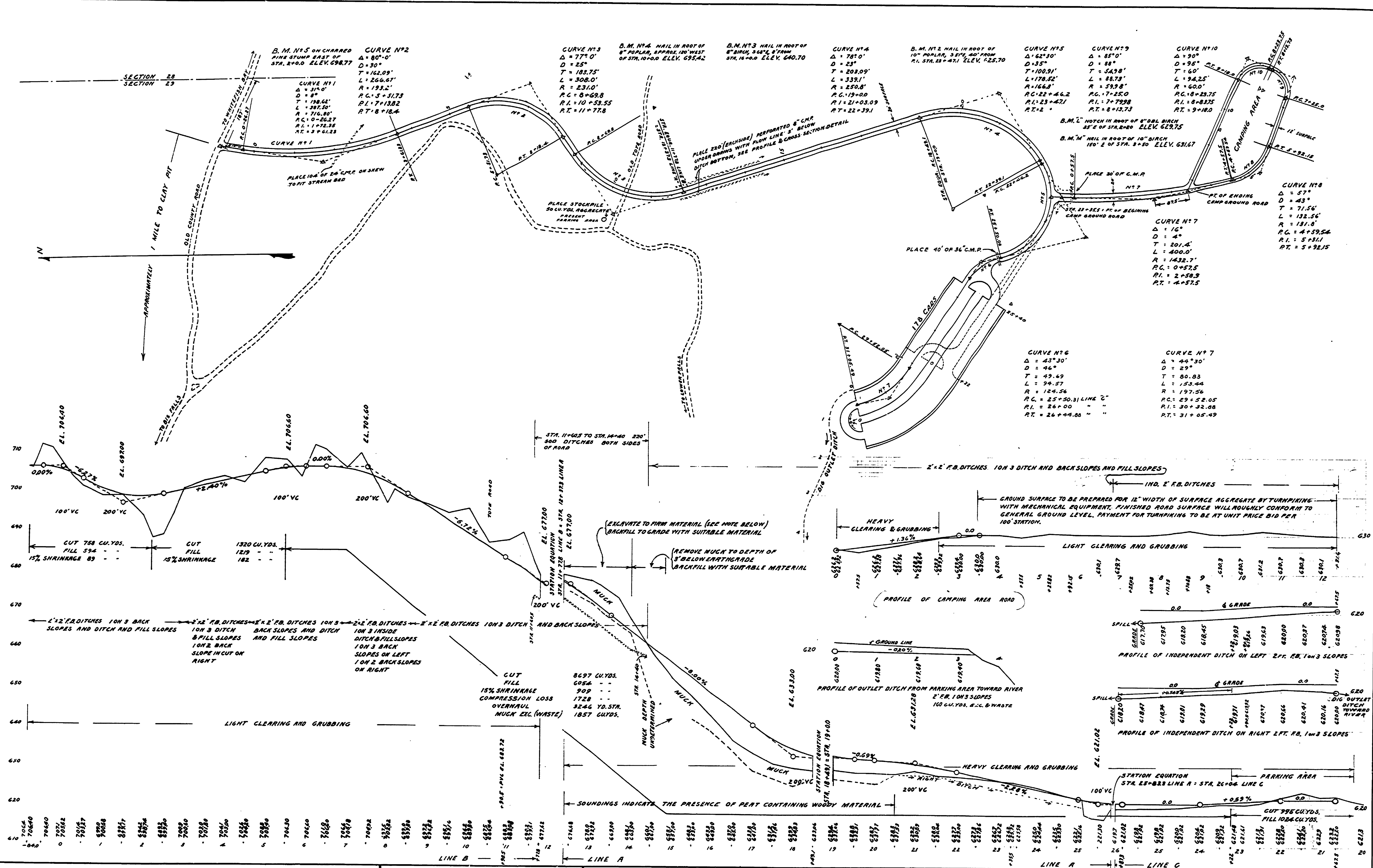

SCALE  
HORIZ. 1/4" = 100 FT. VERT. 1/4" = 10 FT.

PLAN AND PROFILE

MICHIGAN  
DEPARTMENT OF CONSERVATION  
PARKS AND RECREATION DIVISION

TAHQUAMENON FALLS STATE PARK  
LOWER FALLS ENTRANCE ROAD

SHEET NO. 3 OF 6  
PLAN NO. E-102

PROJ. NO. 121-053-26