

| DESIGNED BY | DATE | REVIEWED | DATE | APPROVED | DATE | NO. | DATE | BY | REVISIONS | DATE | BY | |
|-------------|--------|---|------|-------------|------|-----|------|----|-----------|------|----|--|
| D.K.V. | 7/6/02 | ARCHITECTURAL ENGINEERING LANDSCAPE | | [Signature] | | 1 | | | 1 | | | |
| | 7/6/02 | | | | 2 | | | 2 | | 2 | | |
| | | | | | 3 | | | 3 | | 3 | | |
| CHECKED BY | | | | | | | | | 4 | | | |
| | | | | | | | | | 5 | | | |
| | | | | | | | | | 6 | | | |

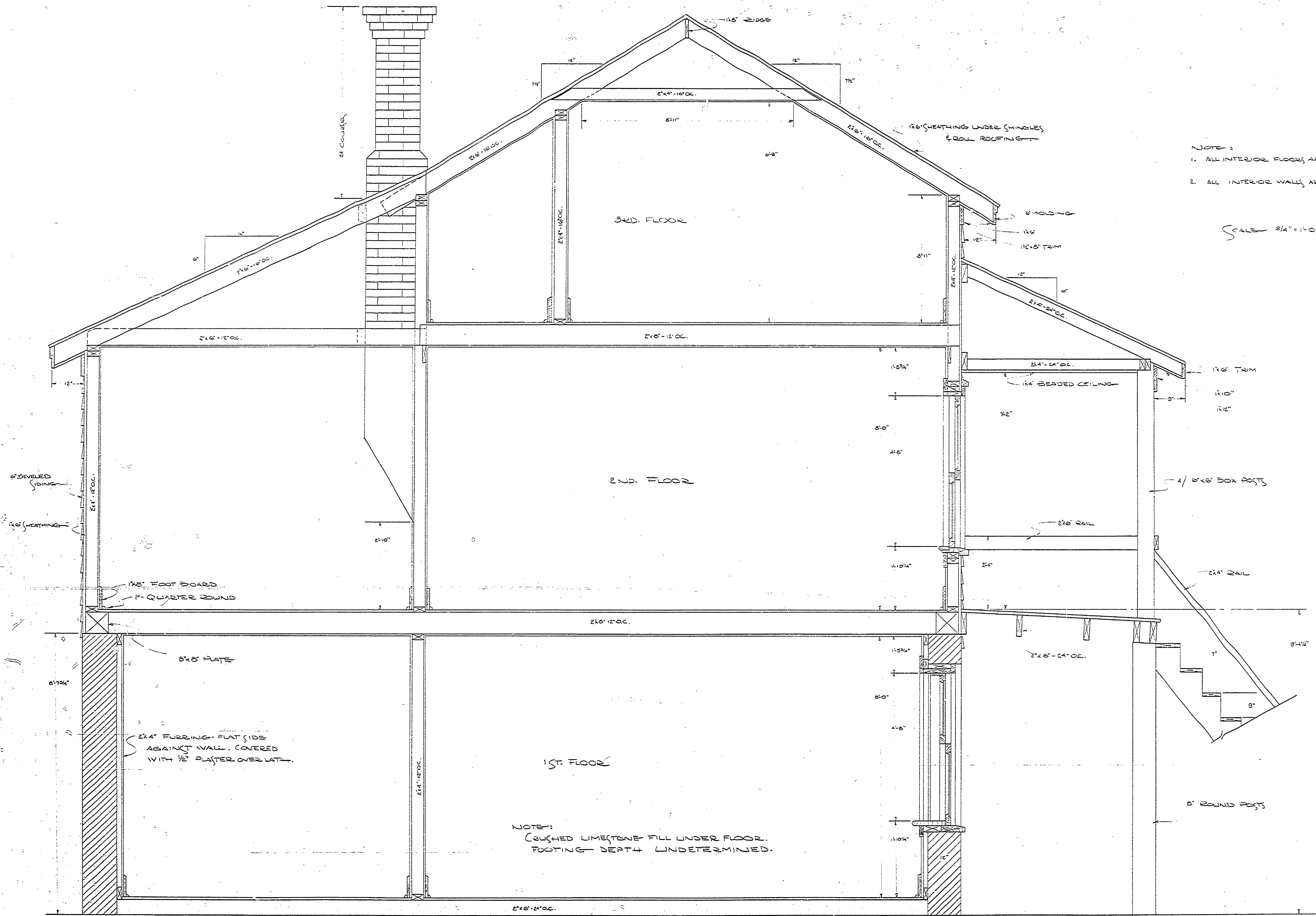

NOTE:
 1. ALL INTERIOR FLOORS ARE 1 1/2" T.E.G.
 2. ALL INTERIOR WALLS ARE 1/2" PLASTER OVER 1/2" LATH.

SCALE 3/4" = 1'-0"

NOTE:
 CRUSHED LIMESTONE FILL UNDER FLOOR.
 FOOTING DEPTH UNDETERMINED.

BUILDING # 2

MICHIGAN
 DEPARTMENT OF CONSERVATION
 PARKS AND RECREATION DIVISION

MEASURED DRAWING
 FAYETTE HISTORICAL TOWN SITE
 FAYETTE STATE PARK

SHEET
 NO. 3
 OF 3

PLAN NO.
 A-2