

DESIGNED BY	DATE	REVIEWED	DATE	APPROVED	DATE	NO.	DATE	BY	REVISIONS	DATE	BY
DRAWN BY		ARCHITECTURAL		CHEF OF PARKS		1			4		
CHECKED BY		ENGINEERING		ASST. CHIEF OF DIVISION		2			5		
		LANDSCAPE		CHEF OF PLANNING AND CONSTRUCTION		3			6		

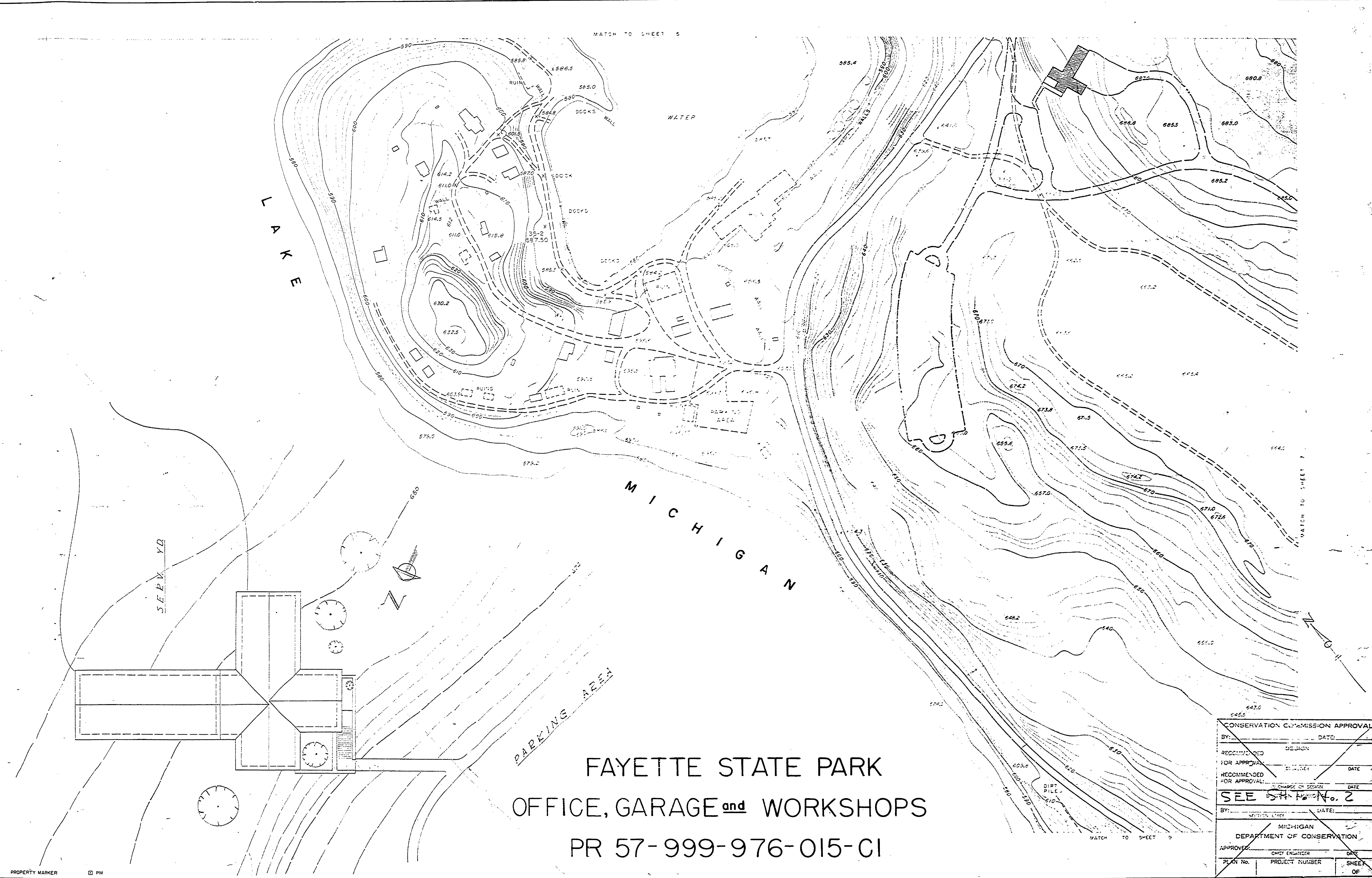

FAYETTE STATE PARK
 OFFICE, GARAGE and WORKSHOPS
 PR 57-999-976-015-C1

CONSERVATION COMMISSION APPROVAL	
BY: _____	DATE: _____
RECOMMENDED FOR APPROVAL: DESIGN	DATE: _____
RECOMMENDED FOR APPROVAL: ENGINEERING	DATE: _____
RECOMMENDED FOR APPROVAL: CHANGE ON DESIGN	DATE: _____
SEE SHEET No. 2	
BY: _____	DATE: _____
MICHIGAN DEPARTMENT OF CONSERVATION	
APPROVED: _____	DATE: _____
PLAN NO. _____	PROJECT NUMBER _____
SHEET OF _____	

PROPERTY MARKER PRIMARY ROADS SECONDARY ROADS RAILROADS	BUILDINGS PERENNIAL STREAMS INTERMITTENT STREAMS	BRIDGES CULVERT TRAVERSE STATION	VERTICAL CONTROL-MSL TREES TREES	ABRAMS AERIAL SURVEY CORPORATION LANSING, MICHIGAN	MICHIGAN DEPARTMENT OF CONSERVATION PARKS AND RECREATION SECTION	FAYETTE STATE PARK SCALE 1"=100' DATE OF PHOTOGRAPHY MAY 1963	SHEET NO. 1 OF 4	PLAN NO. A-201
--	--	--	--	---	---	---	------------------	----------------