

**SITE PLAN**

- LEGEND**
- EXISTING DECIDUOUS
  - EXISTING EVERGREEN
  - EXISTING BUILDING
  - PROPOSED BUILDING
  - EXISTING ROAD
  - PROPOSED ROAD
  - OBLITERATE ROAD

REVIEWED BY: Jim Hare 7-19-71  
IN CHARGE, PARK DESIGN DATE

APPROVED BY: Paul C. Christie 7-20-71  
CHIEF, PARKS DIVISION DATE

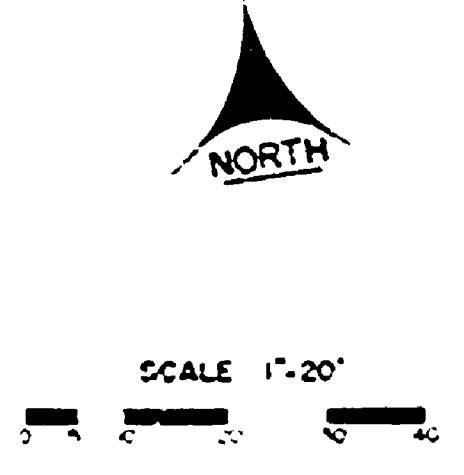
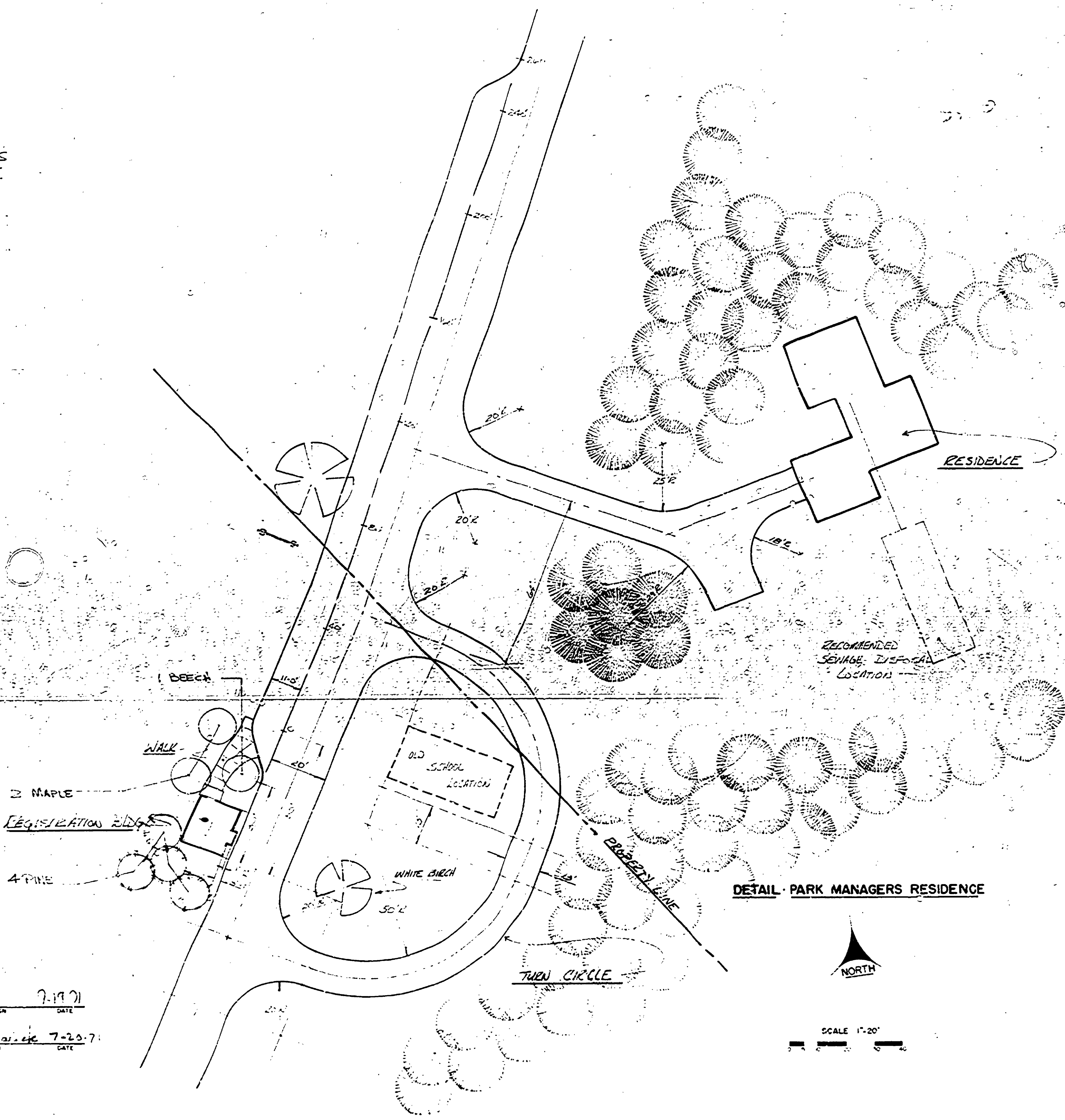

**DETAIL - PARK MANAGERS RESIDENCE**

SURVEYED BY	DRAWN BY R C WHITENER	6-10-71	NO. DATE BY	REVISIONS	NO. DATE BY	REVISIONS	MICHIGAN DEPARTMENT OF NATURAL RESOURCES	LOCATION-PARK MANAGERS RESIDENCE	AREA OR PARK FAYETTE STATE PARK	PROJECT NO.
DESIGNED BY	CHECKED BY L.C.M.		1. 6-10-71 R.C.W.	REDRAWN	3.			SHEET TITLE	PROJECT	SHEET 1 OF 1
	DATE	DATE	2. 7-20-71		4.					PLAN NO. L-107