

| | | | | | | | | | | | |
|-------------|---------|---------------|------|----------|------|-----|------|----|-----------|------|----|
| DESIGNED BY | DATE | REVIEWED | DATE | APPROVED | DATE | NO. | DATE | BY | REVISIONS | DATE | BY |
| BRE | 11-1-64 | ARCHITECTURAL | | | | 1 | | | 4 | | |
| CHECKED BY | | ENGINEERING | | | | 2 | | | 5 | | |
| | | LANDSCAPE | | | | 3 | | | 6 | | |

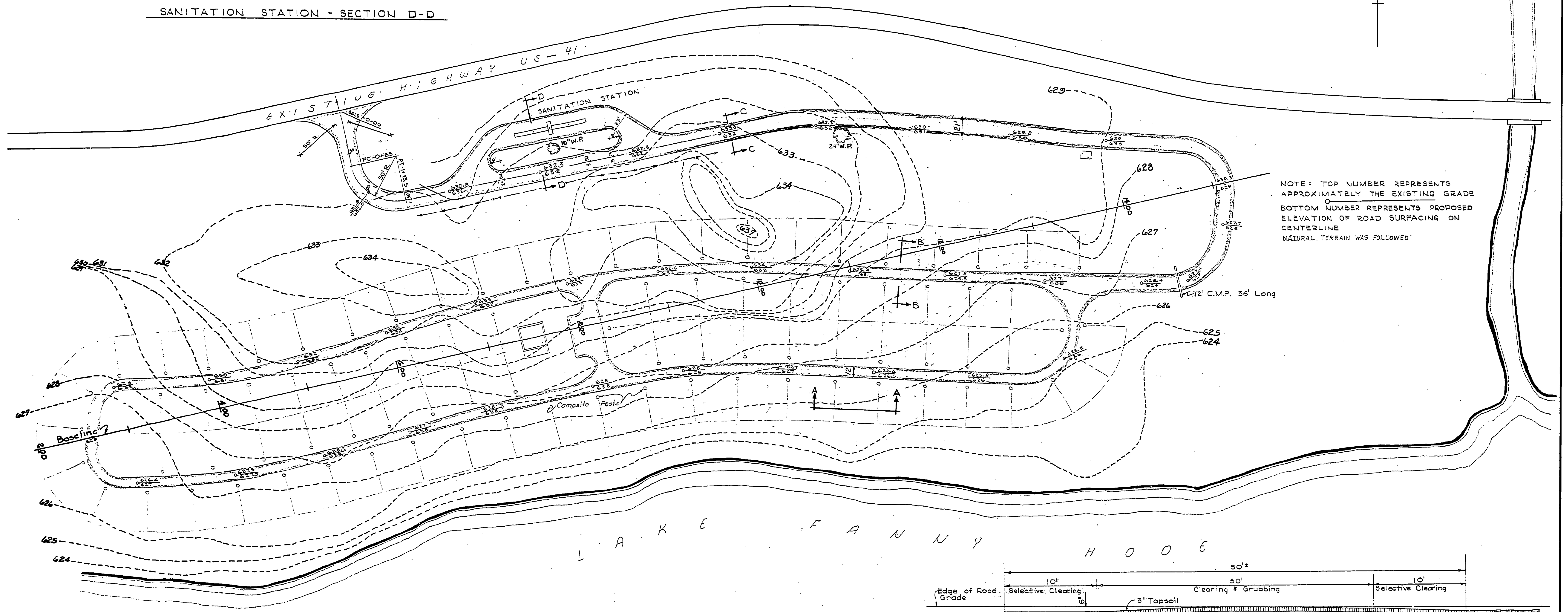

NOTE: TOP NUMBER REPRESENTS APPROXIMATELY THE EXISTING GRADE
 BOTTOM NUMBER REPRESENTS PROPOSED ELEVATION OF ROAD SURFACING ON CENTERLINE
 NATURAL TERRAIN WAS FOLLOWED

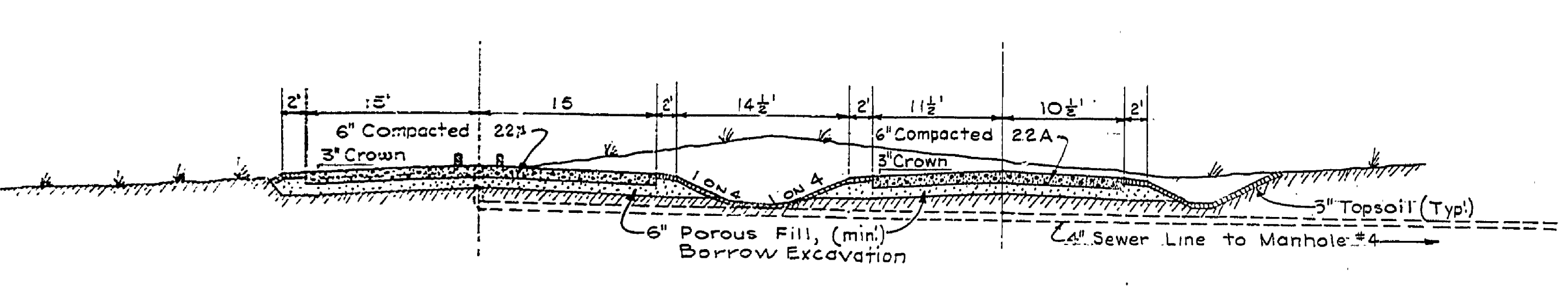
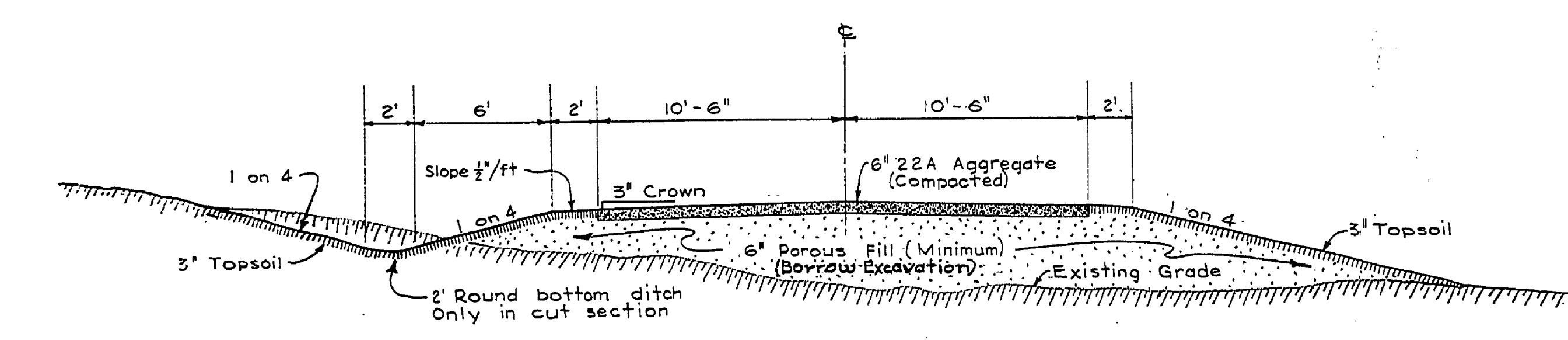

SECTION C-C
21' ROAD - TYPICAL

LAKE FANNY HOOE
 W.S. ELEV. 620.85 11-1-64
 SCALE 1"=50'

- QUANTITIES**
- 2300 CU. YDS. BORROW EXCAVATION (POROUS FILL FROM BORROW PIT FOR ROADS)
 - 3300 SQ. YDS. 22-A AGGREGATE, 5" DEEP, COMPACTED
 - 4000 SQ. YDS. 22-A AGGREGATE, 6" DEEP, COMPACTED
 - 2200 CU. YDS. TOPSOIL, (3" DEEP)
 - 200 CU. YDS. ROCK EXCAVATION
 - 6800 CU. YDS. EARTH EXCAVATION
 - 2.75 ACRES CLEARING & GRUBBING
 - 7.50 ACRES SELECTIVE CLEARING
 - 56.0 ACRES MULCH (2.5 TONS/ACRE)
 - 5.0 ACRES SEEDING (100 LBS./ACRE)

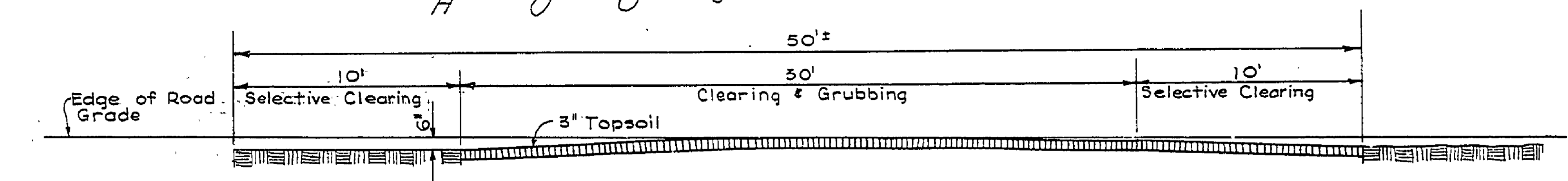

SECTION A-A
TYPICAL

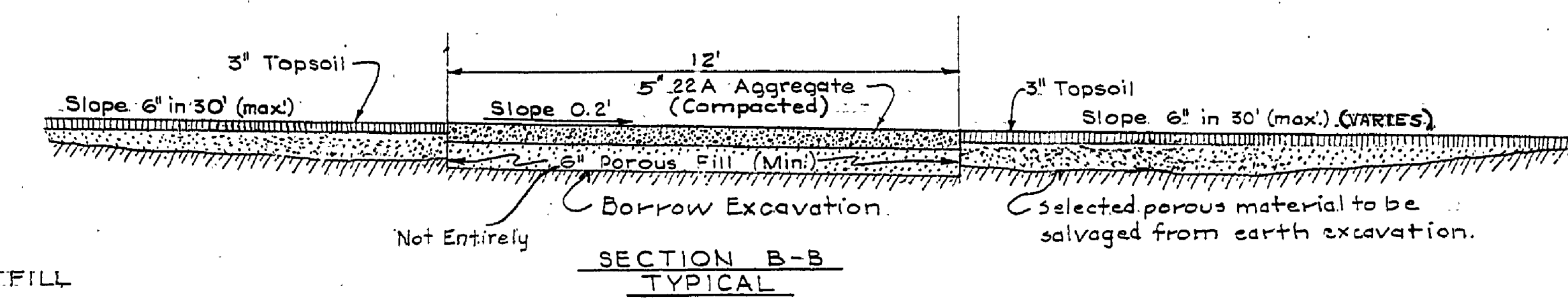

SECTION B-B
TYPICAL

Note: All waste material shall be placed on the north side of the sewage lagoon dike.

Scale 1"=50-0'

MICHIGAN DEPARTMENT OF CONSERVATION
PARKS AND RECREATION DIVISION

FORT WILKINS STATE PARK
WEST CAMPGROUND AREA

SHEET NO. 3 OF 3
PLAN NO. E-105A