

COPPER HARBOR

LAKE FANNY HOE

DESIGNED BY	DATE	REVIEWED	DATE	APPROVED	DATE NO.	DATE BY	REVISIONS
B.I.G.	Feb '64	ARCHITECTURAL	4-11-64		1	MJC DMC	ADDED SANITATION STATION
D.M.C.	Feb '64	ENGINEERING	4-11-64		2		
B.H.G.	Mar '64	LANDSCAPE	4-11-64		3		
					4		
					5		
					6		

MATCH POINT 'A'

MATCH POINT 'C'

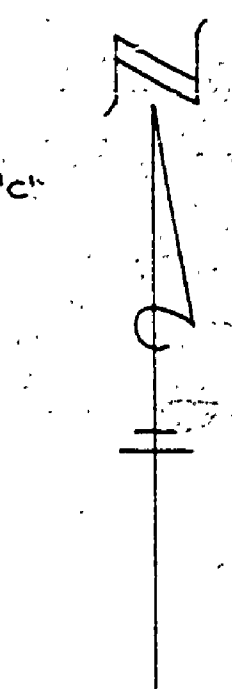

NOTE: Engineer to set grades so that water mains may be drained during months not in use. Bury 3" max; 6" min. Place thrust blocks at all changes of alignment of 10° or larger.

- LEGEND**
- 2" GP 2" Galvanized Pipe
 - W--- Future Water Line
 - S--- Sewer Line
 - Drinking Fountain
 - Gate Valve

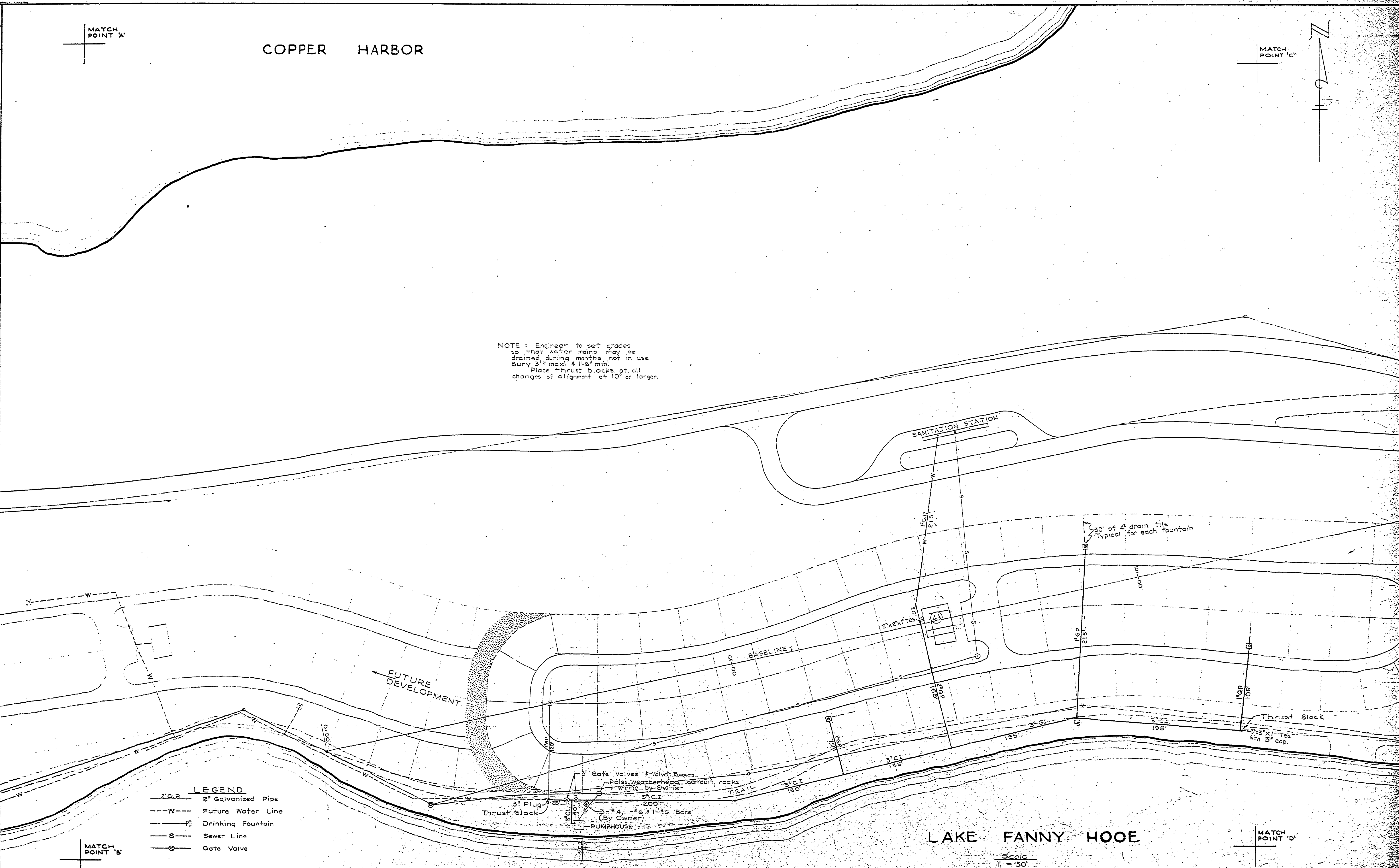

Scale
1" = 50'

MATCH POINT 'D'

MICHIGAN
DEPARTMENT OF CONSERVATION
PARKS AND RECREATION DIVISION

FORT WILKINS STATE PARK
WATER SYSTEM

SHEET NO. 3
OF 7

PLAN NO.
E-1062

976-006-4-C

SHEET 4 OF 16