

DESIGNED BY	DATE	REVIEWED	DATE	APPROVED	NO.	DATE	REVISIONS	DATE BY
B.H.G.	Feb. '64	ARCHITECTURAL	1-64		1	1/1/64	1	
D.M.C.	Feb. '64	ENGINEERING	1-64		2		2	
S.H.G.	Mar. '64	LANDSCAPE			3		3	
					4		4	
					5		5	
					6		6	

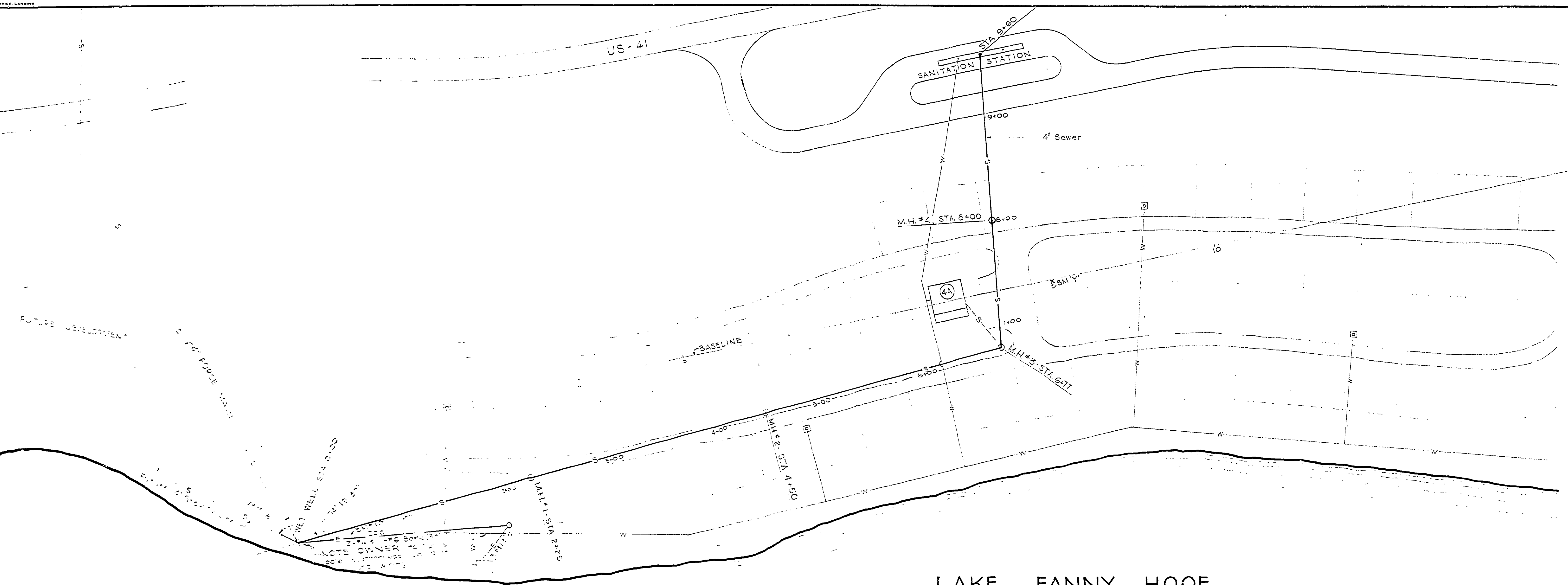

**BENCH MARK DATA**  
 B.M. #1 Elev. 631.16  
 P.K. spike & washer in N.W. root of  
 5" Poplar, 1.5' right from Baseline  
 Sta. 0+47.  
 B.M. #10 Elev. 625.55  
 Spike & washer in root of 10'  
 Birch, 5 ft right of Sta. 0+50

**PLAN**  
 1" = 50'

**PROFILE**  
 1" = 50' Horiz.  
 1" = 5' Vert.

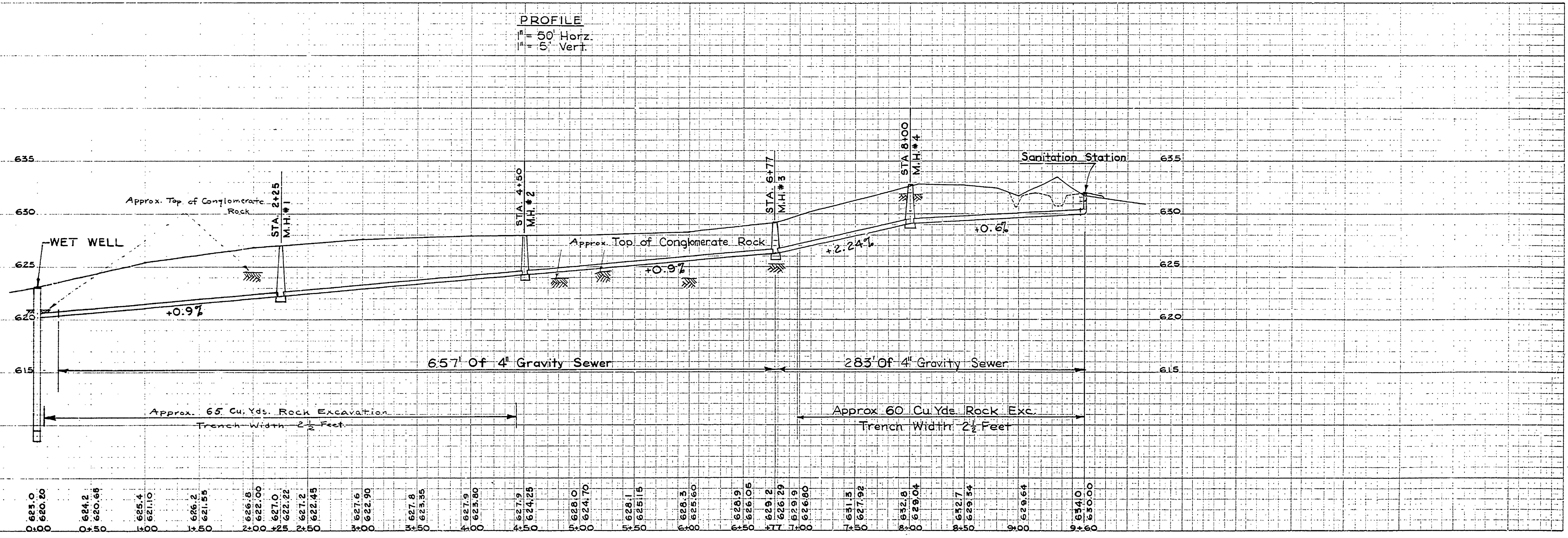

DESIGNED BY B.H.G.  
 DRAWN BY D.M.C.  
 CHECKED BY S.H.G.

MICHIGAN  
 DEPARTMENT OF CONSERVATION  
 PARKS AND RECREATION DIVISION

FORT WILKINS STATE PARK  
 CAMPGROUND SEWER SYSTEM

SHEET NO. 1 OF 6  
 PLAN NO. E-107