

DESIGNED BY	DATE	REVIEWED	DATE	APPROVED	DATE	NO.	DATE	BY	REVISIONS	DATE	BY
B.H.G.	Feb 64	ARCHITECTURAL	4-13-64			1	1/10/64	DMC	REVISED SEWAGE LAGOON		
D.M.C.	Feb 64	ENGINEERING	1-22-64			2					
B.H.G.	Mar 64	LANDSCAPE	4-24-64			3	4-11-64				
						4					
						5					
						6					

LAKE FANNY HOOE

B.M. #10 Elev. 625.35
Spike & washer in root of 10" Birch
5 ft. right of sta. 0+50. 4" Gravity Sewer.

B.M. #12 Elev. 615.87
Spike & washer in root of 14" Birch
4 ft. left of sta. 7+60

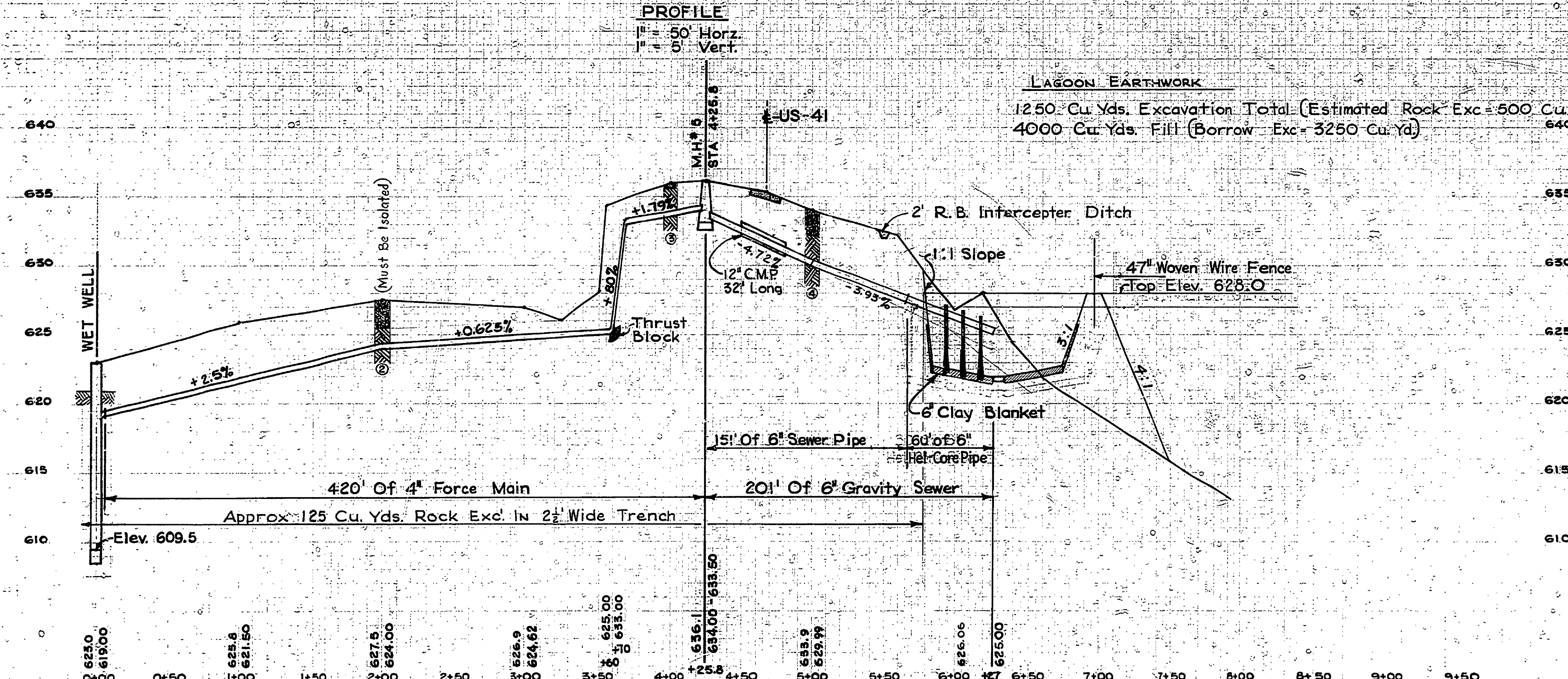
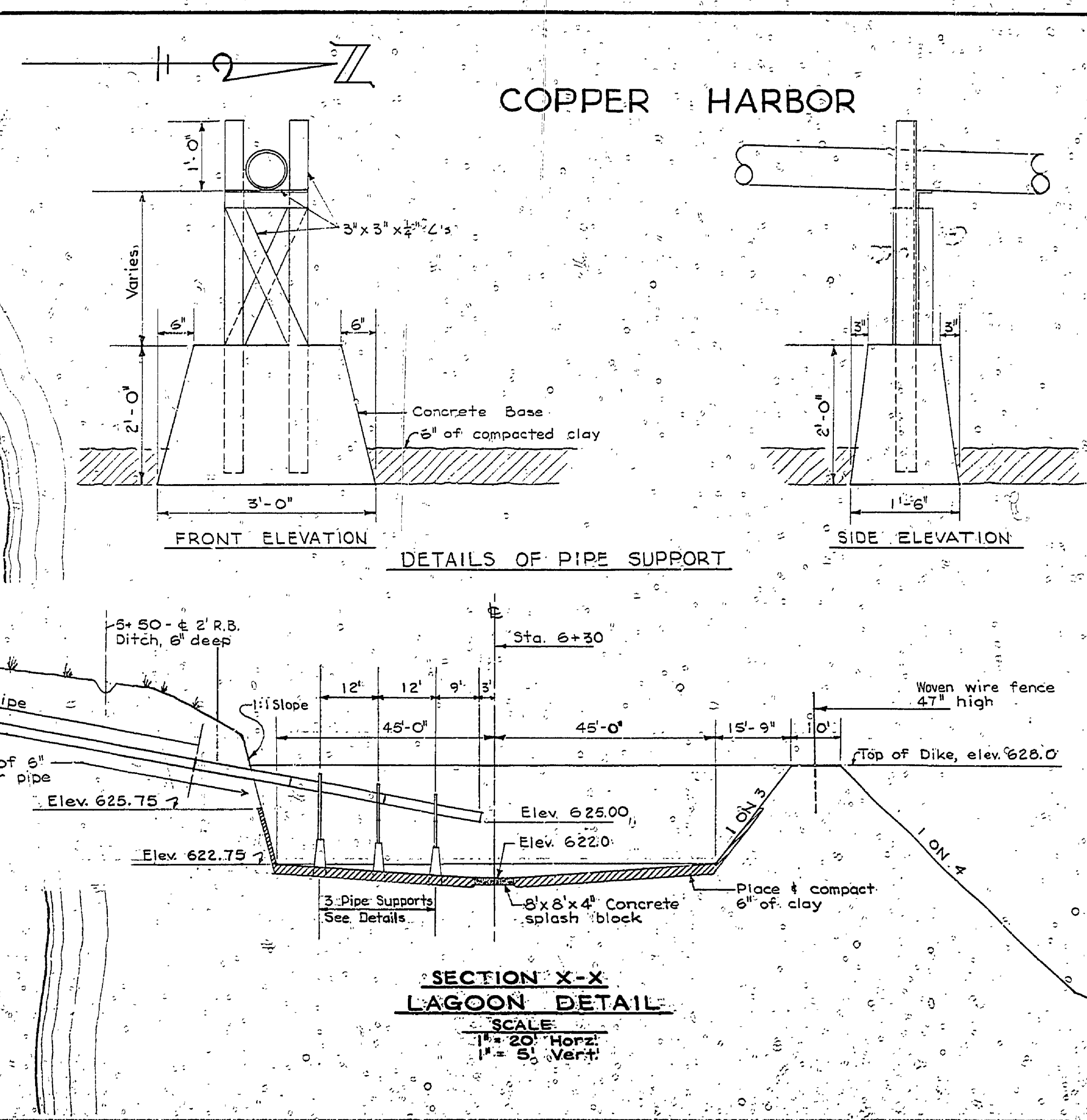
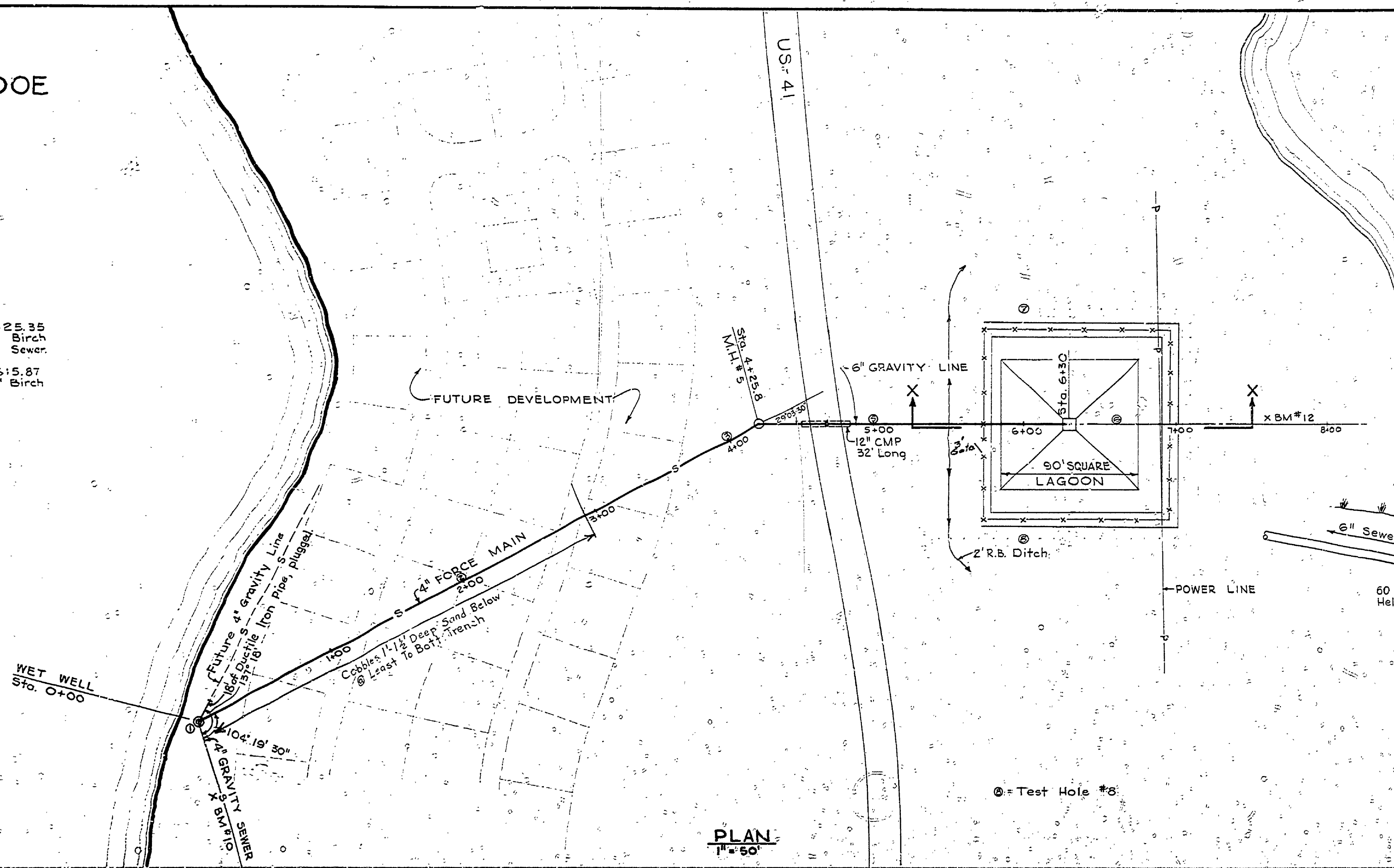

LAGOON EARTHWORK
1250 Cu. Yds. Excavation Total (Estimated Rock Exc. = 500 Cu. Yd.)
4000 Cu. Yds. Fill (Borrow Exc. = 3250 Cu. Yd.)

LEGEND
Cobbles, 2" to 4" Sand
Conglomerate Rock

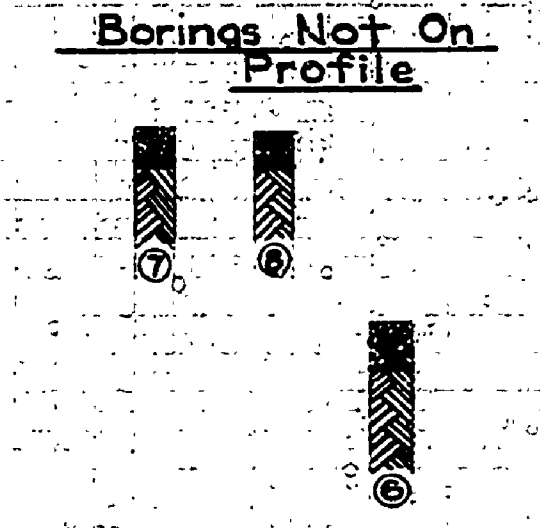

MICHIGAN DEPARTMENT OF CONSERVATION PARKS AND RECREATION DIVISION

FORT WILKINS STATE PARK CAMPGROUND SEWER SYSTEM

SHEET NO. 2 OF 6 PLAN NO. E-107