

Water level 578.71 - Oct. 1929  
581.50 - Aug. 1943

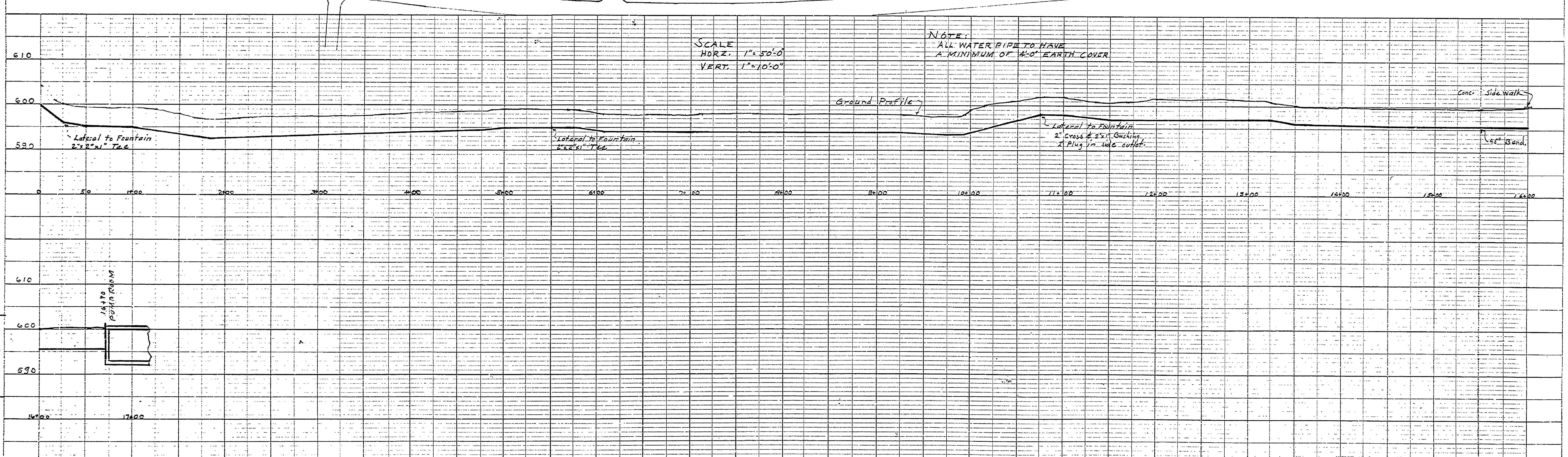
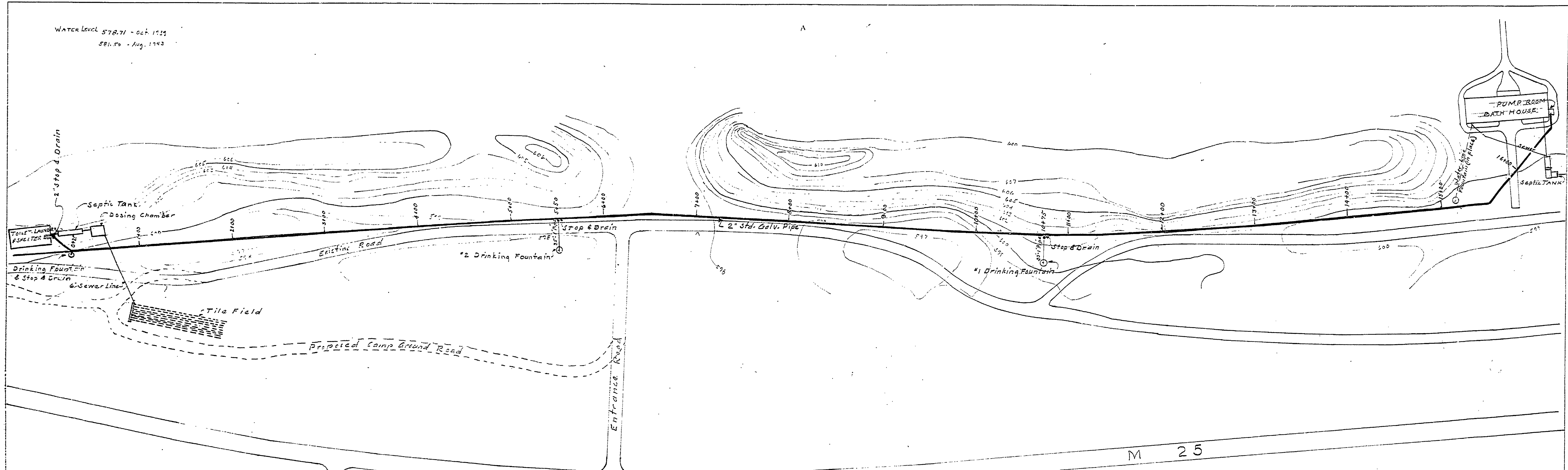

SCALE  
HORZ. 1"=50'-0"  
VERT. 1"=10'-0"

NOTE:  
ALL WATER PIPE TO HAVE  
A MINIMUM OF 4'-0" EARTH COVER

DATE 3-15-51  
APPROVED BY [Signature]  
ASST. CHIEF IN CHARGE OF DESIGN  
DRAWN BY E.J. AREVIEWED SECTION PROFILE  
CHECKED BY J.M. BARCH, J.T.R.  
DATE 3-18-51 ENGR. H.C.M.

PLATE 1-PLAN-PROFILE S. R. R. STANDARD  
1934 WAS PATENTED AND PRINTED IN U. S. A.  
EUGENE DICTZEN CO.

MICHIGAN DEPARTMENT OF CONSERVATION  
PARKS AND RECREATION DIVISION

SLEEPER STATE PARK  
LAKE SHORE CAMP GROUND  
WATER LINE EXTENSION

SHEET NO. 1 OF 2  
PLAN NO. E-108