

STATE, MICHIGAN  
 PROJECT NO. 24-1538  
 4-15-67/BCR SERVICE AREA AND RESOURCES  
 2-15-71 D.V. REUSE TRAILS  
 APPROVED BY: CHIEF, PARKS & RECREATION  
 REVIEWED BY: SEC. TREAS.  
 ENGINEER  
 DATE: AUGUST, 1964

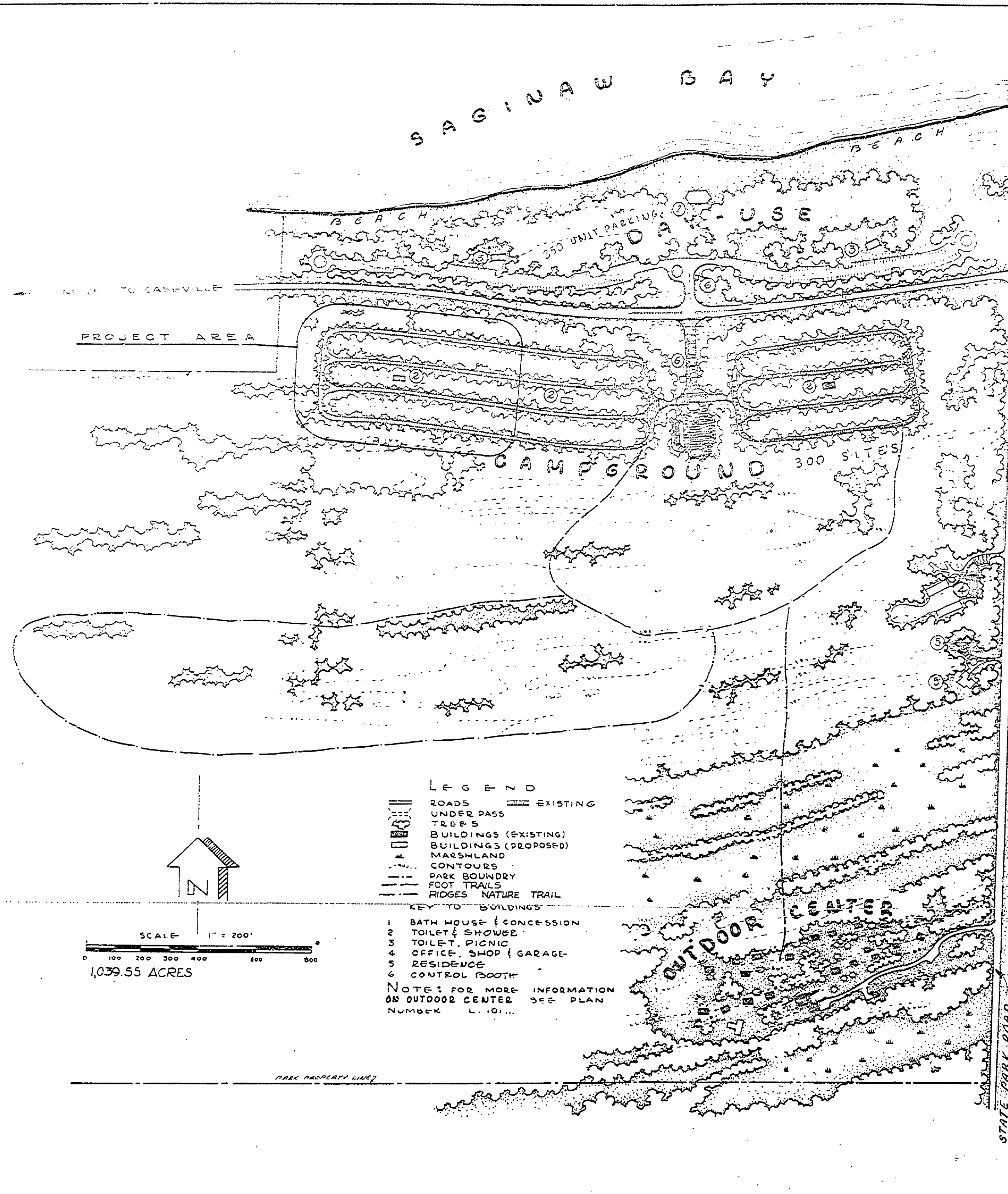

# SLEEPER STATE PARK CONSTRUCTION PLANS FOR UNDERGROUND ELECTRICAL DISTRIBUTION SYSTEM PROJECT NO. 24-1538

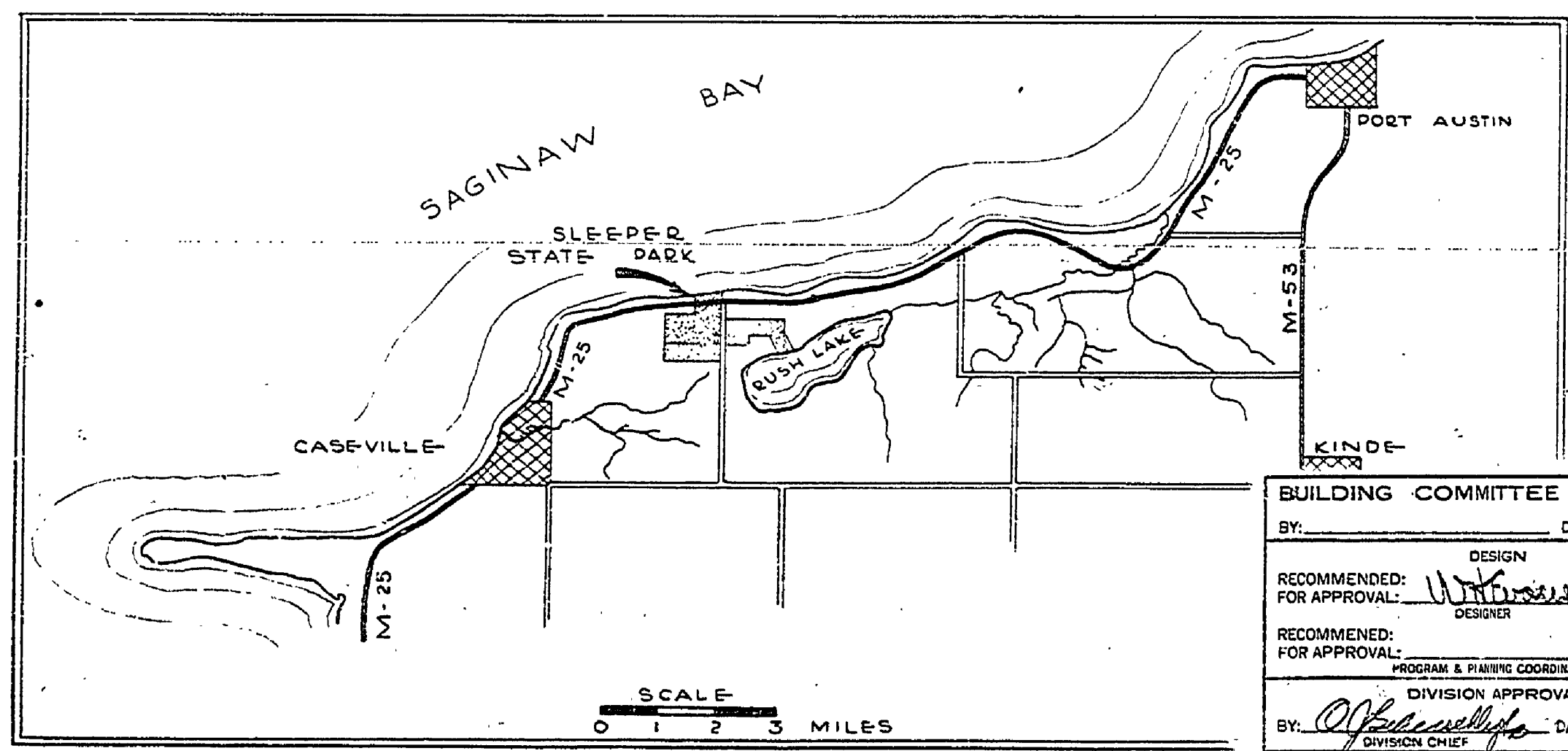
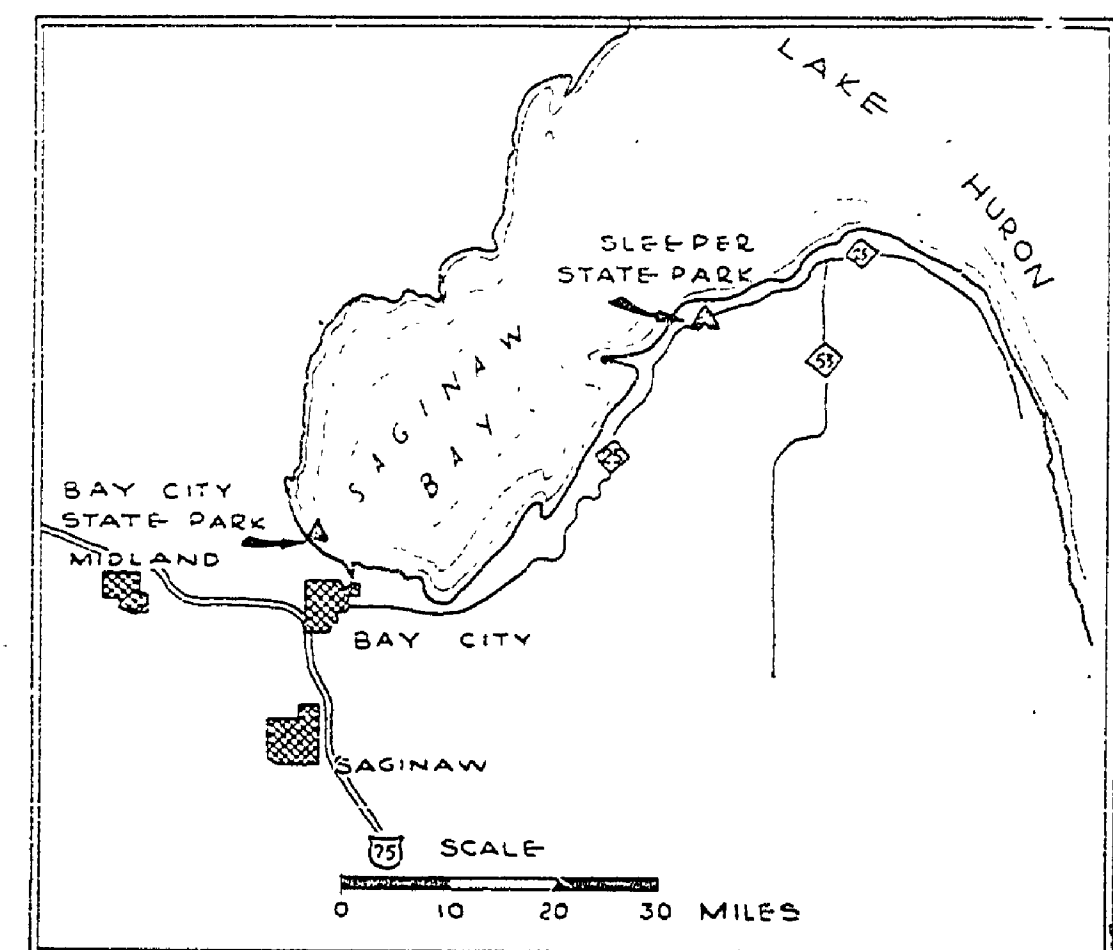

**BUILDING COMMITTEE APPROVAL**  
 BY: \_\_\_\_\_ DATE: \_\_\_\_\_  
 RECOMMENDED FOR APPROVAL: *W. H. ...* 1-3-74  
 DESIGNER  
 RECOMMENDED FOR APPROVAL: \_\_\_\_\_  
 PROGRAM & TRAINING COORDINATOR  
 DIVISION APPROVAL  
 BY: *O. ...* DATE: 7-10-74  
 DIVISION CHIEF  
 MICHIGAN DEPARTMENT OF NATURAL RESOURCES  
 APPROVED: *...* 7-10-74  
 CHIEF ENGINEER