

DESIGN SECTION A-A
VERTICAL & HORIZONTAL SCALE 1"=10'

GENERAL NOTES:

- ALL MEASUREMENTS REQUIRED FOR CONTRACT DRAWINGS CAN BE SCALED FROM THIS DRAWING.
- DESIGNATED BENCHES SHALL BE OF WOOD CONSTRUCTION ATTACHED TO WALL.
- THE WALK TO THE OVERLOOK SHALL BE AT A 5% SLOPE TO ALLOW ACCESS BY WHEELCHAIR.
- THE FACING OF THE CONCRETE RETAINING WALLS SHALL BE TEXTURED BY USING ROUGH SAWN 8" GROOVED PLYWOOD FORM LINERS.
- ALL DESIGN DETAIL SHALL BE COORDINATED BETWEEN ENGINEERING DIVISION AND PARKS DIVISION DESIGN STAFF.

LEGEND

- EXISTING VEGETATION
- EXISTING CONTOURS
- PROPOSED CONTOURS
- PROPOSED SPOT ELEVATIONS
- TOP OF WALL ELEVATION
- BASELINE STATIONS

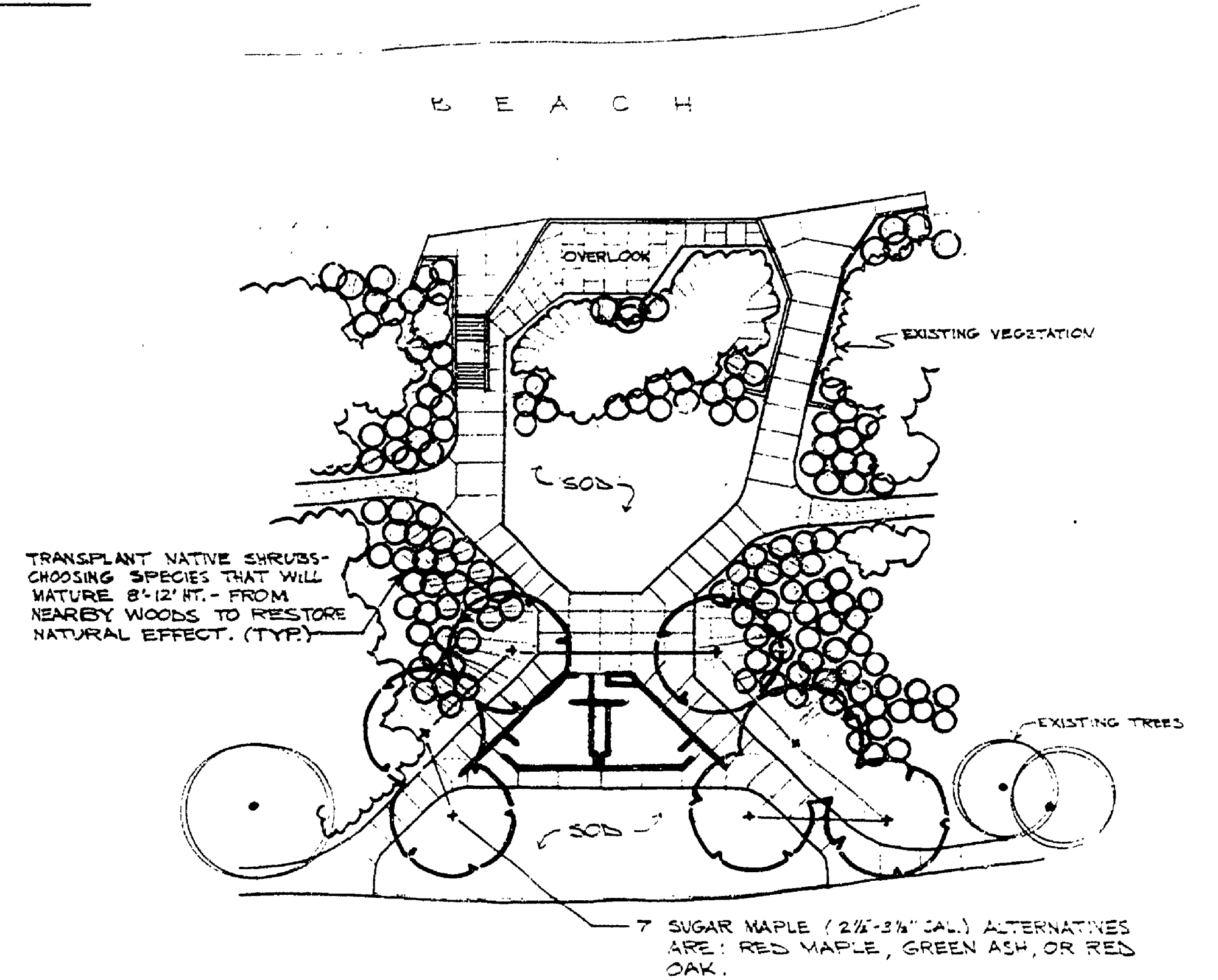

PLANTING PLAN
SCALE 1"=20'

REVIEWED BY: James M. Mone 3/23/76
IN CHARGE - PLANNING AND DESIGN DATE

APPROVED BY: Conrad G. Beckman, Jr. 4/12/76
Zoning CHIEF - PARKS DIVISION DATE

| | | | | | | | | | | |
|-------------------------|----------------------|---------|-------------------|---|-------------|-----------|--|-----------------------|---------------------------------|----------------|
| SUPERVISED BY | DRAWN BY O.L. MITTON | 2/15/76 | NO. DATE BY | REVISIONS | NO. DATE BY | REVISIONS | MICHIGAN DEPARTMENT OF NATURAL RESOURCES | SITE DEVELOPMENT PLAN | AREA OR PARK SLEEPER STATE PARK | PROJECT NO. |
| DESIGNED BY O.L. MITTON | CHECKED BY | 2/15/76 | 1. 6/15/76 O.L.M. | REMOVE STEPS AND UPPER RETAINING WALL AT OVERLOOK | 3. | | | SHEET TITLE | PROJECT BEACH-HOUSE | SHEET 1 OF 2 |
| | | | 2. | | 4. | | | | | PLAN NO. L-115 |