

HIGGINS LAKE STATE PARK

CONSTRUCTION PLANS FOR CAMP GROUND AREA

TOILET, LAUNDRY, AND SHOWER BUILDING

PROJECT NO. 86-223-1

APPROVED BY 
CHIEF, PARKS & RECREATION DIV.

DRAWN BY		CHECKED BY		DATE		REVISIONS	
E. J. MATT		E. J. P.		APR. 31, 1957			
ARCHITECTURAL		ENGINEERING		LANDSCAPE			
REVIEWED BY SECTIONS		DATE		APPROVED BY		NO. DATE BY	
ARCHITECTURAL		1-6-57		H.C. Macdonald		1	
ENGINEERING		2-6-57		H.C. Macdonald		2	
LANDSCAPE		3-6-57		H.C. Macdonald		3	
				ASSISTANT CHIEF IN CHARGE		4	
				OF DESIGN		5	
				DATE		6	

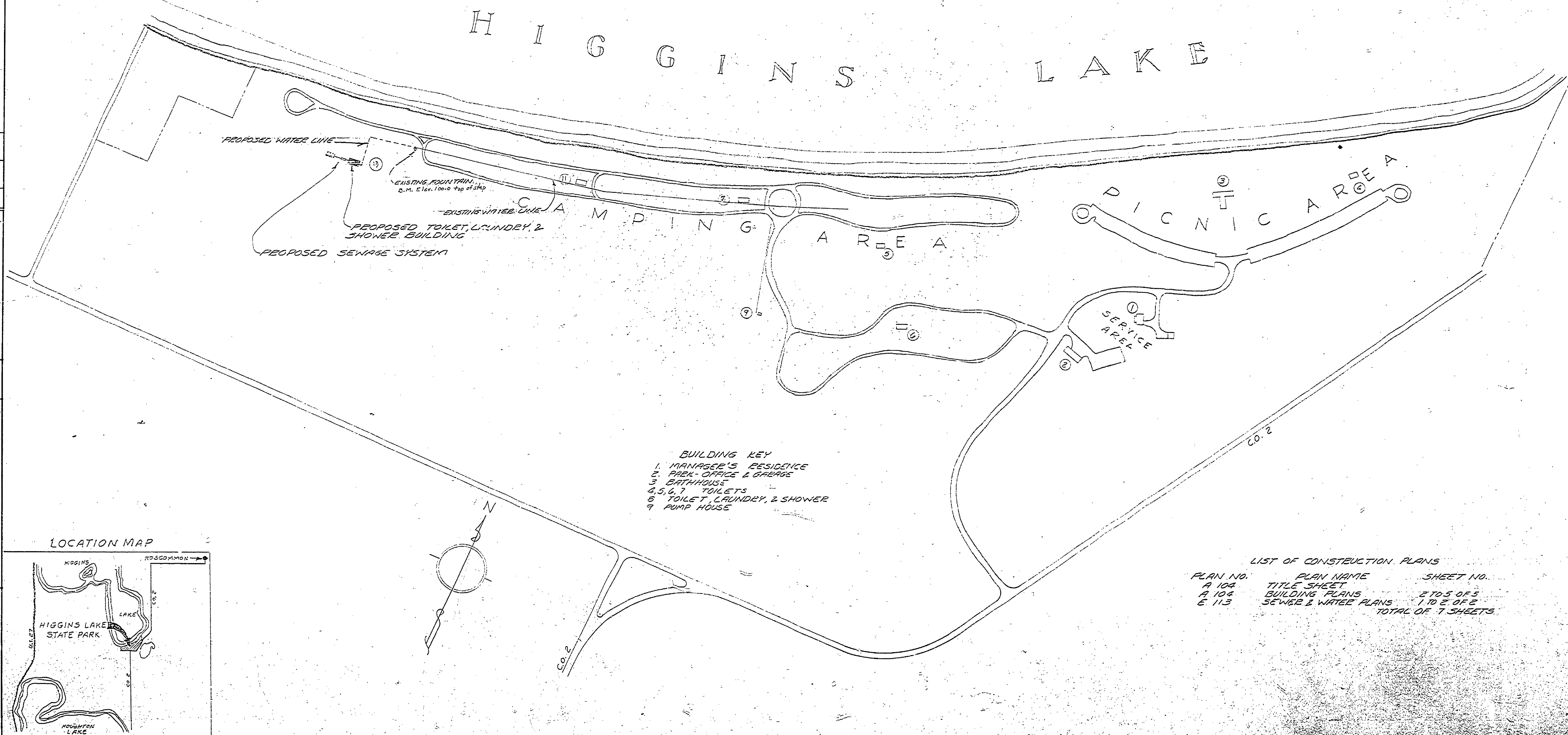

- BUILDING KEY**
1. MANAGER'S RESIDENCE
 2. PARK OFFICE & GARAGE
 3. BATHHOUSE
 - 4, 5, 6, 7. TOILETS
 8. TOILET, LAUNDRY, & SHOWER
 9. PUMP HOUSE

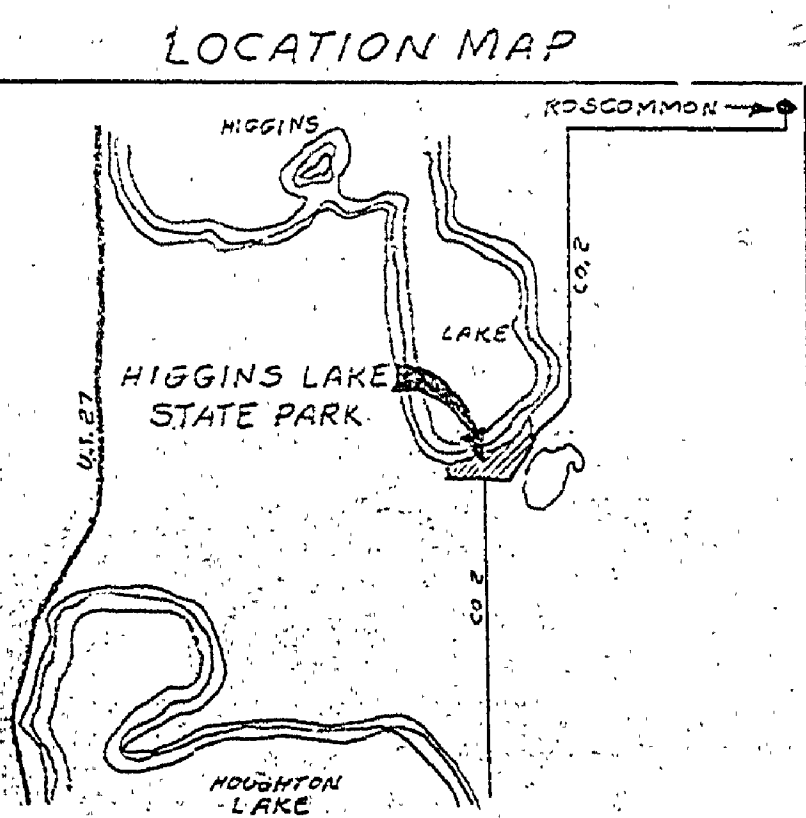

LIST OF CONSTRUCTION PLANS

PLAN NO.	PLAN NAME	SHEET NO.
A 104	TITLE SHEET	2 TO 5 OF 5
A 104	BUILDING PLANS	1 TO 2 OF 2
E 113	SEWER & WATER PLANS	TOTAL OF 7 SHEETS

SCALE 1" = 200'

MICHIGAN
DEPARTMENT OF CONSERVATION
PARKS AND RECREATION DIVISION

HIGGINS LAKE STATE PARK
TITLE SHEET

SHEET NO. 1 OF 5
PLANNING A104