

DESIGNED BY	DATE	REVIEWED	DATE	APPROVED	DATE	NO.	DATE	BY	REVISIONS
B.H.G.	Feb 63	M.M.C.	4-2-63	<i>[Signature]</i>	7-12-63	1	7-12-63	B.H.G.	Revised As Shaded
B.H.G. & D.M.C.	Feb 63	E.P.	4-1-63	<i>[Signature]</i>	10-1-63	2	10-1-63	J.Y.	Rev. As Constructed
			4-3-63		1-3-63	3			
						4			
						5			
						6			

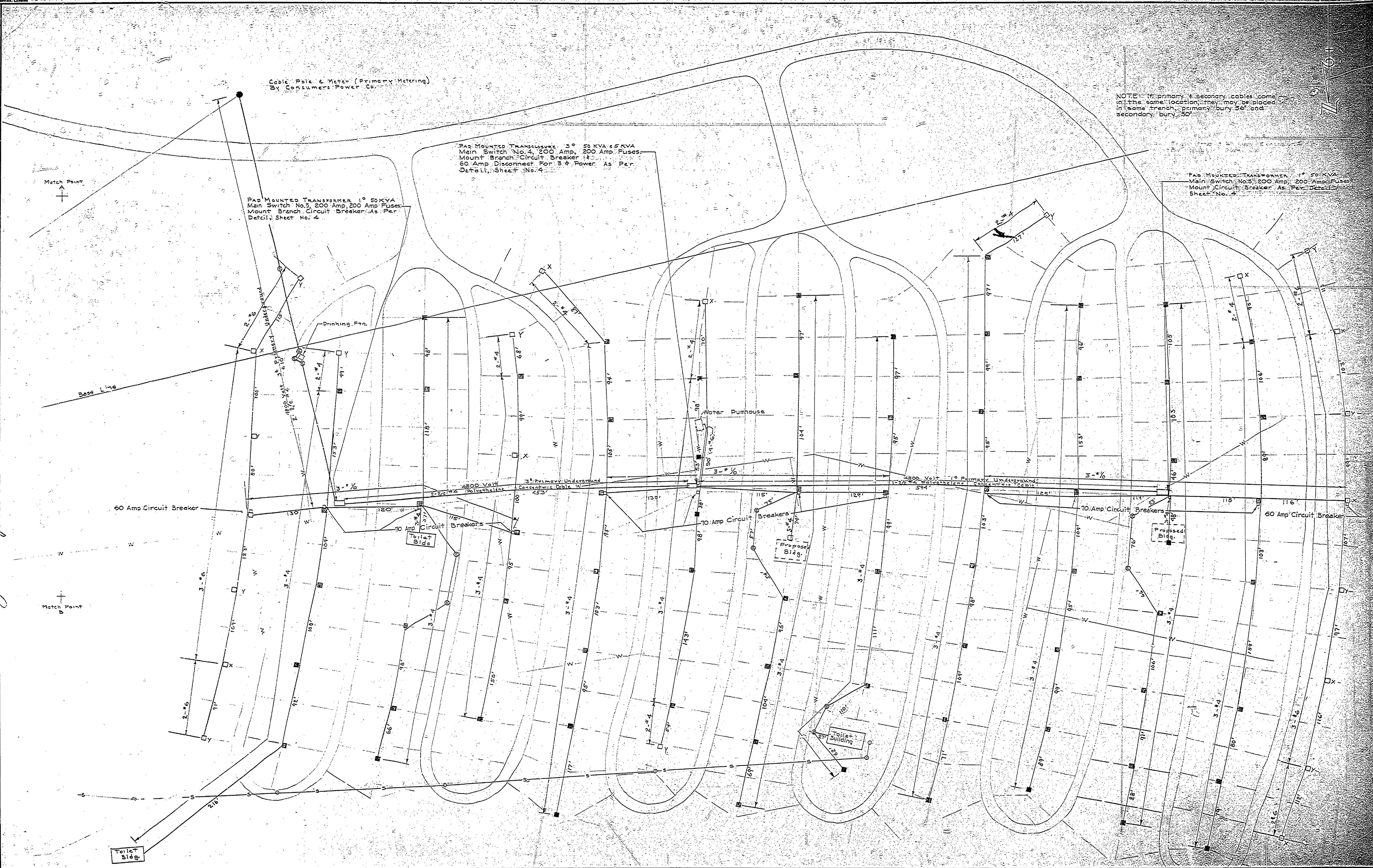

NOTE: If primary & secondary cables come in the same trench, primary bury 36" and secondary bury 50"

Pad Mounted Transformer 3rd 50 KVA & 5 KVA
Main Switch No. 4, 200 Amp, 200 Amp Fuses
Mount Branch Circuit Breaker As Per
60 Amp Disconnect For 5 & Power As Per
Detail Sheet No. 4

Pad Mounted Transformer 50 KVA
Main Switch No. 3, 200 Amp, 200 Amp Fuses
Mount Branch Circuit Breaker As Per
Detail Sheet No. 4

Pad Mounted Transformer 50 KVA
Main Switch No. 5, 200 Amp, 200 Amp Fuses
Mount Branch Circuit Breaker As Per Detail
Sheet No. 4

MICHIGAN
DEPARTMENT OF CONSERVATION
PARKS AND RECREATION DIVISION

HIGGINS LAKE STATE PARK
ELECTRICAL DISTRIBUTION SYSTEM
SCALE 1" = 50'

SHEET
NO. 2
OF 5
PLAN NO.
E-116