

DESIGNED BY	DATE	REVIEWED	DATE	APPROVED	DATE	NO.	DATE	REVISIONS	DATE
BY R. A. B.	7-5-61	ARCHITECTURAL	7-5-61			1			
DRAWN BY F. J. W.	7-5-61	ENGINEERING	7-5-61			2			
CHECKED BY	7-5-61	LANDSCAPE	7-5-61			3			

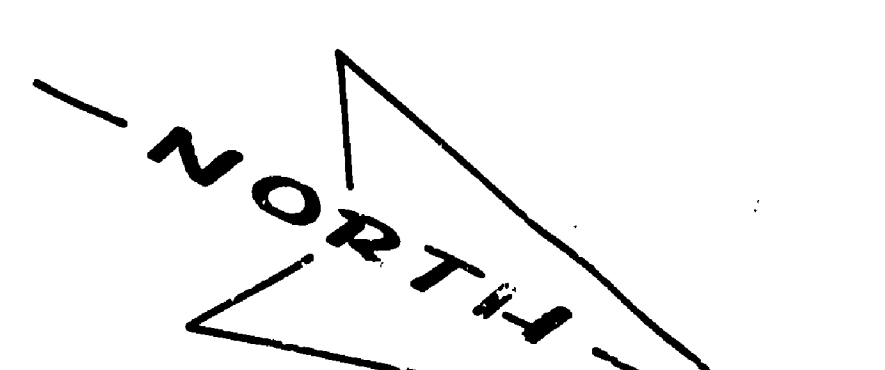

SCALE 1" = 50'

BENCH MARKS:
 B.M. "A" TAG ROOT WEST SIDE OF 15" OAK, 40' NORTH 04' E OF SERVICE DRIVE, 24' EAST OF E OF PICNIC AREA ENTRANCE ROAD. ELEVATION 1153.88.
 B.M. "B" TAG ROOT NORTHWEST SIDE OF 8" OAK, 13' SOUTHEAST OF INTERSECTION OF PARK ENTRANCE ROAD & NEW CAMPGROUND ENTRANCE ROAD. ELEVATION 1178.97.

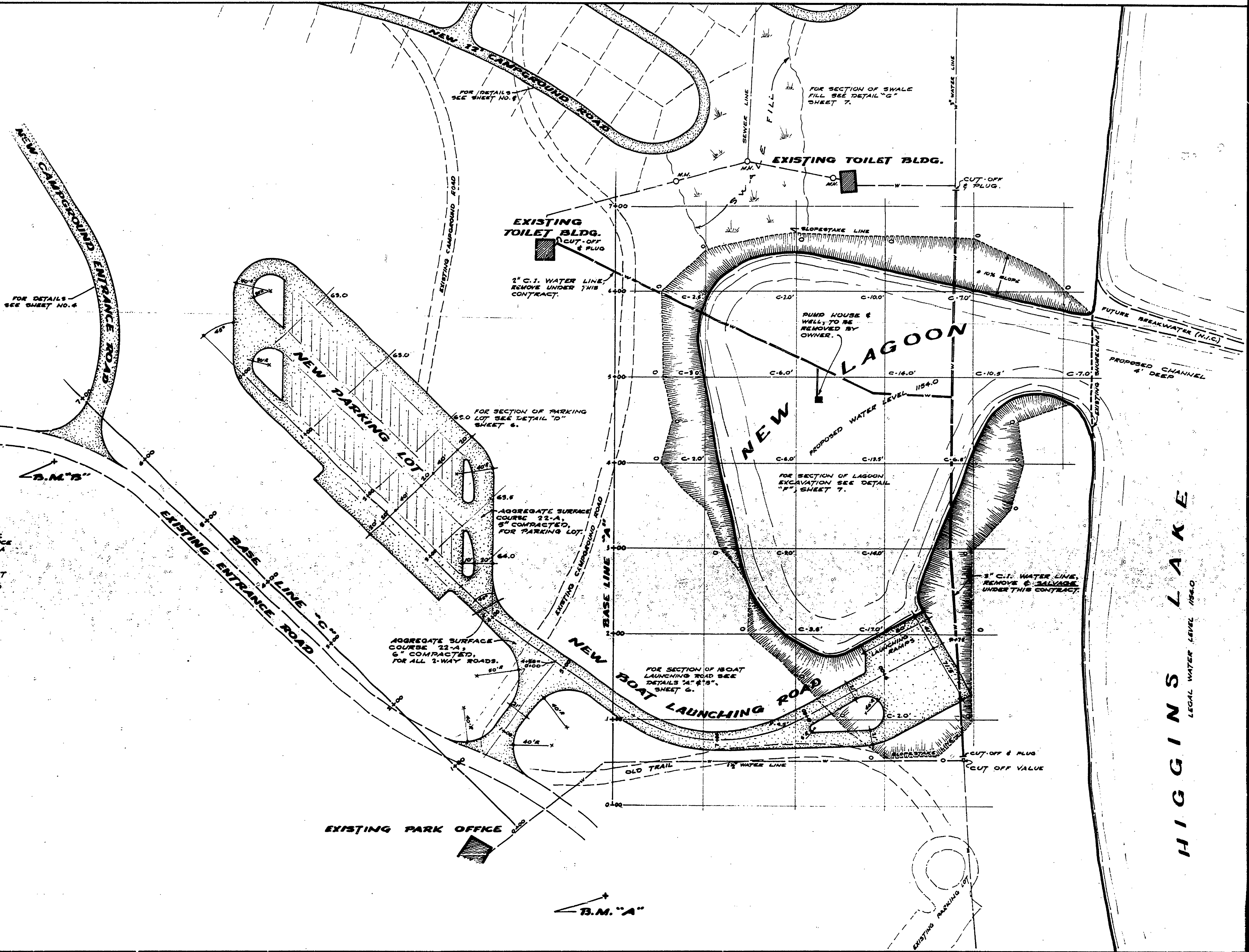

HIGGINS LAKE
 LEGAL WATER LEVEL 1154.0

MICHIGAN DEPARTMENT OF CONSERVATION PARKS AND RECREATION DIVISION	HIGGINS LAKE STATE PARK LAGOON EXCAVATION	SHEET NO. 2 OF 7	PLAN NO. L-107
-------------------------------------------------------------------	-------------------------------------------	------------------	----------------