

# SOUTH HIGGINS LAKE STATE PARK

## CONSTRUCTION PLANS FOR PARKING LOT ADDITION AND BLACKTOPPING

PROJECT NO. PA 999-9972-976-025-C4

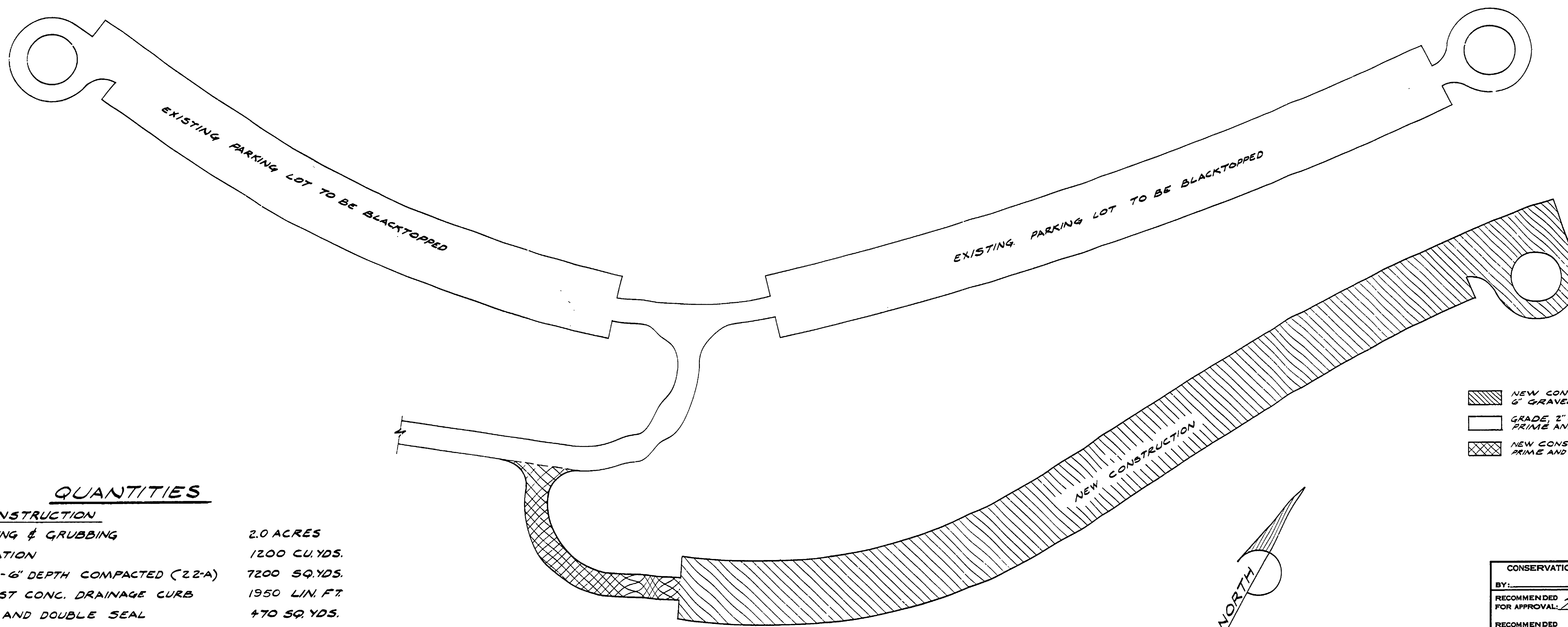

### QUANTITIES

<u>NEW CONSTRUCTION</u>	
CLEARING & GRUBBING	2.0 ACRES
EXCAVATION	1200 CU.YDS.
GRAVEL-6' DEPTH COMPACTED (22-A)	7200 SQ.YDS.
PRECAST CONC. DRAINAGE CURB	1950 LIN. FT.
PRIME AND DOUBLE SEAL	470 SQ.YDS.
<u>BLACKTOPPING EXISTING LOTS</u>	
AGGREGATE DRESSING COURSE (2' COMP 22-A)	8500 SQ.YDS.
PRIME AND DOUBLE SEAL	8500 SQ.YDS.

SCALE: 1"=50'

- NEW CONSTRUCTION 6' GRAVELED SURFACED
- GRADE 2' GRAVEL DRESSING, PRIME AND DOUBLE SEAL
- NEW CONSTRUCTION 6' GRAVEL PRIME AND DOUBLE SEAL

CONSERVATION COMMISSION APPROVAL	
BY: _____	DATE: _____
RECOMMENDED FOR APPROVAL: <i>R. E. ...</i>	DATE: 4/2/09
RECOMMENDED FOR APPROVAL: <i>R. P. ...</i>	DATE: 4-14-09
SECTION APPROVAL	
BY: <i>R. O. Dodge</i>	DATE: 4-22-09
ENGINEERING SECTION	
APPROVED: <i>H. C. ...</i>	DATE: 4-23-09

DESIGNED BY: W. POYET	DRAWN BY: P.J. STEFANICK	NO. DATE BY	REVISIONS	NO. DATE BY	REVISIONS
DATE: _____	CHECKED BY: _____	1. _____	_____	3. _____	_____
		2. _____	_____	4. _____	_____

MICHIGAN  
DEPARTMENT OF CONSERVATION

COVER SHEET

SHEET NO. \_\_\_\_\_ OF \_\_\_\_\_  
FOR PROJECT NO. PA999-9972-976-025-C4

SOUTH HIGGINS LAKE STATE PARK  
PARKING LOT ADDITION

SHEET 1 OF 2 PLAN NO. E-124