

SOUTH HIGGINS LAKE STATE PARK

CONSTRUCTION PLANS FOR BITUMINOUS SURFACING, EAST PARKING LOT

PROJECT NO. 0151

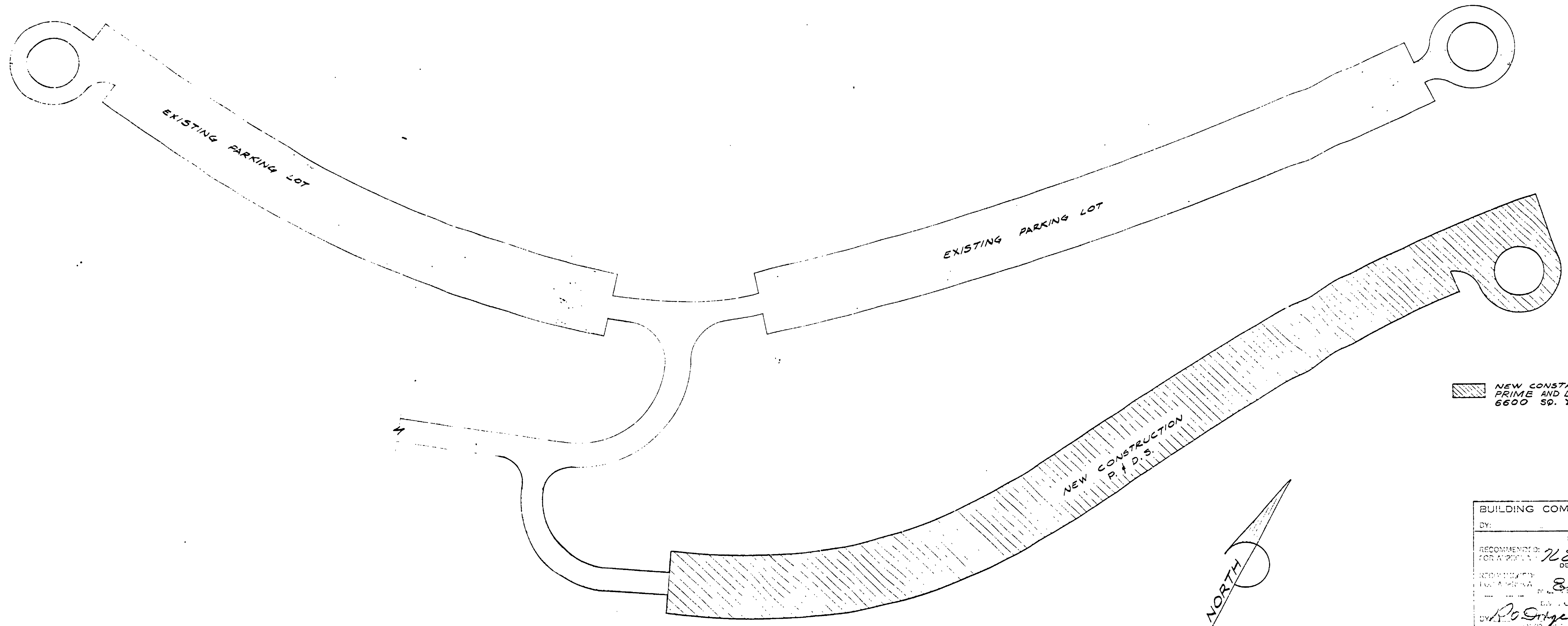

**NEW CONSTRUCTION
PRIME AND DOUBLE SEAL
6600 SQ. YDS.**

SCALE: 1"=80'

BUILDING COMMITTEE APPROVAL	
BY: _____	DATE: _____
DESIGN	
RECOMMENDED FOR APPROVAL BY: <i>W.E. Bahr</i>	DATE: 11-21-69
DESIGNER: _____	
APPROVED BY: <i>R. Merrill</i>	DATE: 11-24-69
DATE: _____	
BY: <i>R.O. Gage</i>	DATE: 11-25-69
DATE: _____	
MICHIGAN DEPARTMENT OF NATURAL RESOURCES	
APPROVED BY: <i>H.C. Anderson</i>	DATE: 11-28-69
DATE: _____	
PLAN NO. _____	SHEET OF _____

SURVEYED BY	DRAWN BY	NO.	DATE	BY	REVISIONS	NO.	DATE	BY	REVISIONS
DESIGNED BY <i>R.H. MERRILL</i>	<i>J. YPMA</i>	1.	Nov. 69			3.			
DATE	CHECKED BY	2.	DATE			4.			

MICHIGAN DEPARTMENT OF CONSERVATION

COVER SHEET

SHEET NO. _____ OF _____
FOR PROJECT NO. 0151

SOUTH HIGGINS LAKE STATE PARK
PARKING LOT SURFACING
SHEET 1 OF 2 PLAN NO. E-125