

BRUNING 8446

BM-B ELEV. 103.31
P.K. NAIL & BRASS WASHER IN SOUTH
SIDE OF 10" OAK

COUNTY ROAD 200

WEST BASELINE N. 89° 15' W.

EAST BASELINE S. 89° 30' E.

S.O.B.
374.0100

Sta. 0+00 of Entrance Road.
See sheet # 11 for details.

ENTRANCE ROAD

6' Path w/ woodchips 6" deep
(By Owner)

Original Grade
Finish Grade

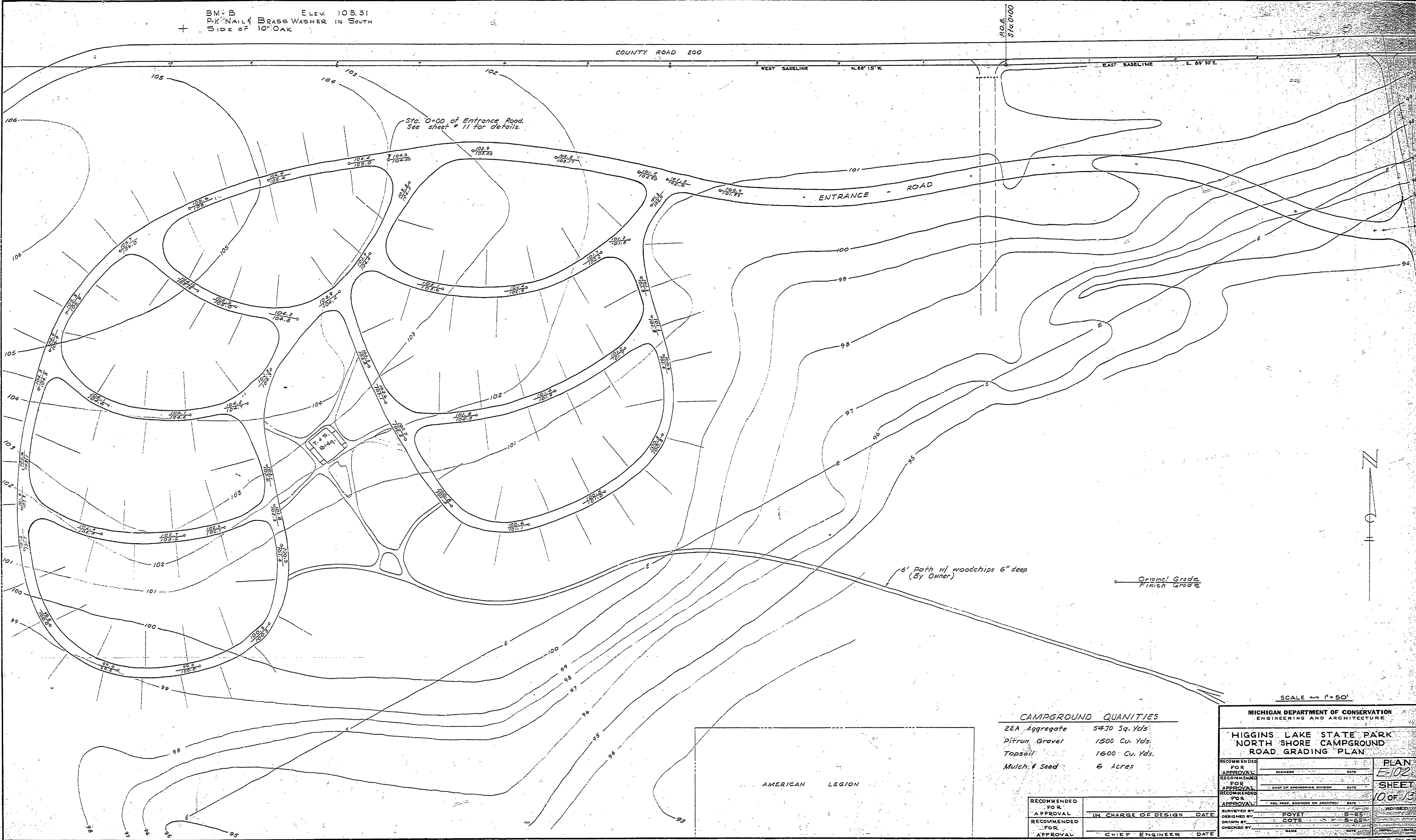

SCALE 1" = 50'

CAMPGROUND QUANTITIES

22A Aggregate	5470 Sq. Yds.
Drum Gravel	1500 Cu. Yds.
Topsoil	1600 Cu. Yds.
Mulch & Seed	6 Acres

AMERICAN LEGION

RECOMMENDED FOR APPROVAL	IN CHARGE OF DESIGN	DATE
RECOMMENDED FOR APPROVAL	CHIEF ENGINEER	DATE

MICHIGAN DEPARTMENT OF CONSERVATION
ENGINEERING AND ARCHITECTURE

HIGGINS LAKE STATE PARK
NORTH SHORE CAMPGROUND
ROAD GRADING PLAN

RECOMMENDED FOR APPROVAL

ENGINEER	DATE
CHIEF OF SPENDING DIVISION	DATE
REG. PROF. ENGINEER OR ARCHITECT	DATE

DESIGNED BY: POYET S-ES
DRAWN BY: COTE S-ES
CHECKED BY: NAME DATE

PLAN E-102
SHEET 10 of 13

E-102