

HIGGINS LAKE NORTH SHORE STATE PARK

AMERICAN LEGION ROAD RELOCATION PROJECT NO. PA108-5124-300-040-C-4

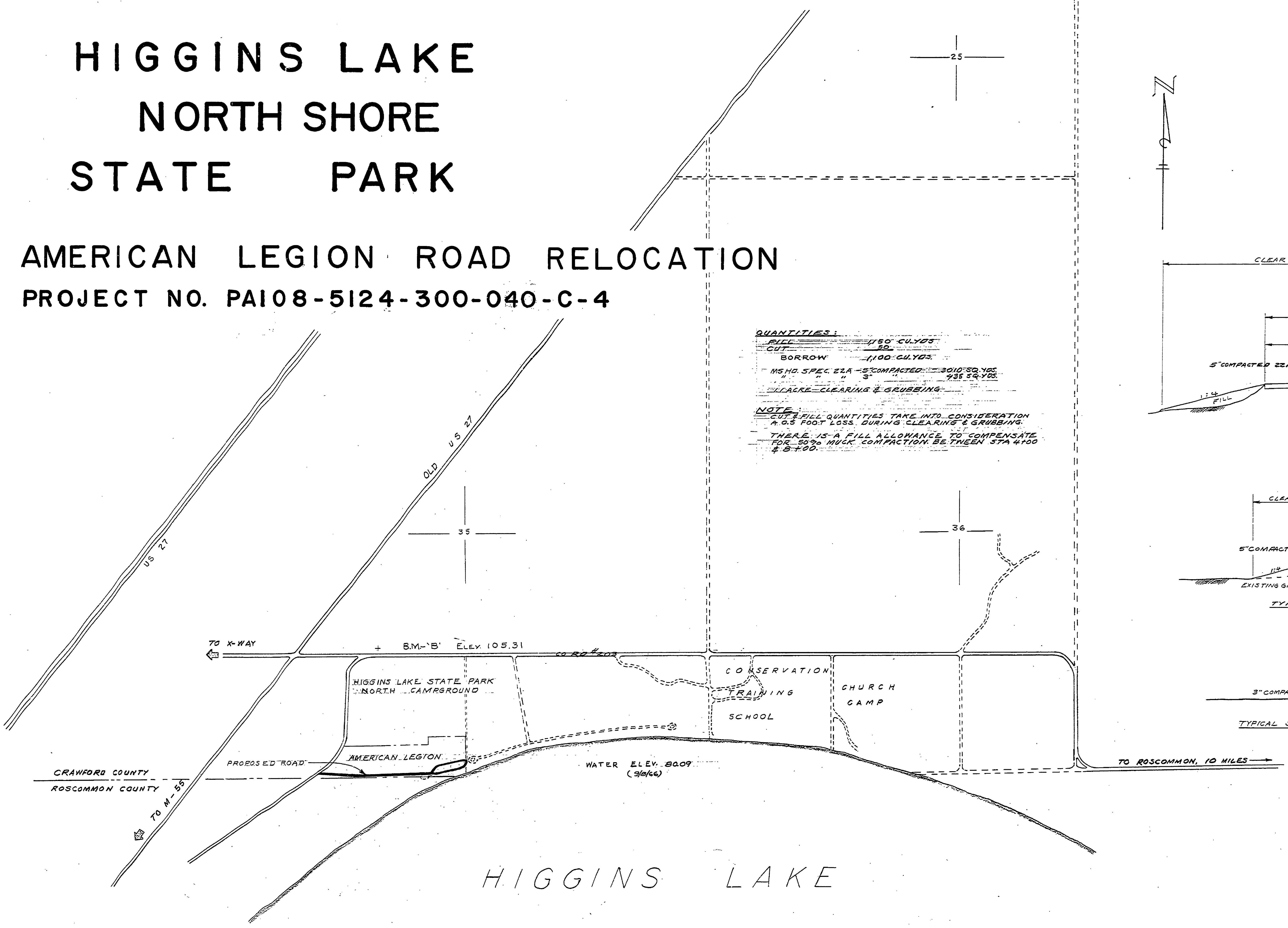
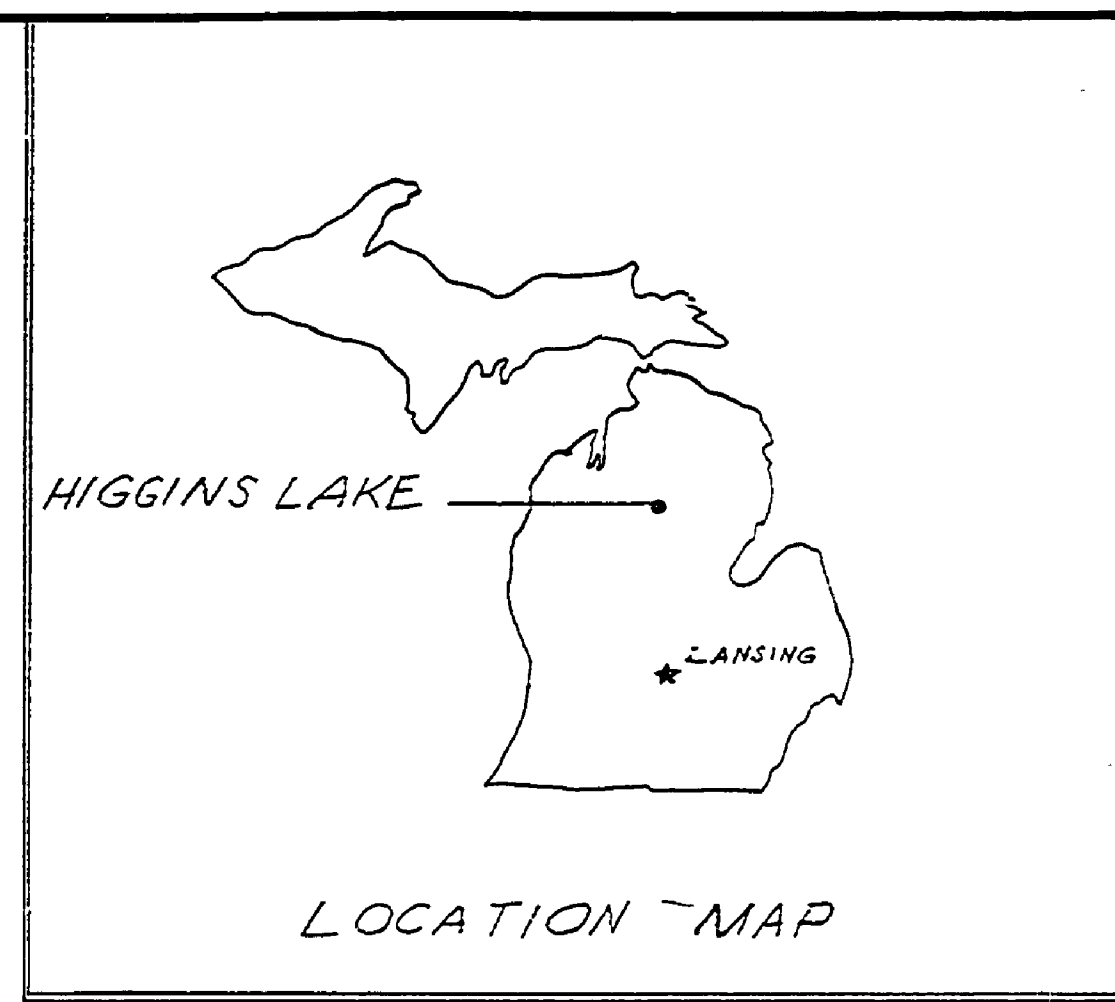

QUANTITIES:
 FILL 1150 CU.YDS.
 CUT 50
 BORROW 1100 CU.YDS.
 MSHD. SPEC. 22A - 5' COMPACTED 3010 SQ.YDS.
 " " " 3' " 435 SQ.YDS.
 CLEARING & GRUBBING

NOTE:
 CUT & FILL QUANTITIES TAKE INTO CONSIDERATION A 0.5 FOOT LOSS DURING CLEARING & GRUBBING.
 THERE IS A FILL ALLOWANCE TO COMPENSATE FOR 50% MUCK COMPACTION BETWEEN STA 4100 & 4200.

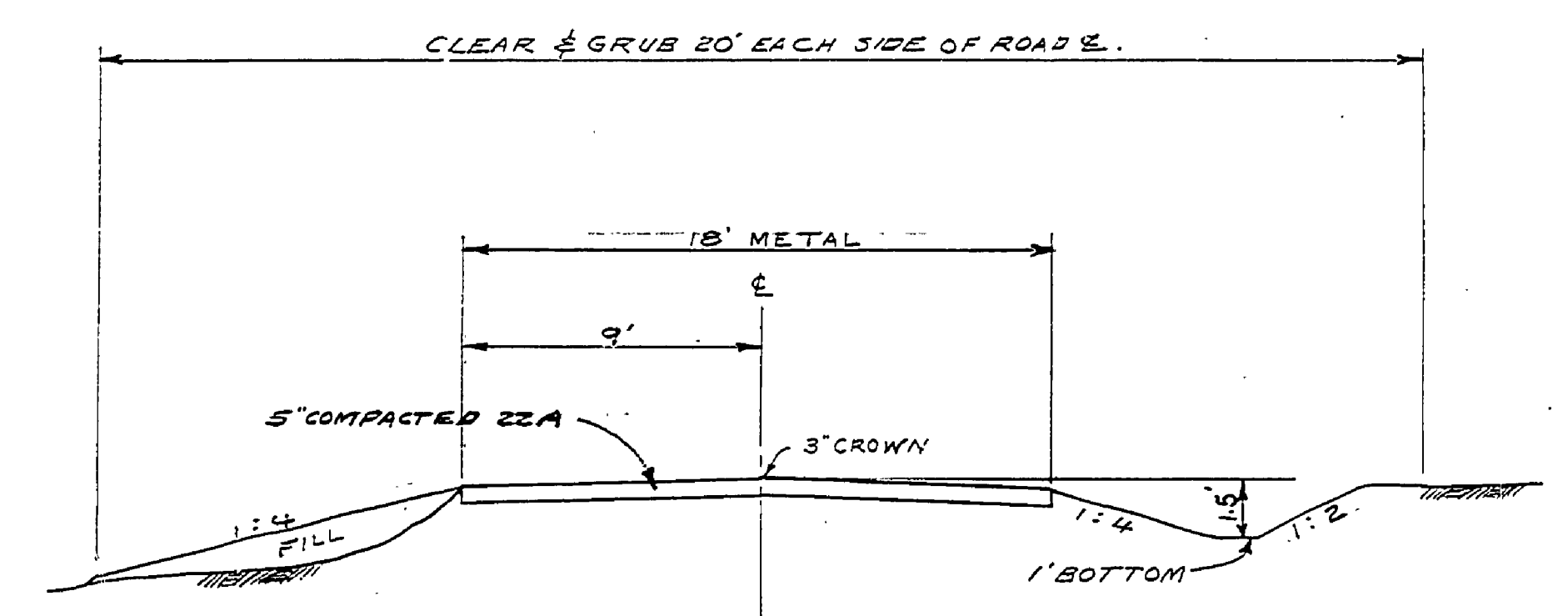
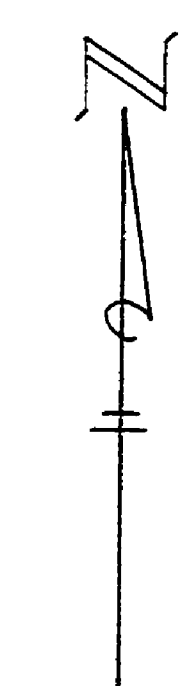

TYPICAL SECTION
18' ROAD
SCALE: 1"=5'

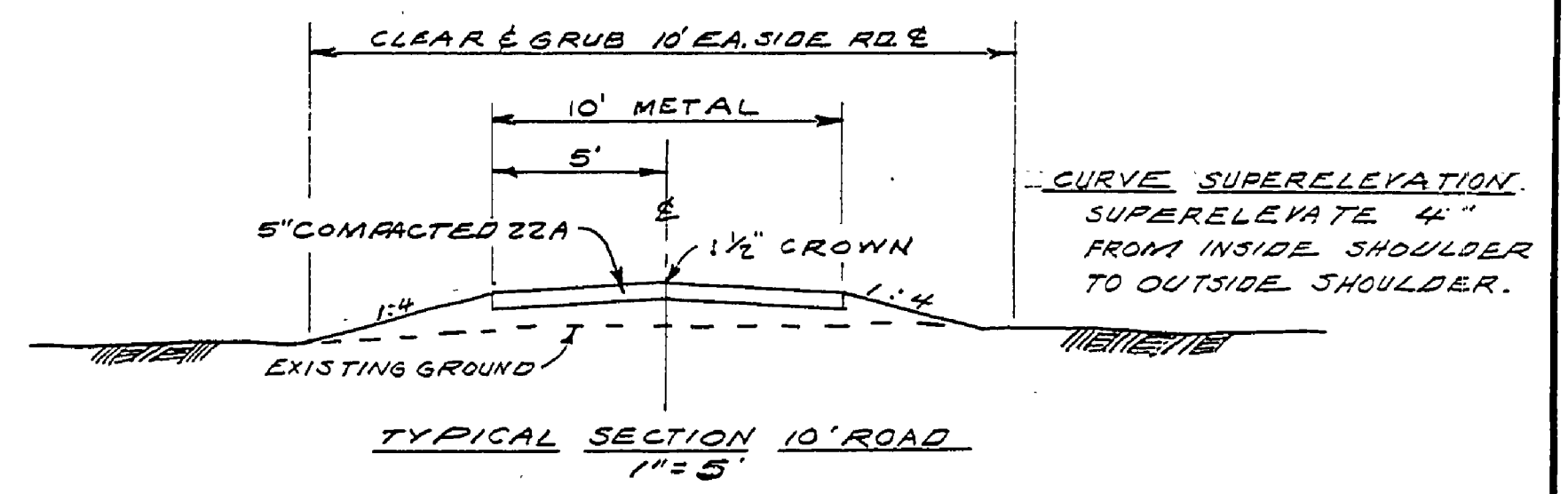

TYPICAL SECTION 10' ROAD
1"=5'

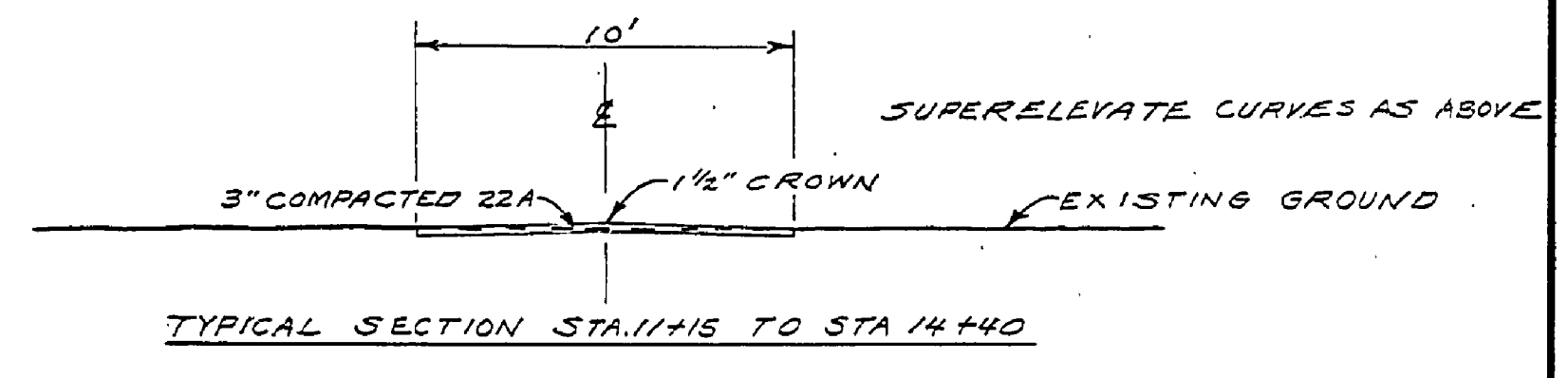

TYPICAL SECTION STA 14115 TO STA 14440

HIGGINS LAKE

| | |
|--|----------------|
| BY: | DATE: |
| RECOMMENDED FOR APPROVAL: <i>H. J. Hines</i> | 10-6-66 |
| RECOMMENDED FOR APPROVAL: <i>R. O. Dwyer</i> | 10-7-66 |
| SECTION APPROVAL | |
| BY: <i>Robert O. Dwyer</i> | 10-28-66 |
| ENGINEERING SECTION | |
| APPROVED: <i>H. C. MacLennan</i> | 11-10-66 |
| HIGGINS LAKE STATE PARK-NORTH AMERICAN LEGION RD. RELOCATION | |
| SHEET 1 OF 2 | PLAN NO. E-103 |

| | | | | | | | | | | | | | | |
|--|------|---|-------|-----|------|----|-----------|-----|------|----|-----------|-------------------------------------|-------------|--|
| SURVEYED BY: <i>R. BRATSCH & A. KINNEE</i> | 9/66 | DRAWN BY: <i>R. BRATSCH & A. KINNEE</i> | 9/66 | NO. | DATE | BY | REVISIONS | NO. | DATE | BY | REVISIONS | MICHIGAN DEPARTMENT OF CONSERVATION | TITLE SHEET | SHEET NO. 1 OF 2 |
| DESIGNED BY: <i>A. KINNEE</i> | 9/66 | CHECKED BY: | DATE: | 1. | | | | 3. | | | | | | FOR PROJECT NO. PA108-5124-300-040-C-4 |
| | | | | 2. | | | | 4. | | | | | | |