

BM 22: Elev. 104.41  
CHISELED  $\square$  ON NW COR. FORM  
ON N. SIDE TOILET BLDG.

NOTE: LOCATION OF WATER &  
ELECT. LINE CROSSINGS ARE  
APPROX. ONLY.

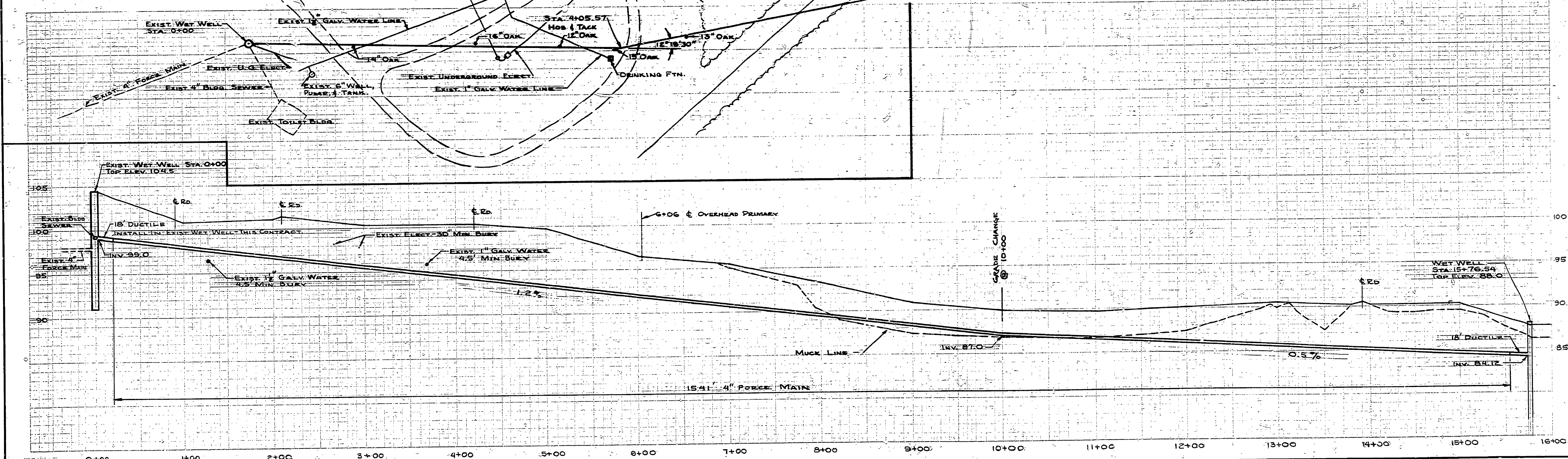

SURVEYED BY	DRAWN BY J. YEMA	NO.	DATE	BY	REVISIONS	NO.	DATE	BY	REVISIONS	MICHIGAN DEPARTMENT OF CONSERVATION	FORCE MAIN	SHEET NO. OF	HIGGINS LAKE NORTH STATE PARK
DESIGNED BY H. MERRILL	CHECKED BY	1.				3.						FOR PROJECT NO. 2108	SHEET 7 OF 10 PLAN NO. E-104
DATE	DATE	2.				4.							