

### LEGEND:

ROADS	EXISTING	PROPOSED	OBLITERATE
PARKING AREAS			
BUILDINGS			
FIRE TRAIL ROADS			
FOOT TRAILS			
VEGETATION			

### BUILDING LEGEND:

- CONSERVATION SCHOOL BUILDINGS**
- ① LOUNGE, ADMINISTRATION BUILDING & KITCHEN
  - ② GARAGE
  - ③ CHAPEL
  - ④ SHOP
  - ⑤ STORAGE
  - ⑥ DORMITORY #2
  - ⑦ CLASSROOM
  - ⑧ DORMITORY #3
  - ⑨ DORMITORY #1
  - ⑩ DORMITORY #4
  - ⑪ HEATING PLANT
  - ⑫ STAFF BUILDING

### PARK BUILDINGS:

- Ⓐ CONTACT BUILDING
- Ⓑ TOILET-SHOWER BLDG.
- Ⓒ PICNIC-TOILET BLDG.
- Ⓓ BEACH
- Ⓔ SHOP, GARAGE, OFFICE
- Ⓕ RESIDENCE
- Ⓖ INTERPRETIVE BLDG.
- Ⓗ CONE BARN
- Ⓘ PACKING HOUSE
- Ⓝ NURSERY OFFICE

### CAPACITIES:

FACILITY	EXISTING	PROPOSED
CAMPGROUND	201 SITES	0
BEACH PARKING	0	400 CARS
BOAT LAUNCH	0	25 CAR-TRAILERS
INTERPRETIVE PARKING	0	50 CARS - 20 BUSES
CONSERVATION SCHOOL	50 CARS	0
MISCELLANEOUS	10 CARS	10 CARS

ESTIMATED DESIGN CAPACITY AT ONE TIME: 3,000 VISITORS

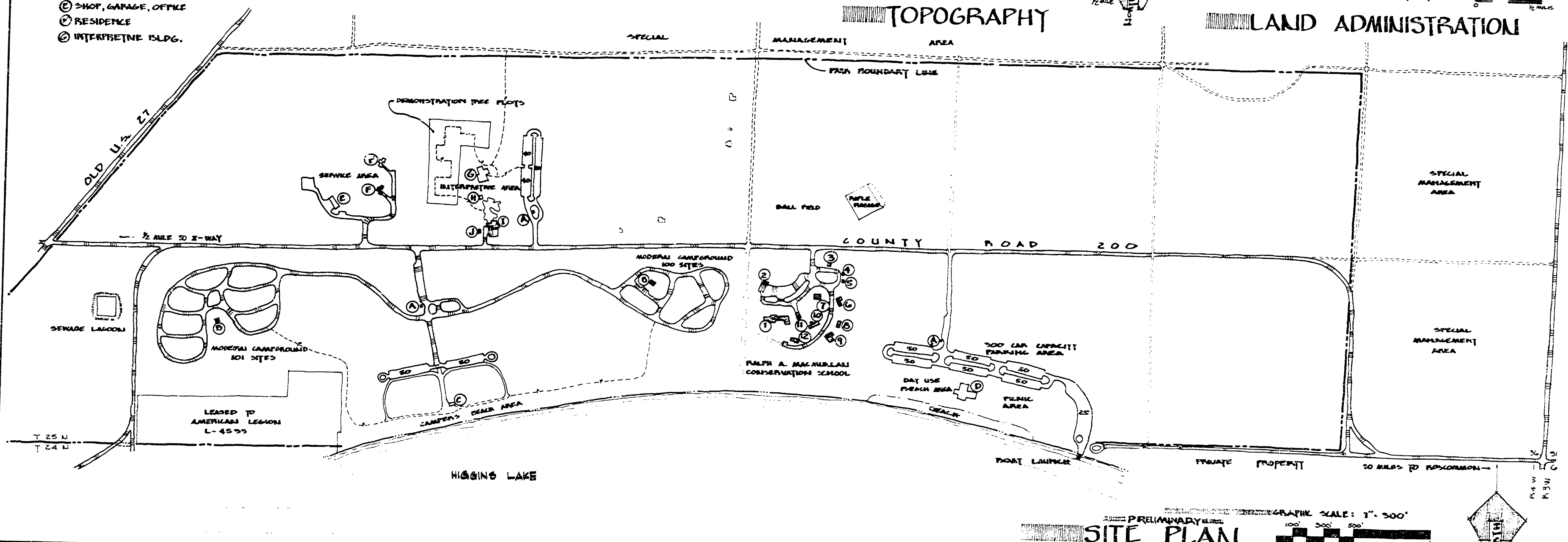
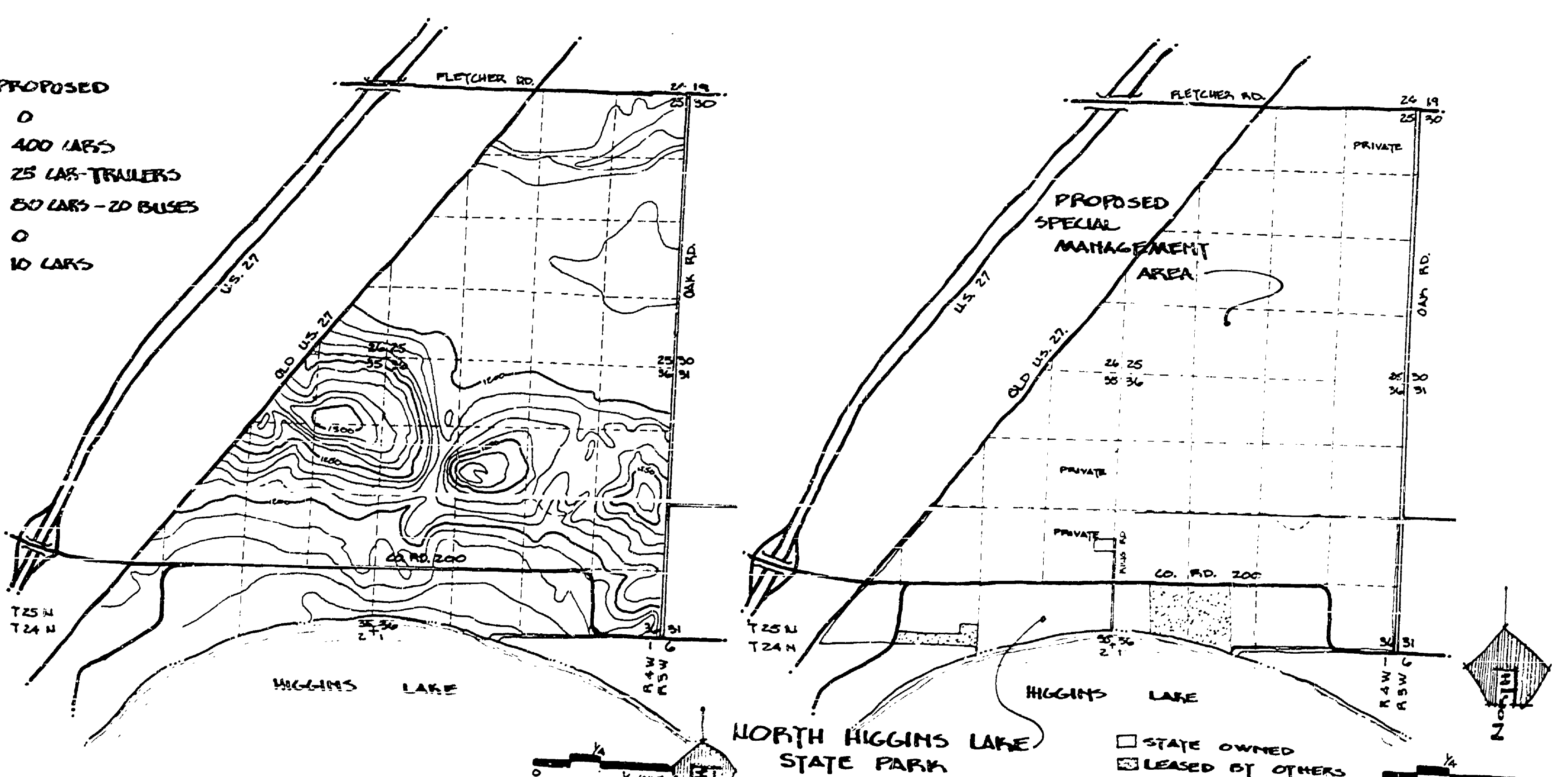
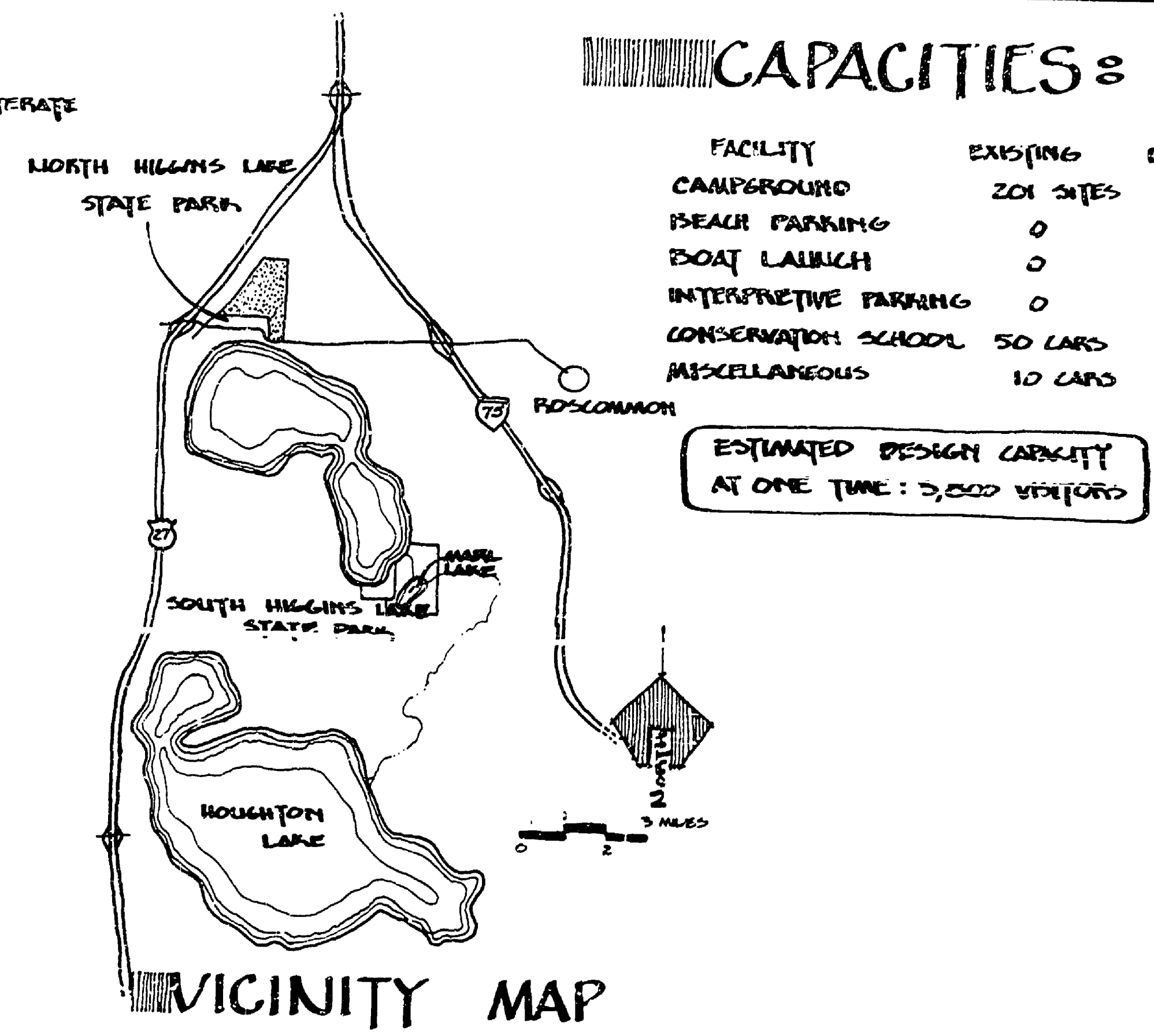

PRELIMINARY SITE PLAN  
GRAPHIC SCALE: 1" = 500'  
0 100' 200' 300' 400' 500' 1000'

SURVEYED BY	DRAWN BY T. J. STEELE...	NO. DATE BY	REVISIONS	NO. DATE BY	REVISIONS	MICHIGAN DEPARTMENT OF NATURAL RESOURCES	NORTH HIGGINS LAKE STATE PARK SHEET TITLE	AREA OR PARK	PROJECT NO. MASTER PLAN
DESIGNED BY HESSLER	10/73	CHECKED BY							SHEET 1 OF 1 PLAN NO. L-100