

**e SITE DETAIL**

Working plan for design implementation.

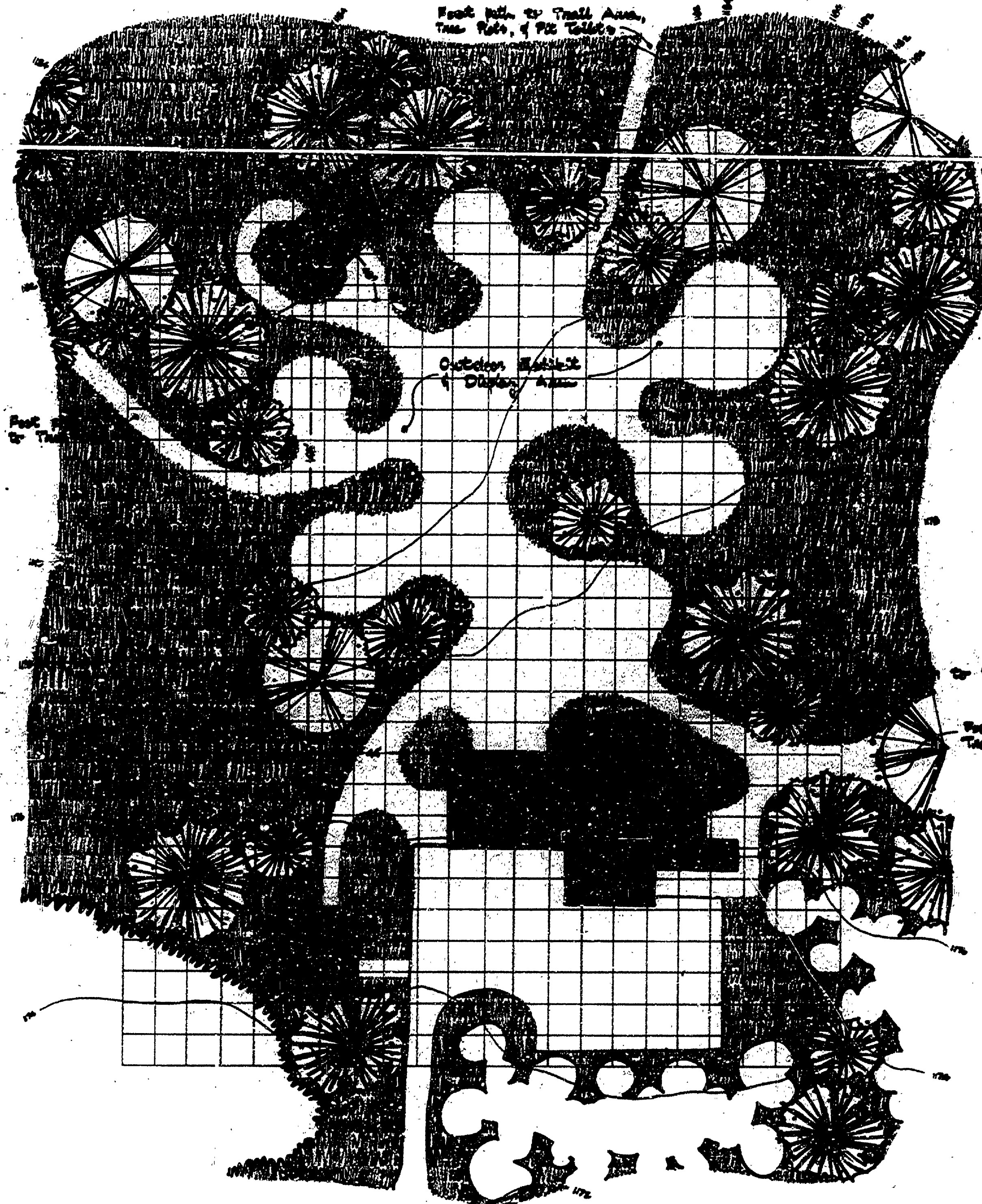

**notes**

- The primary intent of the adjacent site plan is to serve as a guideline for siting the cone barn. Upon acceptance and implementation of the proposed design (other than the siting of the cone barn) more detailed site and construction plans will be necessary. The final siting of the cone barn will be field checked and only minor adjustments will be made according to any on site conditions which might exclude such adjustments.
- The area shown for the outdoor exhibit area will remain flexible in design until the decision has been made as to the type and extent of the displays to be included in the interpretive program. Therefore, the adjacent plan doesn't necessarily reflect the final design layout. The superimposed grid system (10 ft. square) is provided to show the approximate areas involved in the outdoor exhibit area.
- Deciduous and evergreen vegetation of suitable species and size located within any area of clearing and grubbing for future construction will be transplanted in the areas of the proposed plantings.

REVIEWED BY: Bob Helms 6-29-72  
ACTING IN CHARGE, PARK DESIGN DATE  
 APPROVED BY: [Signature] 6-29-72  
CHIEF, PARK DESIGN DATE

**legend**

- ARCHITECTURAL ELEMENTS
  - ▭ TRADING HOUSE
  - ▭ OFFICE
  - CONE BARN
- EXISTING DECIDUOUS VEGETATION
- EXISTING EVERGREEN VEGETATION
- PROPOSED GENERAL PLANTINGS
- EXISTING & PROPOSED OUTDOOR / L.P.C. ENT.



North  
**HIGGINS LK.**  
 State Park

**INTERPRETIVE DEVELOPMENT PROPOSAL**

Michigan Department of Natural Resources

PRELIMINARY  
 CONE BARN SITE PLAN  
 DESIGNED & DRAWN BY: [Signature] RINCK / MAR 72  
 Park Division

R-97