

DRAWN BY W. COZUJOSKI	CHECKED BY	REVIEWED BY SECTIONS	DATE	APPROVED BY	NO. DATE BY	REVISIONS
		ARCHITECTURAL	J.I.R. 9-14-60	J.I.R.	1	4
		ENGINEERING	J.I.R. 9-14-60	ASSISTANT CHIEF IN CHARGE	2	5
		LANDSCAPE	J.I.R. 9-14-60	OF DESIGN	3	6

INDIAN LAKE

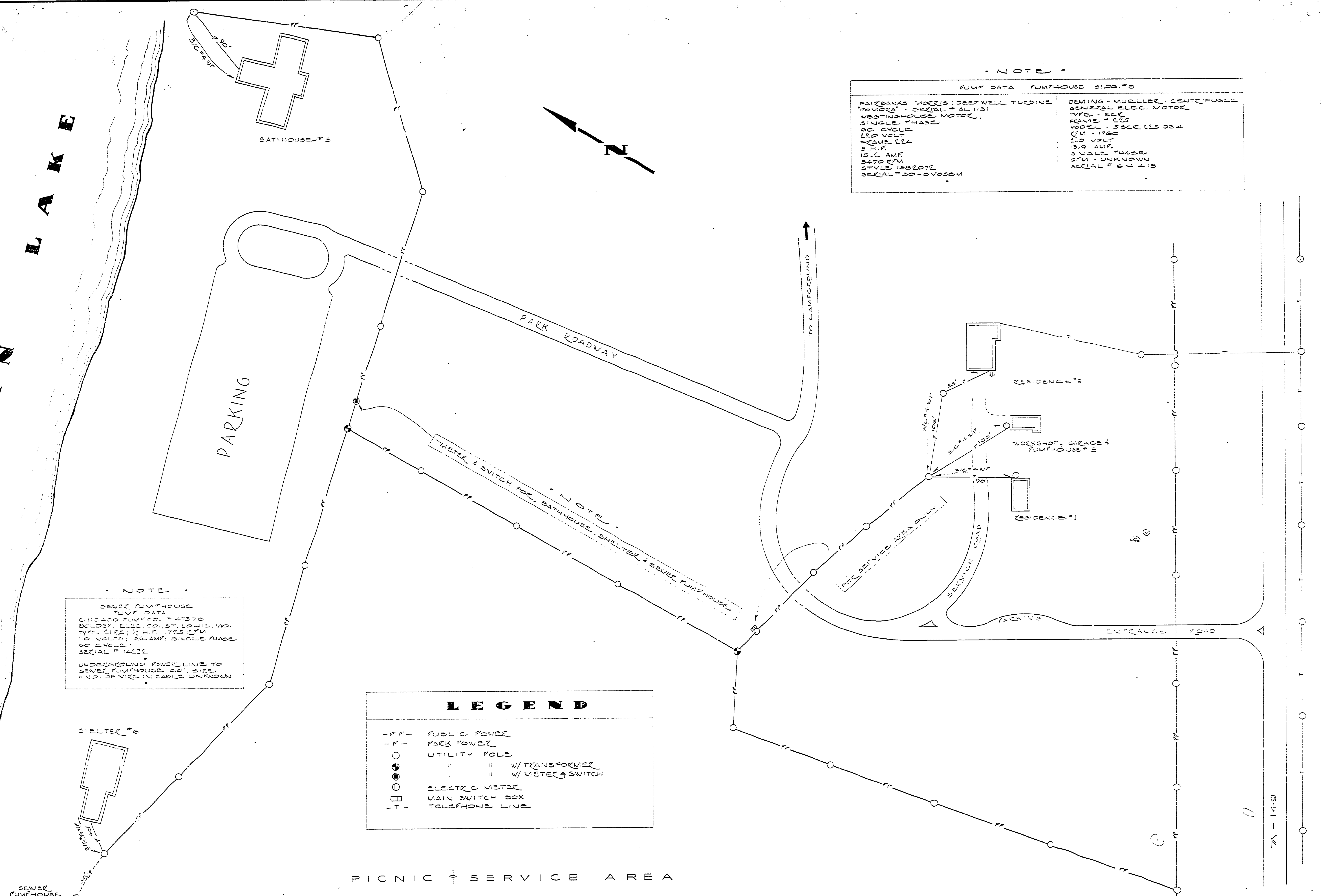

NOTE
SEWER PUMPHOUSE
PUMP DATA
CHICAGO PUMP CO. # 47378
SEWER, ELEC. CO. ST. LOUIS, MO.
TYPE 5125 1/2 HP. 1725 RPM
110 VOLTS, 54 AMP, SINGLE PHASE
60 CYCLE
SERIAL # 14122
UNDERGROUND POWER LINE TO
SEWER PUMPHOUSE 60' SIZE
& NO. OF WIRE IN CABLE UNKNOWN

LEGEND

— P —	PUBLIC POWER
— P —	PARK POWER
○	UTILITY POLE
○ ⊕	" " W/ TRANSFORMER
○ ⊕ ⊕	" " W/ METER & SWITCH
⊕	ELECTRIC METER
⊕ ⊕	MAIN SWITCH BOX
- - -	TELEPHONE LINE

NOTE

PUMP DATA	PUMPHOUSE 5125 #3
FAIRBANKS MODEL 5 DREFWELL TURBINE PUMPER - SERIAL # AL 1131 WESTINGHOUSE MOTOR, SINGLE PHASE 60 CYCLE 110 VOLT FRAME 124 3 H.P. 15.2 AMP 3470 RPM STYLE 1582072 SERIAL # 50-5V550M	DEWING - MUELLER - CENTRIFUGAL GENERAL ELEC. MOTOR TYPE - 506 FRAME # 125 MODEL - 500C 125 DS-4 CFM - 1740 110 VOLT 15.8 AMP SINGLE PHASE CFM - UNKNOWN SERIAL # 61 413

INDIAN LAKE STATE PARK

SCALE 1" = 50'-0"

MICHIGAN
DEPARTMENT OF CONSERVATION
PARKS AND RECREATION DIVISION

INDIAN LAKE STATE PARK
UTILITY MAP
ELECTRICAL SYSTEM

SHEET
NO. 1
OF 6

PLAN NO.
U-1
8-7

7A-14-9