

J. W. WELLS STATE PARK OFFICE & SERVICE GARAGE

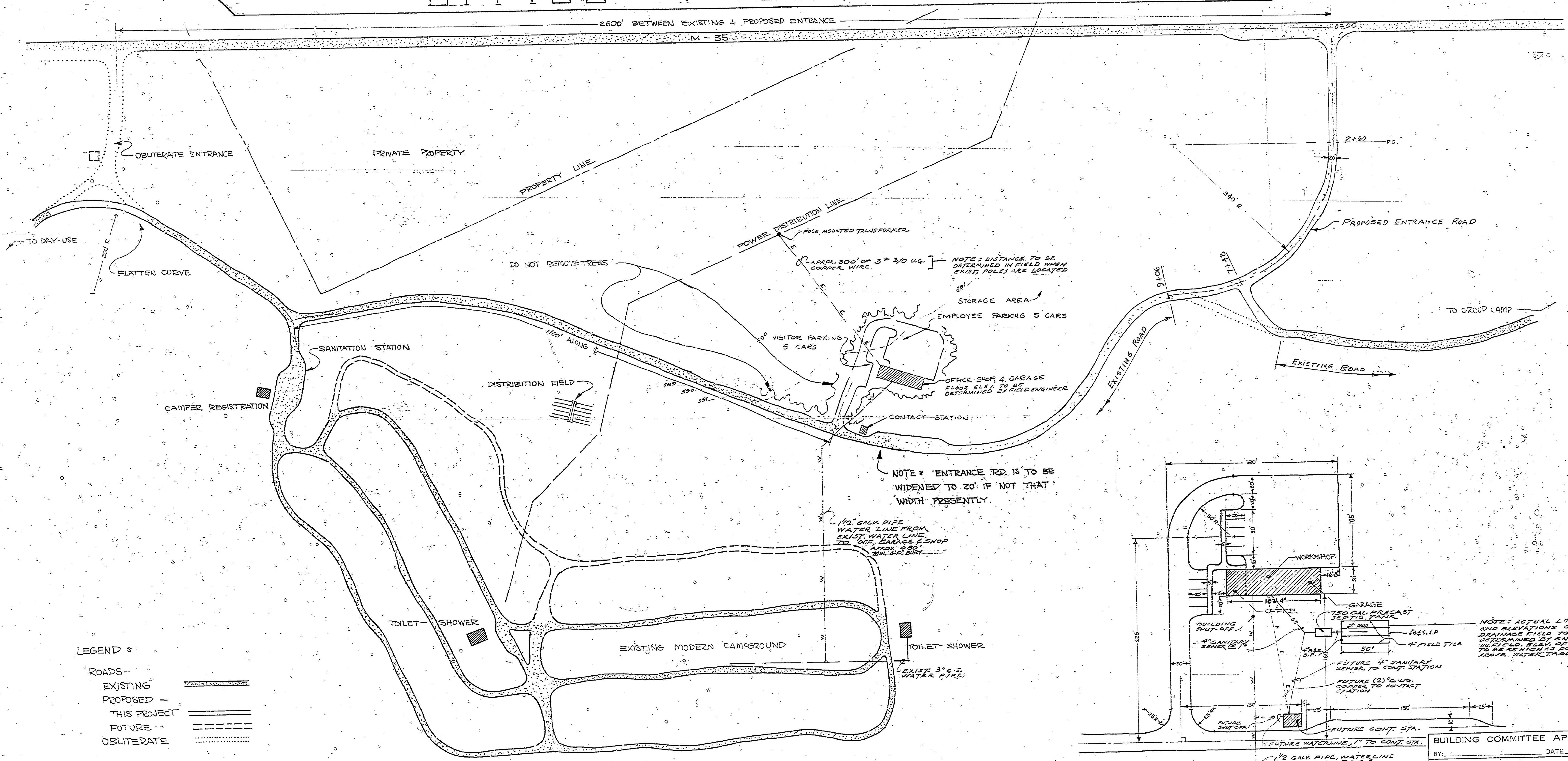

LEGEND:
 ROADS—
 EXISTING ———
 PROPOSED ———
 THIS PROJECT ———
 FUTURE ———
 OBLITERATE - - - - -

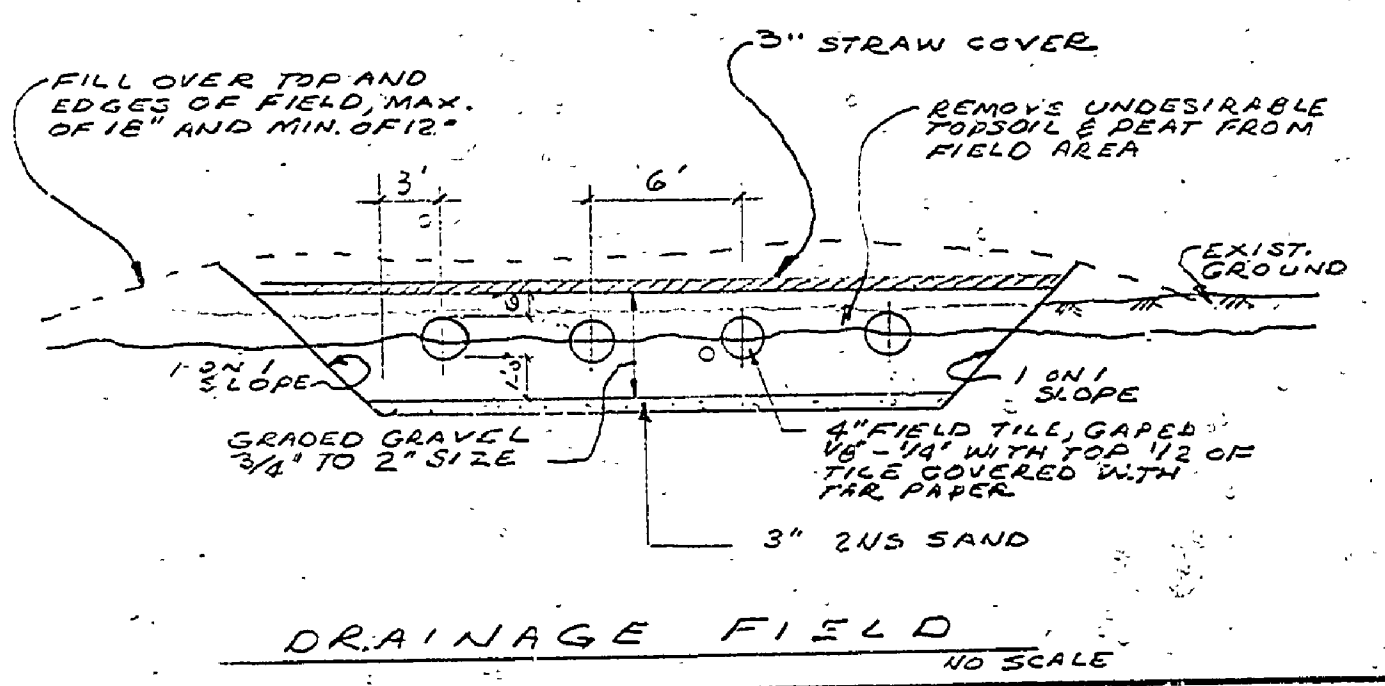
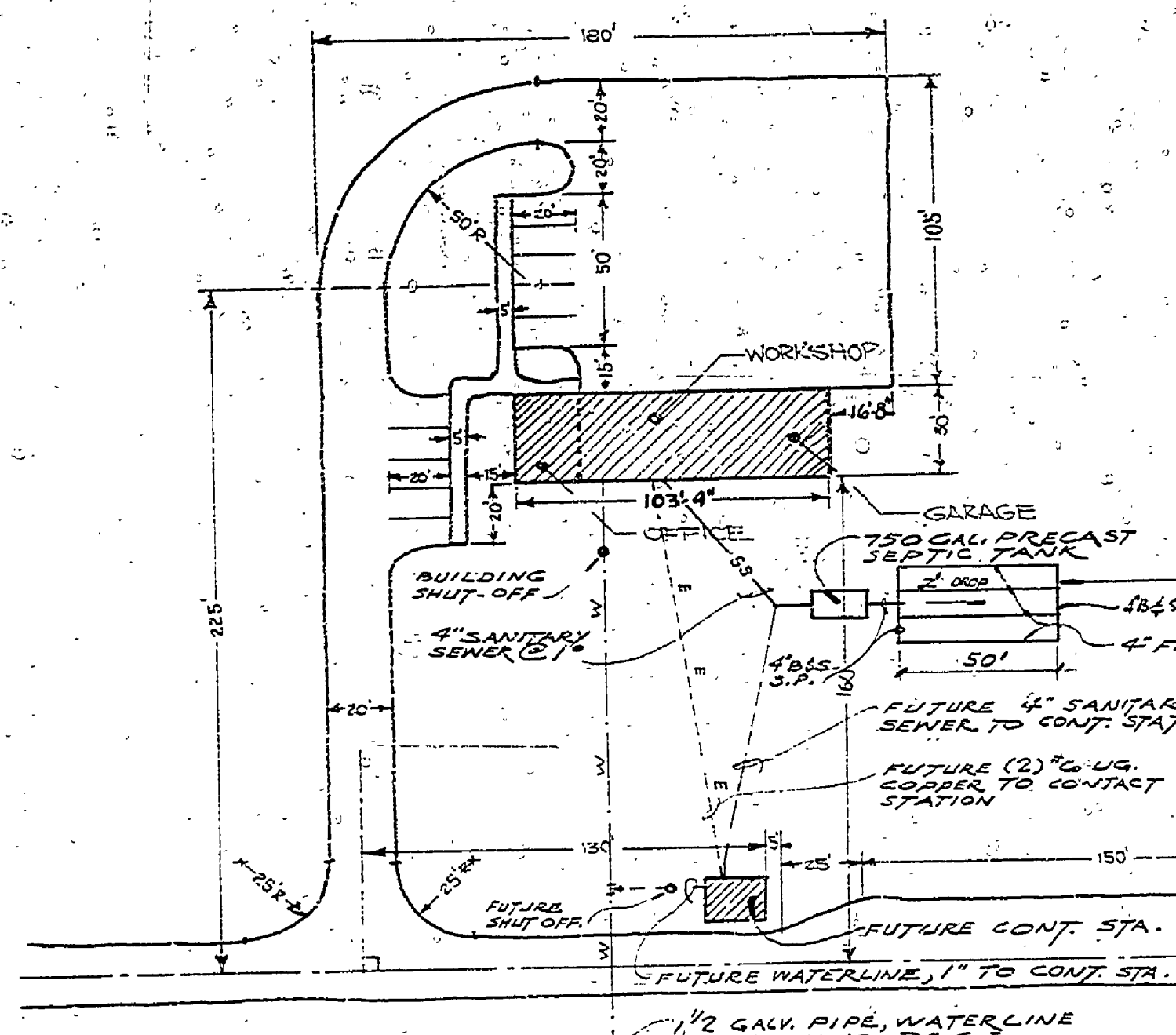
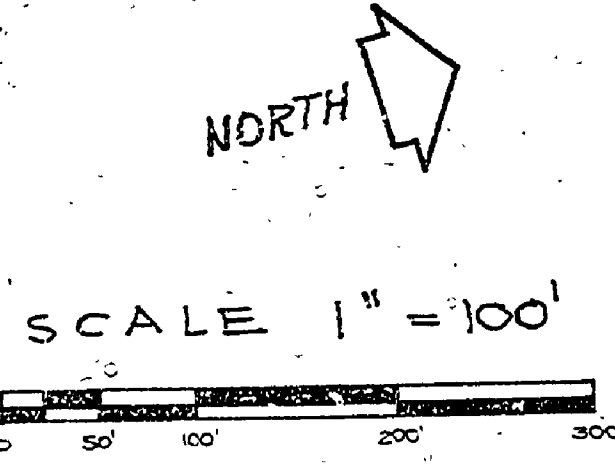

BUILDING COMMITTEE APPROVAL		
BY:	DATE:	
RECOMMENDED FOR APPROVAL:	DESIGNER	2-23-70
RECOMMENDED FOR APPROVAL:	DESIGNER	2-24-70
BY:	DIVISION CHIEF	4-10-70
MICHIGAN DEPARTMENT OF NATURAL RESOURCES		
APPROVED:	CHIEF ENGINEER	4-15-70
PLAN NO.	PROJECT NUMBER	SHEET OF

SURVEYED BY: KESSLER		DRAWN BY: KESSLER		10/69		NO. DATE BY		REVISIONS		NO. DATE BY		REVISIONS		MICHIGAN DEPARTMENT OF NATURAL RESOURCES		WELLS STATE PARK SHEET TITLE		AREA OR PARK PROJECT #1002		SITE PLAN OFFICE, SHOP, & GARAGE	
DESIGNED BY: KESSLER		CHECKED BY: R.G.H. - L.C.M.		10-25-69		1. 10/25/69 RULM		LINED SERVICE AREA 100' NORTH		3.										SHEET 1 OF 3 PLAN NO. A-108	
DATE		DATE		DATE		2. RE 74 MK		CHANGED TO SHOW AS BUILT COND.		4.											