

DRAWN BY R.C. BENNETT A.S.C. TRACED BY CHECKED BY R.M. DATE Sep. 19, 1956	REVIEWED BY SECTIONS ARCHITECTURAL J.P.R. ENGINEERING J.P.R. LANDSCAPE J.P.R.	DATE 11-30-56 11-30-56 11-30-56	APPROVED BY H.C. McLaughlin ASSISTANT CHIEF IN CHARGE OF DESIGN DATE 3-11-57	NO. 1 DATE BY	REVISIONS 4 5 6	DATE BY
--	--	---------------------------------------	---	---------------------	--------------------------	------------

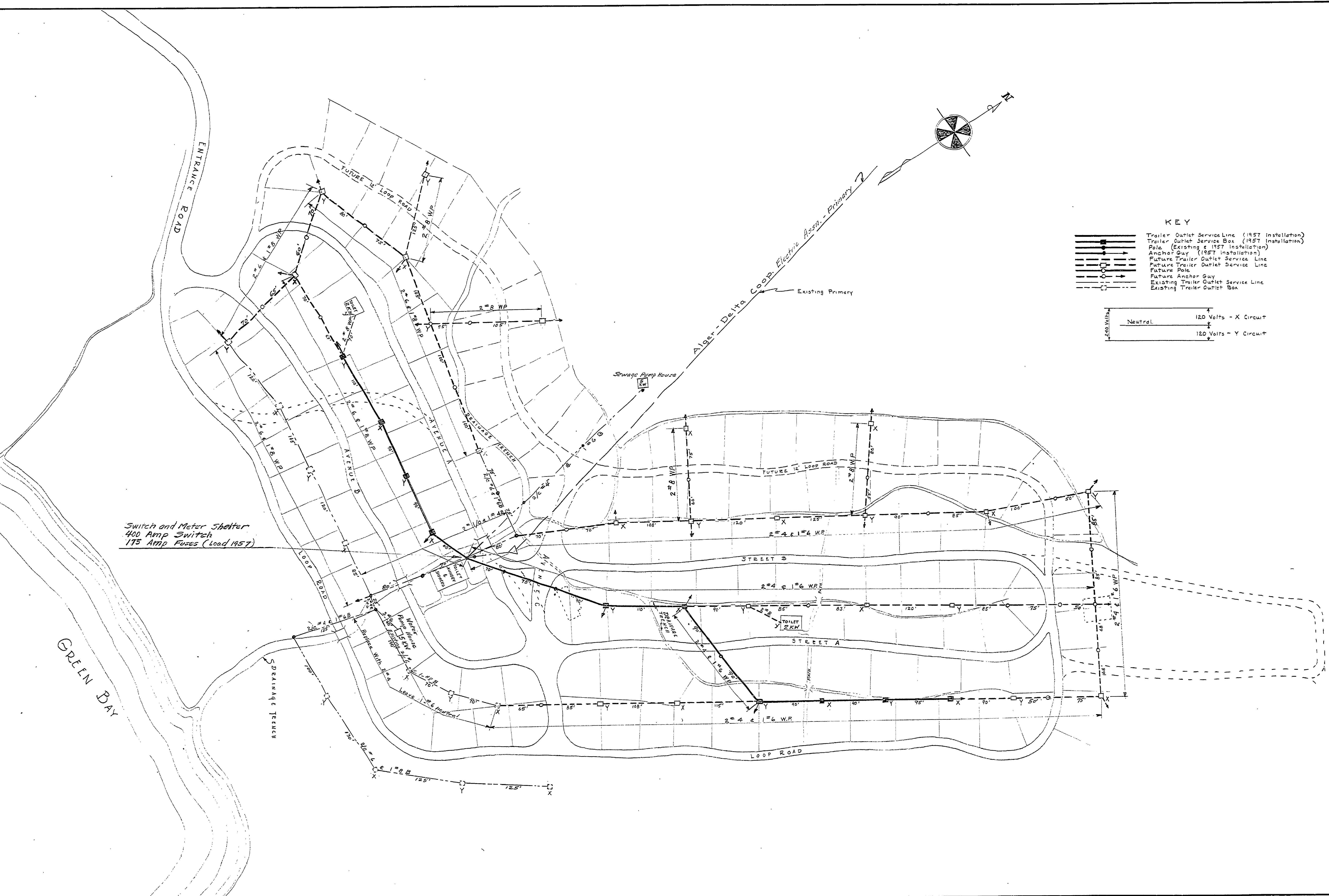

KEY

- Trailer Outlet Service Line (1957 Installation)
- Trailer Outlet Service Box (1957 Installation)
- Pole (Existing & 1957 Installation)
- Anchor Guy (1957 Installation)
- Future Trailer Outlet Service Line
- Future Trailer Outlet Service Line
- Future Pole
- Future Anchor Guy
- Existing Trailer Outlet Service Line
- Existing Trailer Outlet Box

120 Volts - X Circuit
 Neutral
 120 Volts - Y Circuit

Scale 1" = 60'

MICHIGAN
DEPARTMENT OF CONSERVATION
PARKS AND RECREATION DIVISION

J. W. Wells State Park
Campground Electrical System

SHEET NO. 1
OF 1

PLAN NO. E-102