

SIMILAR PLANTINGS TO BE MADE ALONG
M-35 WITHIN PARK BOUNDARIES.

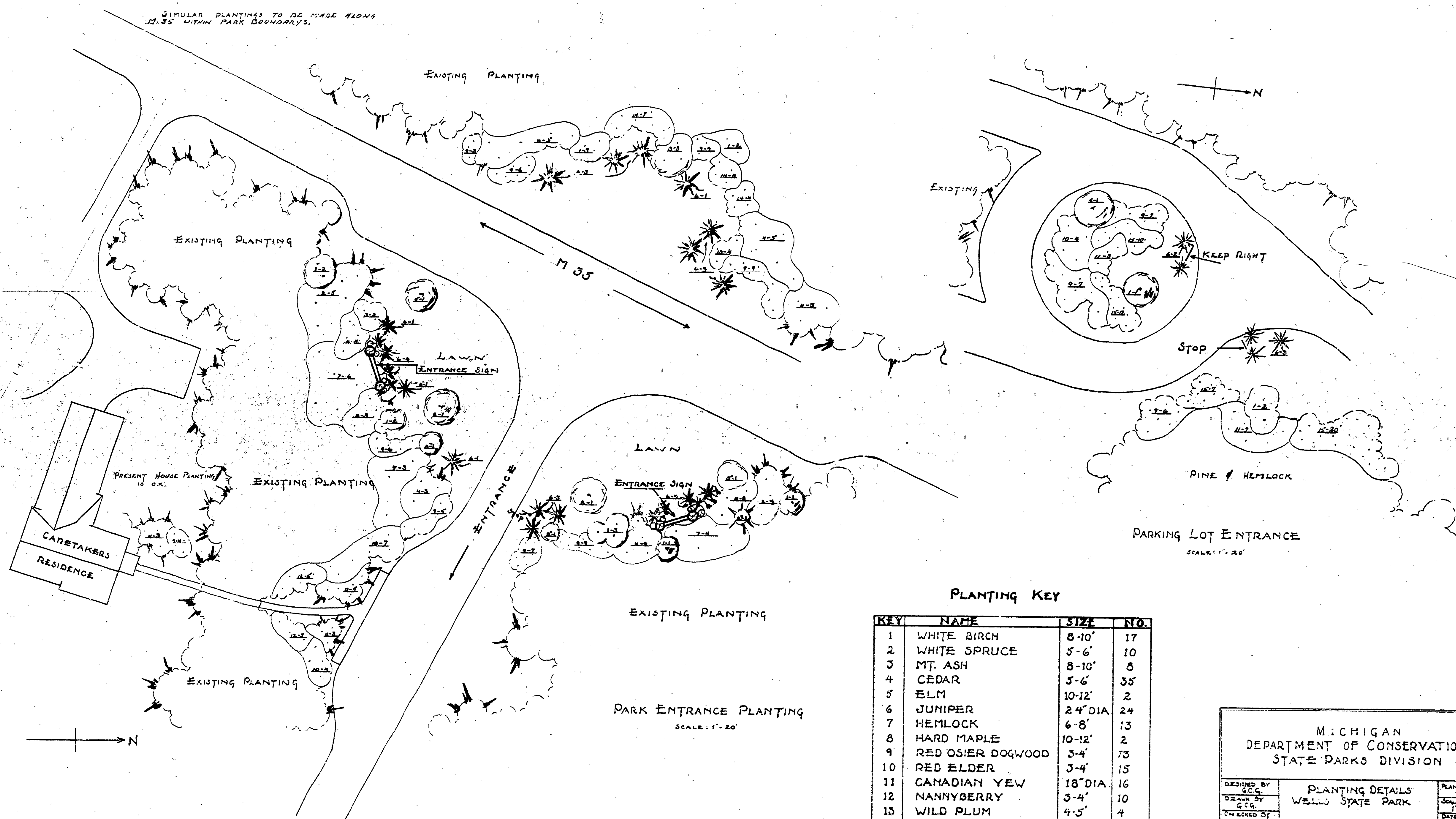

PLANTING KEY

KEY	NAME	SIZE	NO.
1	WHITE BIRCH	8-10'	17
2	WHITE SPRUCE	5-6'	10
3	MT. ASH	8-10'	8
4	CEDAR	5-6'	35
5	ELM	10-12'	2
6	JUNIPER	2 4" DIA.	24
7	HEMLOCK	6-8'	13
8	HARD MAPLE	10-12'	2
9	RED OSIER DOGWOOD	3-4'	75
10	RED ELDER	3-4'	15
11	CANADIAN YEW	18" DIA.	16
12	NANNYBERRY	3-4'	10
13	WILD PLUM	4-5'	4
14	JUNEBERRY	3-4'	8
15	WILD ROSE	2'	49

MICHIGAN
DEPARTMENT OF CONSERVATION
STATE PARKS DIVISION

DESIGNED BY G.C.G.	PLANTING DETAILS WELLS STATE PARK	PLAN NO. J-114
DRAWN BY G.C.G.		SCALE 1" = 20'
CHECKED BY		DATE MAY 1943
APPROVED BY CHIEF, PARKS DIVISION		DATE

L-114