

NO.	DATE	BY	REVISIONS
1			
2			
3			
4			
5			
6			

APPROVED BY	DATE
<i>[Signature]</i>	3-24-66

REVIEWED BY SECTIONS	DATE
ARCHITECTURAL	3-24-66
ENGINEERING	3-24-66
LANDSCAPE	3-24-66

DRAWN BY	CHECKED BY
J.I.R.	J.I.R.
DATE	DATE
3-24-66	3-24-66

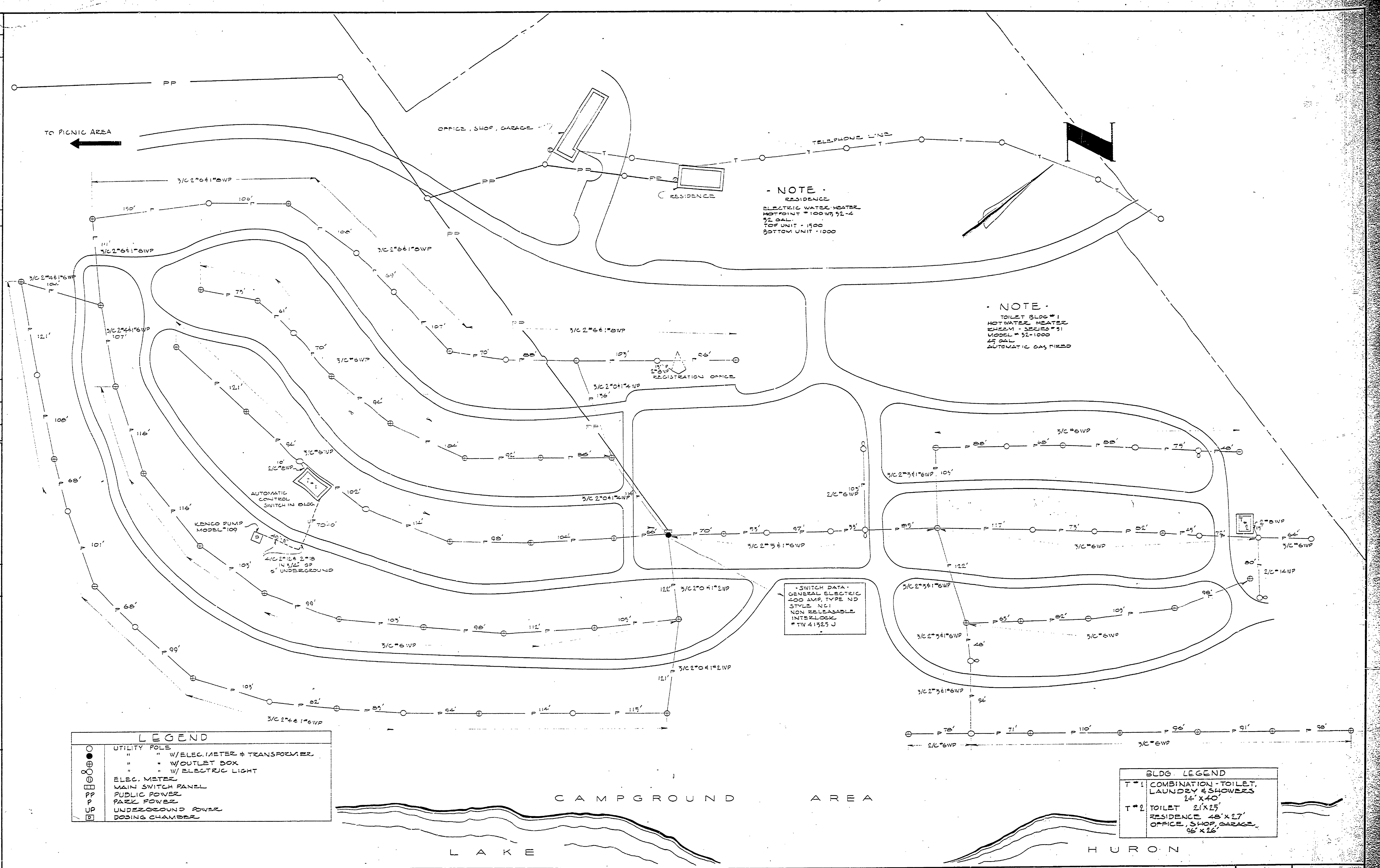

- NOTE -
 RESIDENCE
 ELECTRIC WATER HEATER
 HOTPOINT # 100WS 52-4
 32 GALL.
 TOP UNIT - 1500
 BOTTOM UNIT - 1000

- NOTE -
 TOILET BLDG # 1
 HOT WATER HEATER
 KHELM - SERIES # 51
 MODEL # 52-1000
 27 GALL.
 AUTOMATIC GAS FIRED

- SWITCH DATA -
 GENERAL ELECTRIC
 400 AMP. TYPE ND
 STYLE NC1
 NON RELEASABLE
 INTS. LOCK
 # TW 41325 J

LEGEND

○	UTILITY POLE
○	W/ELEC. METER & TRANSFORMER
○	W/OUTLET BOX
○	W/ELECTRIC LIGHT
○	ELEC. METER
○	MAIN SWITCH PANEL
○	PUBLIC POWER
○	PARK POWER
○	UNDERGROUND POWER
○	DOSING CHAMBER

BLDG LEGEND

T # 1	COMBINATION - TOILET, LAUNDRY & SHOWERS 24' X 40'
T # 2	TOILET 2 1/2' X 25' RESIDENCE 48' X 27' OFFICE, SHOP, GARAGE 96' X 12'

HARRISVILLE STATE PARK

SCALE 1"=50'-0"

MICHIGAN
 DEPARTMENT OF CONSERVATION
 PARKS AND RECREATION DIVISION

HARRISVILLE STATE PARK
 UTILITY MAP
 ELECTRICAL SYSTEM

SHEET
 NO. 2
 OF 4

PLAN NO.
 U-1
 R-11