

**ENTRANCE RACK**  
WITH METER SOCKET & CIRCUIT BREAKER PANEL BOARD

NOTE: GROUND ELECTRICAL SYSTEM AT DISTRIBUTION PANELBOARD TO NEAREST BURIED WATER PIPE

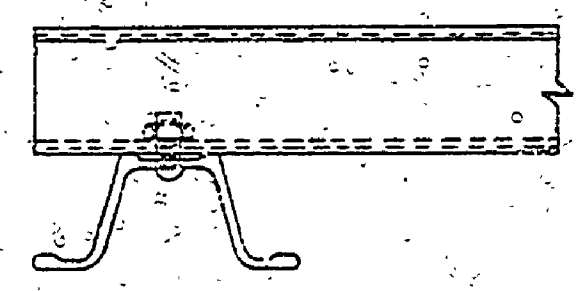

SECTION A-A  
NO SCALE

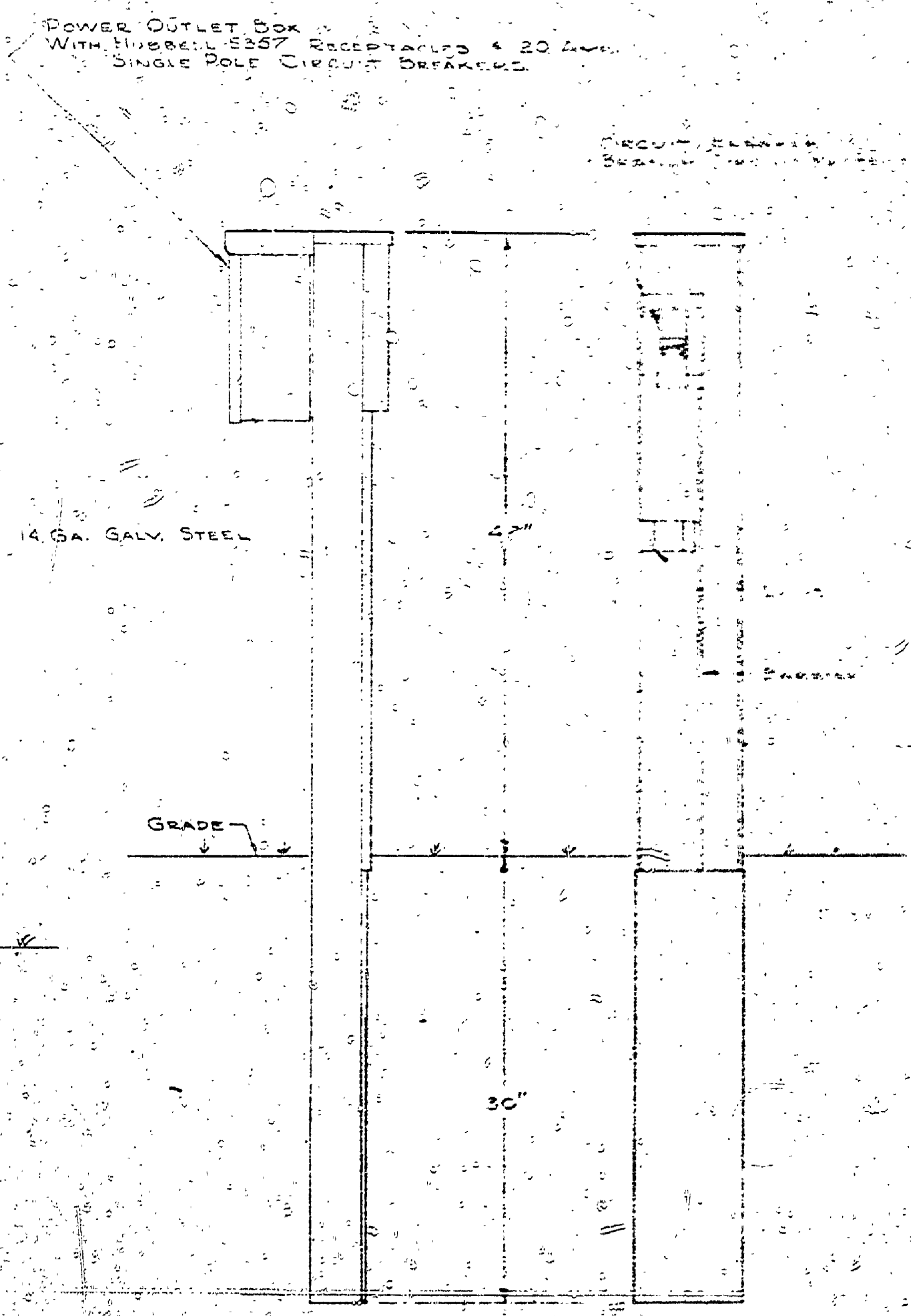

**JUNCTION POST**  
WITH OUTLET BOX & CLAMP CABLE PROTECTION

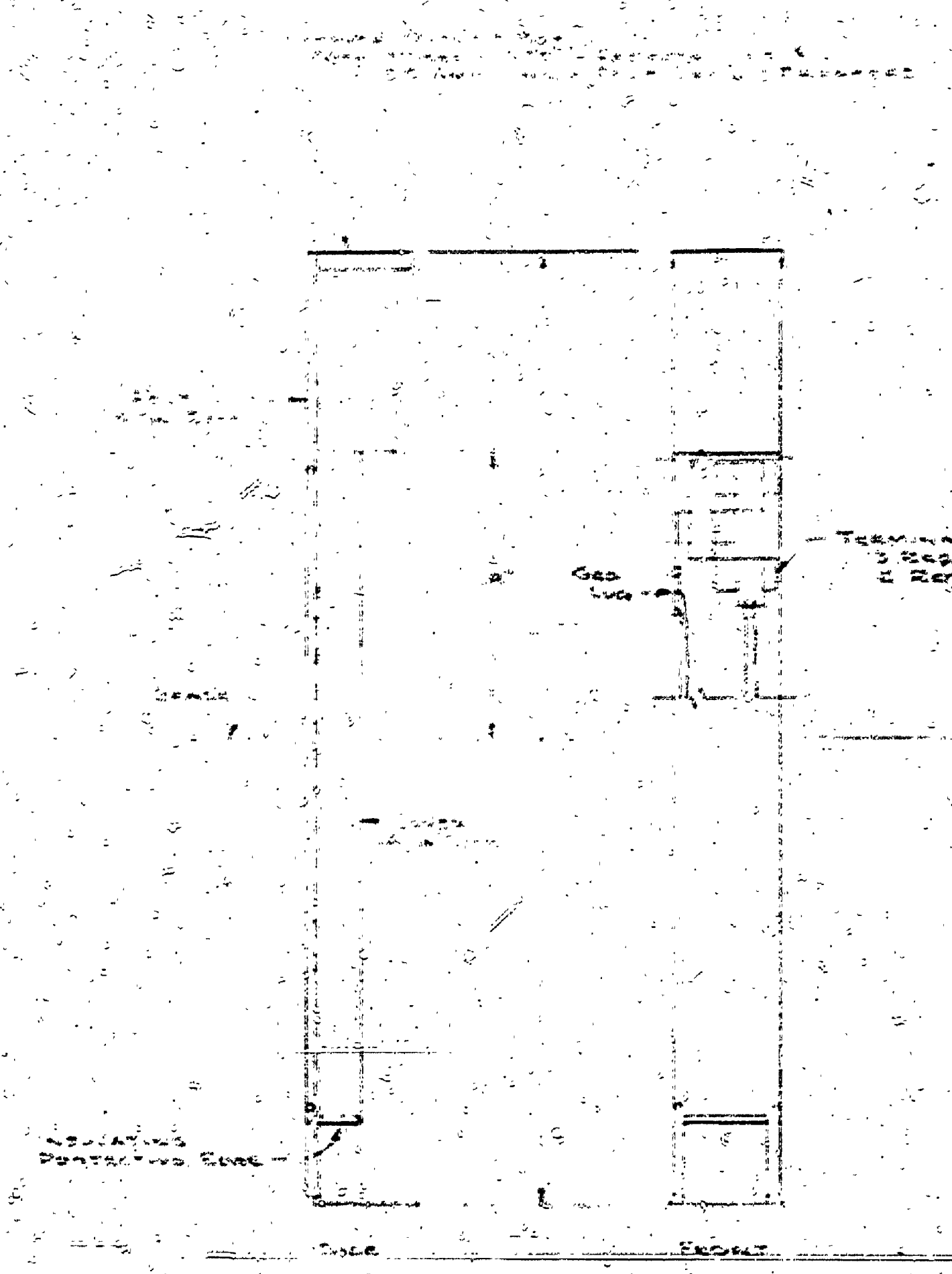

**MOUNTING POST**  
WITH OUTLET BOX

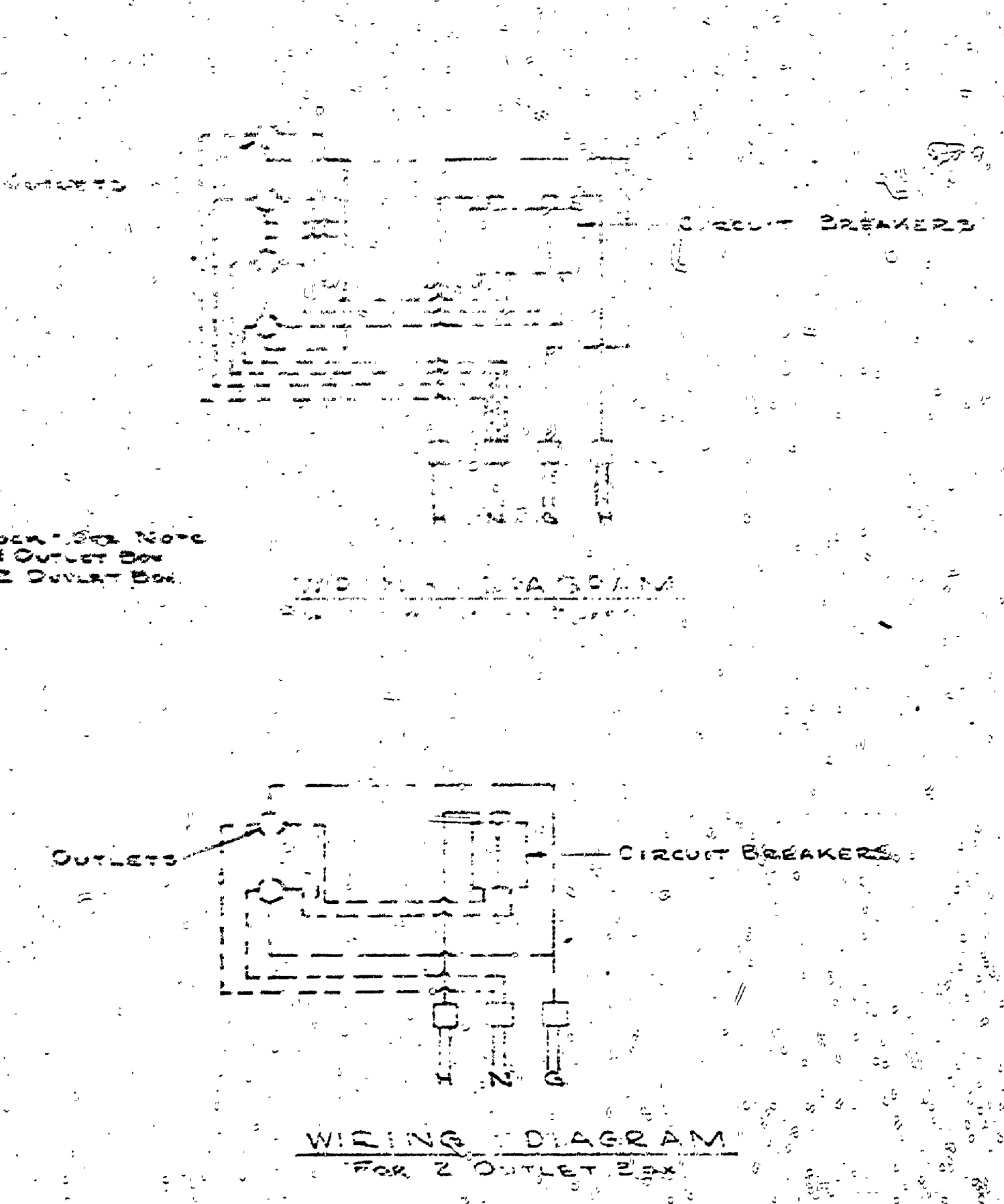

NOTE: USE POSTS ARE DESIGNED TO PERMIT LOOPING OF CABLE FROM ONE UNIT TO THE NEXT. SPLICING IS DONE IN FRONT & IS PROVIDED TO RECEIVE UP TO #4/0 AWG. INSULATED CABLE TO EQUIPMENT GROUND PROVIDED ON POST.

INSTALL CIRCUIT BREAKERS IN PANELBOARD FOR RESPECTIVE LINES DESIGNATED ON PLAN AS FOLLOWS:

MAIN BREAKER	500 AMP.
BRANCH #1	80 AMP.
BRANCH #2	80 AMP.
BRANCH #3	80 AMP.
BRANCH #4	100 AMP.
BRANCH #5	50 AMP.
BRANCH #6	50 AMP.
BRANCH #7	80 AMP.
BRANCH #8	80 AMP.
BRANCH #9	80 AMP.
BRANCH #10	TO AMP.

SURVEYED BY	DRAWN BY J. VERA & B. HANCOCK	Aug. '66	NO. DATE BY	REVISIONS	NO. DATE BY	REVISIONS	MICHIGAN DEPARTMENT OF CONSERVATION	STANDARD PLAN UNDERGROUND SECONDARY FOR CAMPGROUND	SHEET NO. OF	HARRISVILLE STATE PARK
DESIGNED BY W. J. DAVIS	Aug. '66	CHECKED BY	1. 4-15-68 J.V.	WIRING DIA. REV., TERMINAL BLOCK ADD.	3.				FOR PROJECT NO. 1049	SHEET 2 OF 2
	DATE		2.		4.					PLAN NO. E-117