

HALF SECTION 1-1 THRU SHOP
SCALE 3/8" = 1'-0"

HALF SECTION 1-1 THRU GARAGE
SCALE 3/8" = 1'-0"

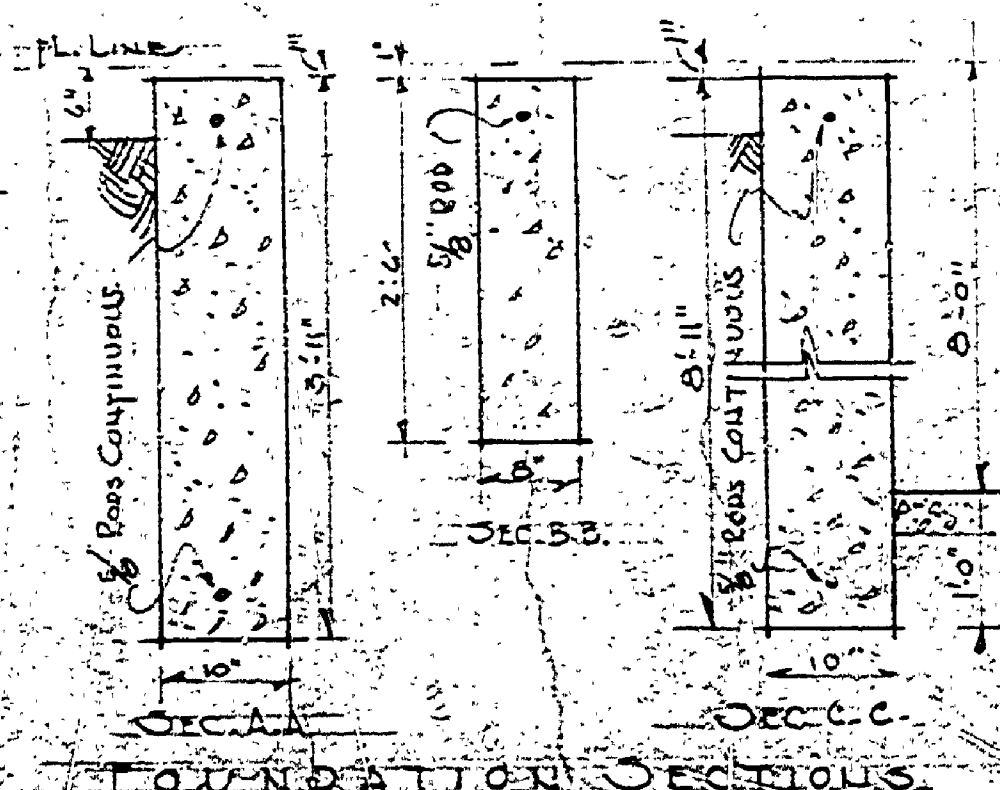
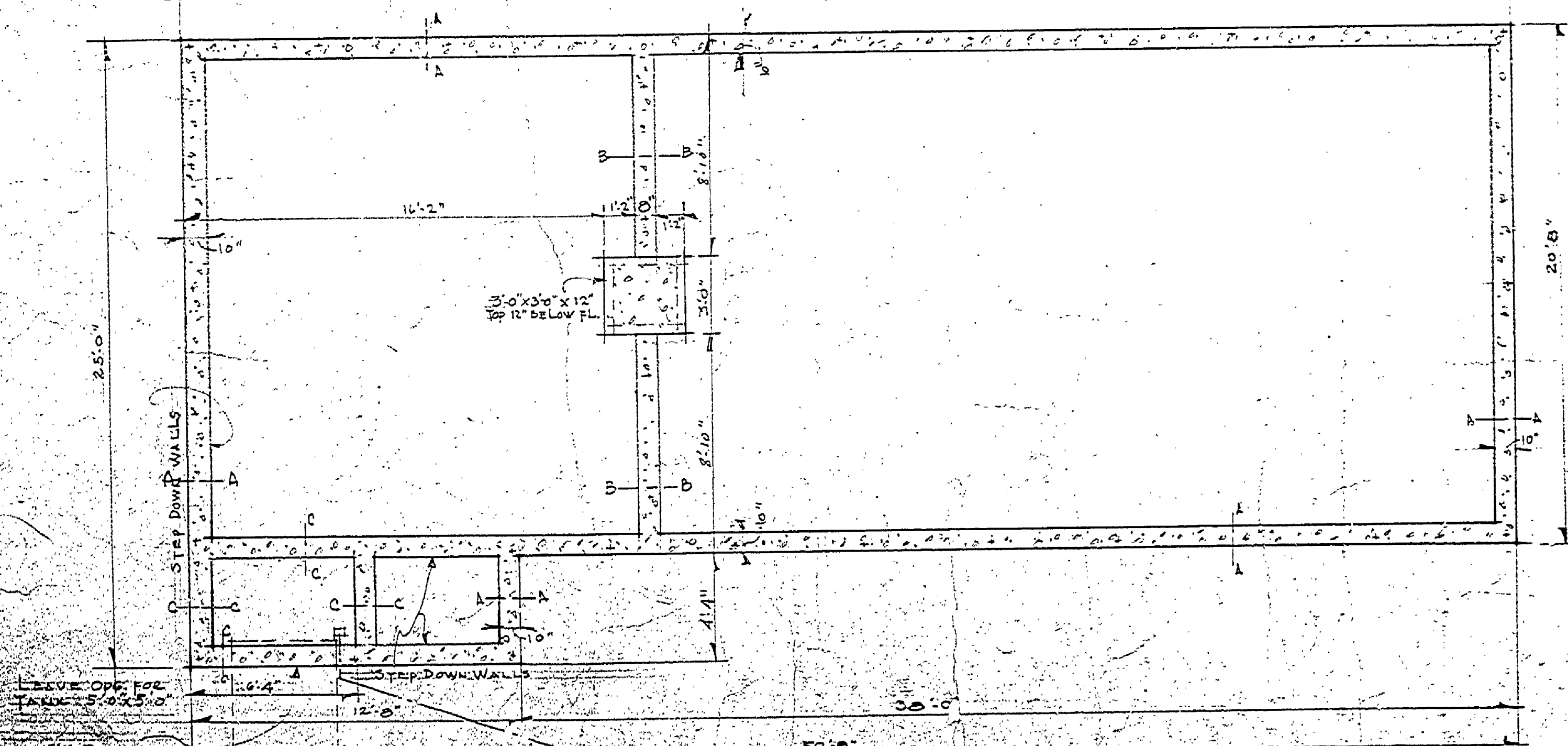
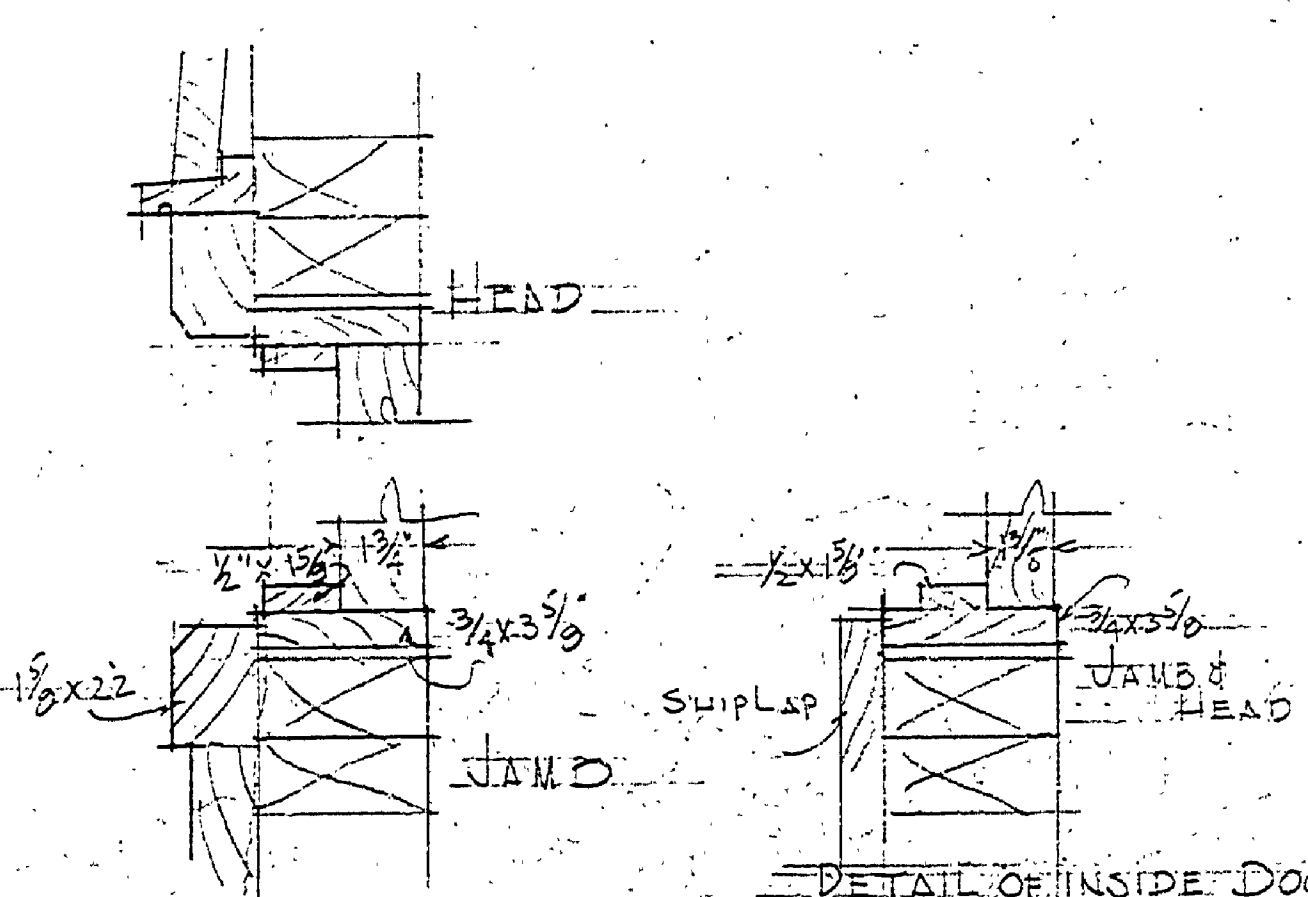

INSURANCE No. 3
A-99

U.S. DEPARTMENT OF THE INTERIOR		STATE OF MICHIGAN	
NATIONAL PARK SERVICE		GEOLOGIC CAMP # 555	
STATE PARK		PROJECT # 28-D	
EMERGENCY		GARAGE AND WORK SHOP	
CONSERVATION WORK		DATE: 11-1-54 SCALE: AS SHOWN	
DR. BY J.C. SHIPLEY		DATE: 11-1-54	
CHECKED BY	ED. ST. PETER, INSPECTOR	PROCUREMENT	W. J. HARRIS, DISTRICT OFFICER
DATE	11-1-54	APPROVED	W. J. HARRIS, DISTRICT OFFICER
RECOMMEND FOR CONSTRUCTION BY	J. C. SHIPLEY	SUBMITTED	W. J. HARRIS, DISTRICT OFFICER
DATE	11-1-54	BY	W. J. HARRIS, DISTRICT OFFICER
CONSTRUCTION	DATE	APPROVED	W. J. HARRIS, DISTRICT OFFICER
DATE	11-1-54	DISTRICT OFFICER	W. J. HARRIS, DISTRICT OFFICER