

NOTES:
 1. LOCATE SEEPAGE PLANE IN THE BANK BEFORE BEGINNING CONSTRUCTION. DRAIN SHOULD THEN BE INSTALLED TO INTERCEPT THIS PLANE AS SHOWN ON THE TYPICAL CROSS SECTION.
 2. REMOVE TREES, FENCING, AND OTHER DEBRIS DISPLACED BY THE BANK SOIL SLIDE. RESHAPE THE SLOPE SURFACE TO MEET NEW CONTOURS AS INDICATED ON THE PLAN.

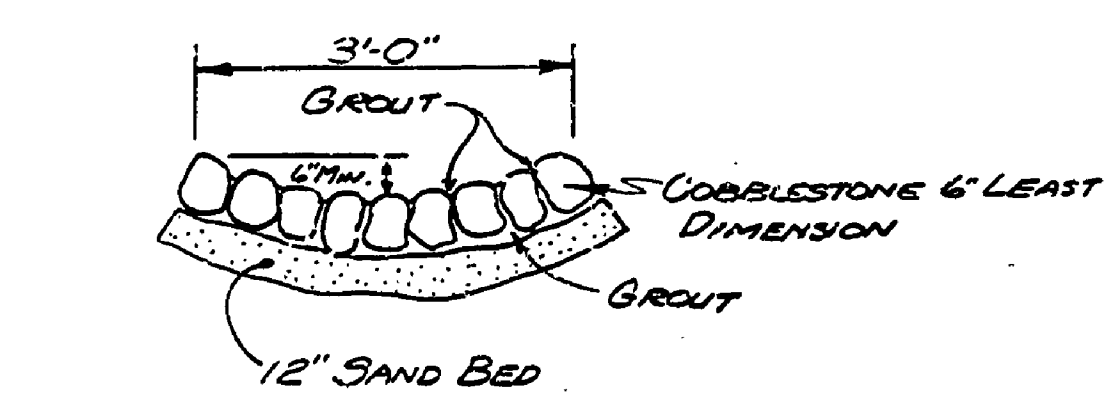

TYPICAL CROSS SECTION GROUDED COBBLE SPILLWAY

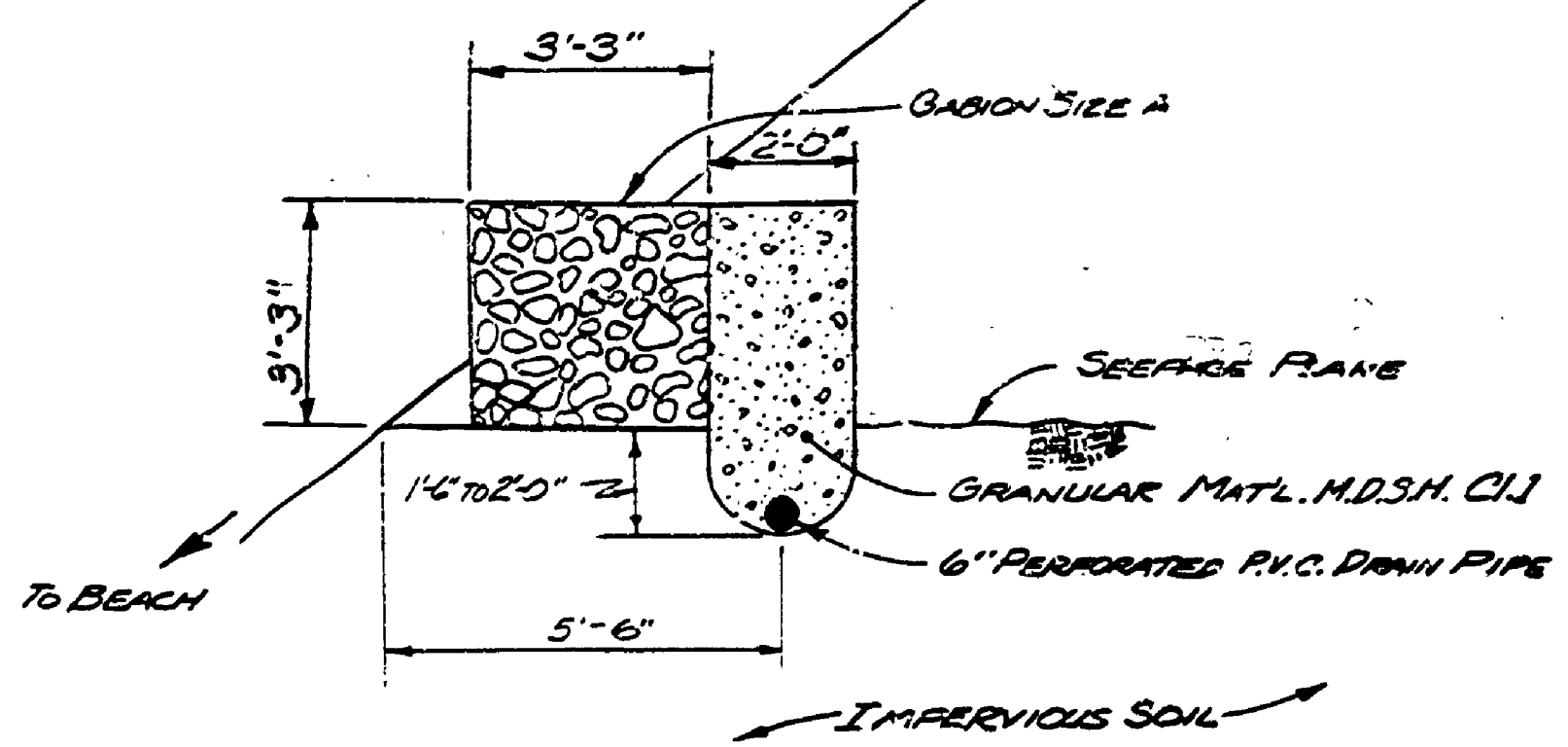

TYPICAL CROSS SECTION 3/8" = 1'-0"

ORCHARD BEACH STATE PARK
 CONSTRUCTION PLANS FOR
 BANK STABILIZATION
 PROJECT NO. 24-1142

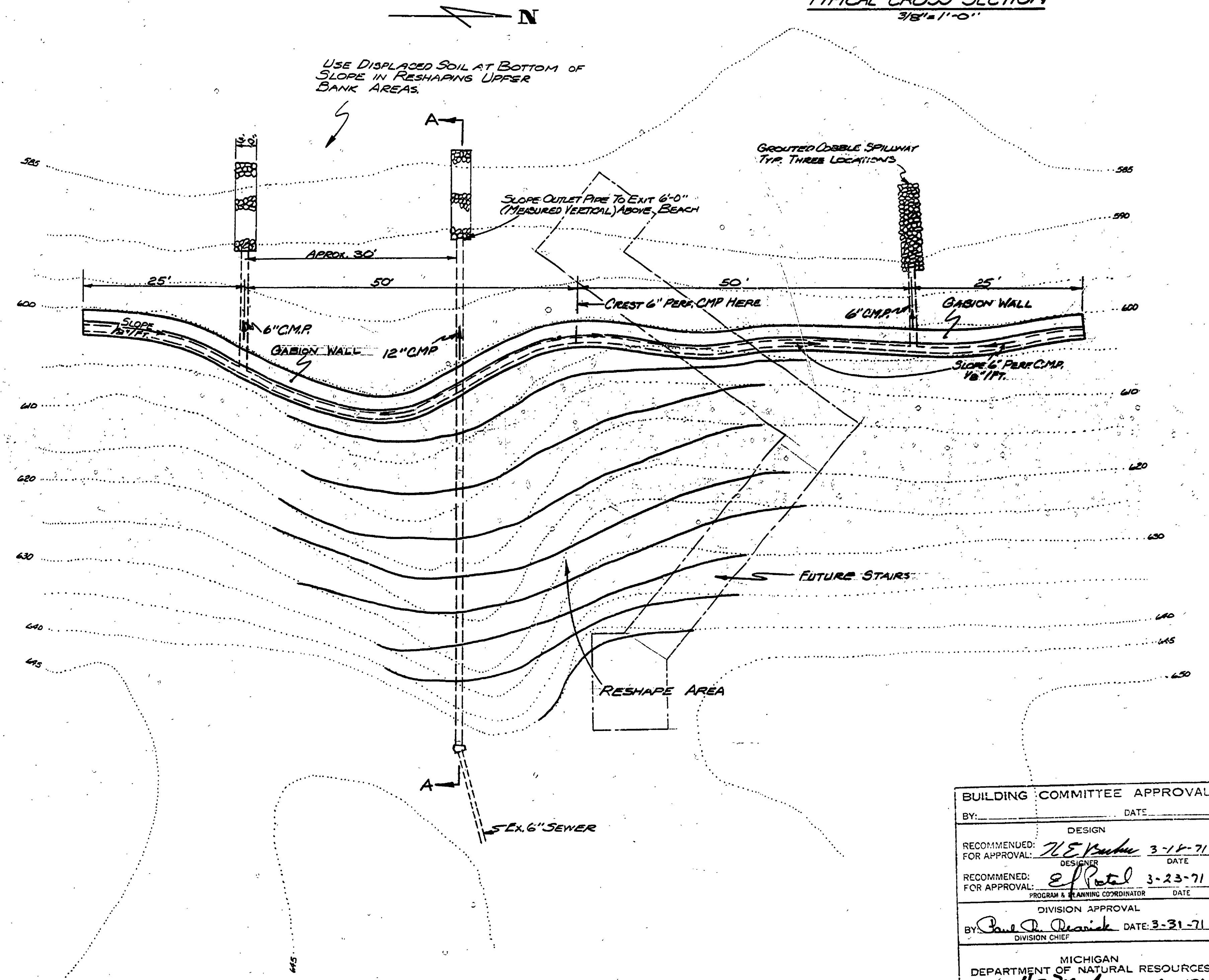

PLAN OF PROPOSED BANK DRAIN SYSTEM
 1" = 10'

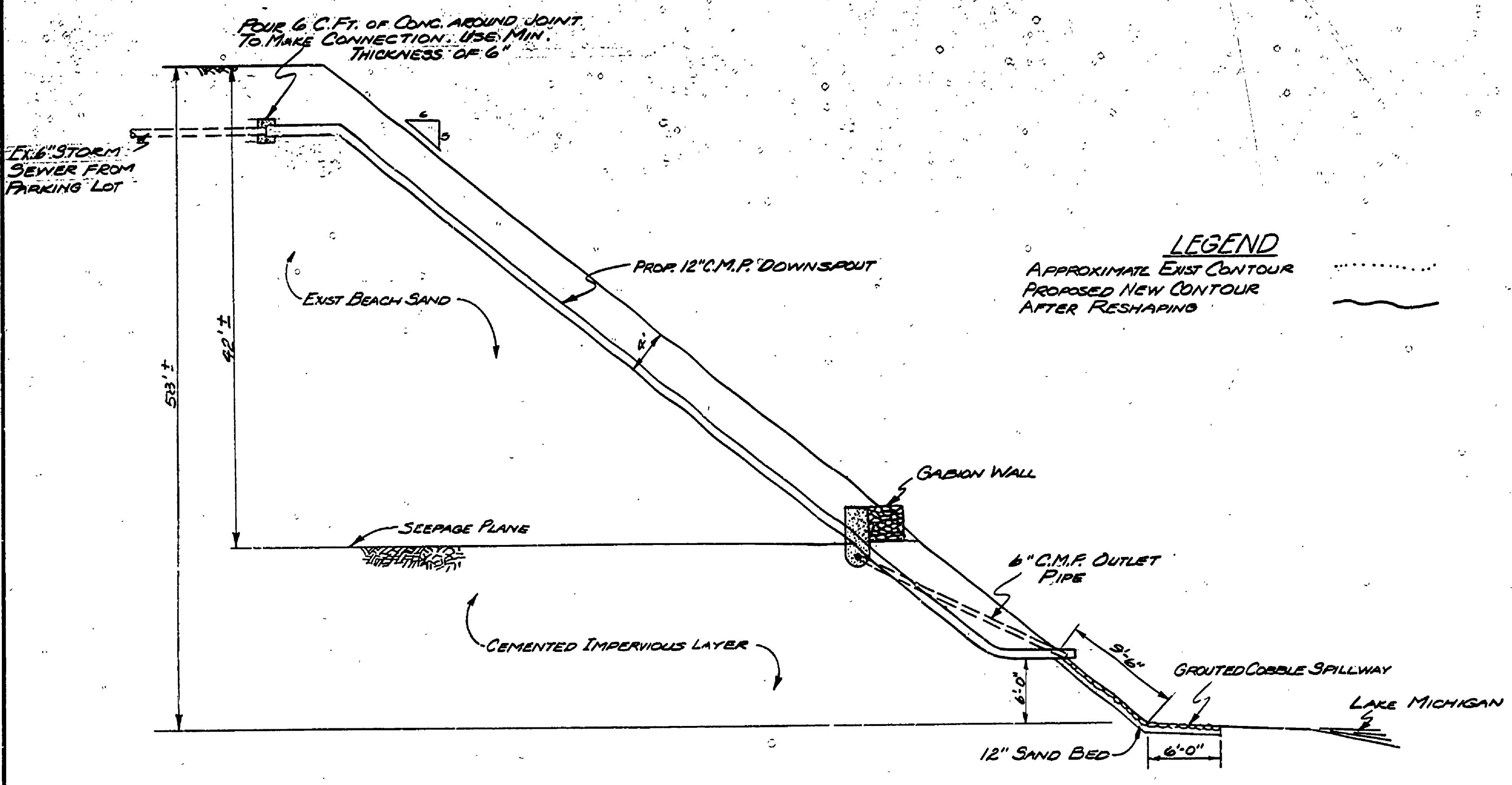

SECTION A-A
 1/8" = 1'-0"

LEGEND
 APPROXIMATE EXIST CONTOUR
 PROPOSED NEW CONTOUR
 AFTER RESHAPING

BUILDING COMMITTEE APPROVAL	
BY: _____	DATE: _____
DESIGN	
RECOMMENDED FOR APPROVAL: <i>W.S. ...</i>	DATE: 3-14-71
DESIGNER	
RECOMMENDED FOR APPROVAL: <i>E. Patel</i>	DATE: 3-23-71
PROGRAM & TRAINING COORDINATOR	
DIVISION APPROVAL	
BY: <i>Paul P. ...</i>	DATE: 3-31-71
DIVISION CHIEF	
MICHIGAN DEPARTMENT OF NATURAL RESOURCES	
APPROVED: <i>W. ...</i>	DATE: 4-2-71
CHIEF ENGINEER	
PLAN NO. _____	PROJECT NUMBER _____
_____	SHEET OF _____

SURVEYED BY _____	DRAWN BY <i>C. E. MASSEY</i>	2-71	NO. _____	DATE _____	BY _____	REVISIONS _____	NO. _____	DATE _____	BY _____	REVISIONS _____	MICHIGAN DEPARTMENT OF NATURAL RESOURCES	ORCHARD BEACH S.P.R. AREA OR PARK	PROJECT NO. <i>24-1142</i>
DESIGNED BY <i>R. HAELSNER</i>	2-71	CHECKED BY _____	DATE _____	1.	3.	2.	4.	PLAN AND DETAILS SHEET TITLE	BANK STABILIZATION	SHEET <i>1</i> OF <i>1</i>	PLAN NO. <i>E 104</i>		