

# MITCHELL STATE PARK

## CADILLAC MICHIGAN

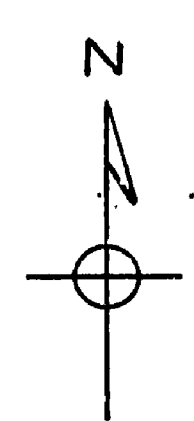

*Elevation in feet  
Old State Dept  
and confirmed with Highway Dept  
1290.1*

State Highway Dept  
B.M. #147A 18 Oak  
100' L 5th 35496  
Elev. 1290.1

B.M. - divided square SE bridge abutment  
Elev. 1306.68  
B.M. located in each outside end against head of pipe on E side of bridge (Elev. 1306.56 (J.T.R.))  
Channel connecting Lake Mitchell & Lake Cadillac

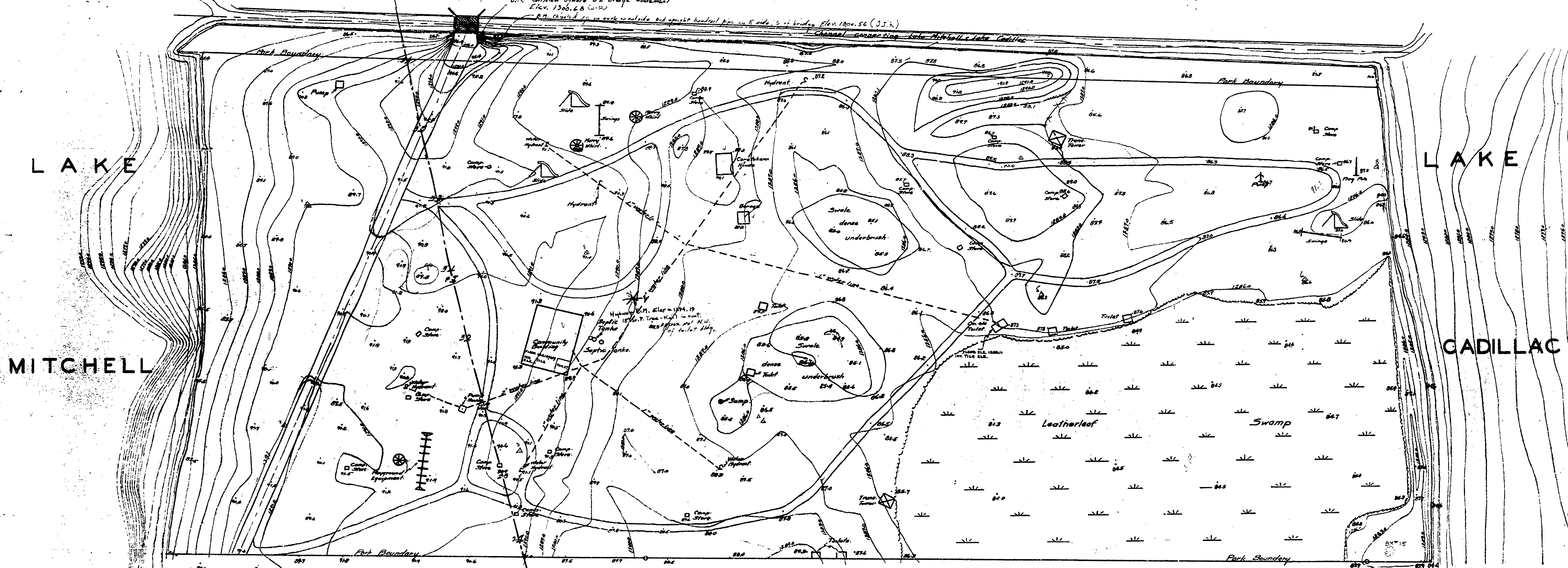

*Elev. taken by J.T.R. 8-5-55, taken from  
B.M. on bridge.  
Invert flow through Manhole at end Sewage Disposal Dist. No. 1 Elev. 1275.54  
Top of man hole Manhole cover Elev. 1275.74  
Top of 1st Box Cover Elev. 1294.27  
Top of 2nd Box Cover Manhole for Sewage Pump House & Catch Tank Elev. 1292.54*

*Note: Entire park covered with a uniform  
growth of Maple, Birch, Oak, White-  
pine, Norway - with the Maple pre-  
dominating.*

B.M. #15 Elev. 1290.01  
Established June 1925  
By B.M. 2. G. Carrock  
Datum

<b>MICHIGAN DEPARTMENT OF CONSERVATION</b>		
<b>PARKS DIVISION</b>		
Survey by <i>B. Williams</i>	<b>MITCHELL STATE PARK</b>	PLAN NO.
Date 11-3-39		SCALE 1" = 60'
Drawn by <i>B. Williams</i>		DATE
APPROVED. _____		
Division Chief - State Parks.		

R-2