

LAKE SUPERIOR

LAKE SUPERIOR

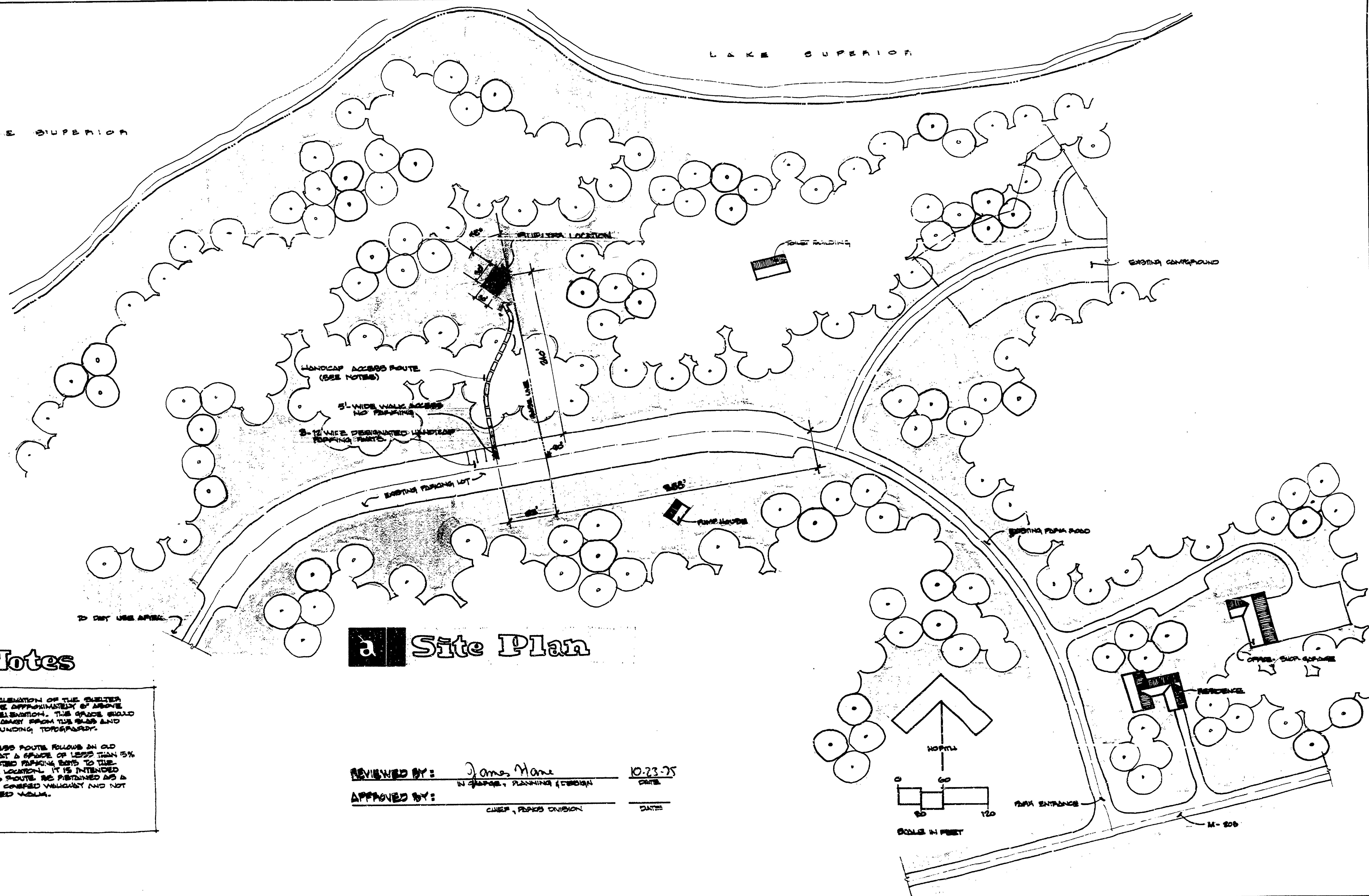

**a** Site Plan

**b** Notes

THE FINISH FLOOR ELEVATION OF THE SHELTER BUILDING SHOULD BE APPROXIMATELY 5' ABOVE EXISTING GROUND ELEVATION. THE GRADE SHOULD SLOPE GRADUALLY AWAY FROM THE BUILDING AND BLEND INTO SURROUNDING TERRAIN.

THE HANDICAP ACCESS ROUTE FOLLOWS AN OLD EXISTING ROAD BED AT A GRADE OF LESS THAN 5% FROM THE DESIGNATED PARKING SPACES TO THE PROPOSED SHELTER LOCATION. IT IS INTENDED THAT THIS ACCESS ROUTE BE MAINTAINED AS A COMPACTED GRADE COVERED WALKWAY AND NOT TO PROVIDE A PAVED WALKWAY.

REVIEWED BY: James Hane 10-23-75  
IN CHARGE, PLANNING & DESIGN DATE

APPROVED BY: \_\_\_\_\_ DATE  
CHIEF, PARKS DIVISION

SURVEYED BY	DRAWN BY <u>ALMY</u>	10/1/75	NO.	DATE	BY	REVISIONS	MICHIGAN DEPARTMENT OF NATURAL RESOURCES	<b>McLain S.P.</b>	AREA OR PARK <u>PICNIC AREA</u>	PROJECT NO.
DESIGNED BY <u>ALMY</u>	CHECKED BY		1.						<b>SHELTER BUILDING SITE PLAN</b>	SHEET <u>1</u> OF <u>1</u>
	DATE		2.						PROJECT	PLAN NO. <u>L10</u>