

WITNESSES TO SURVEY POINTS

PI 19+01.37 3/4" PIPE
N. 87° W. 8.01' 10" R. PINE SPIKE
N. 20° E. 9.61' 6" OAK SPIKE

POT 12+63.54 HUB
N. 70° W. 12.28' POWER POLE SPIKE
S. 3° W. 12.79' 1/4" OAK SPIKE

POT 5+75.83 HUB
S. 86° E. 37.21' 10" W. PINE SPIKE
S. 25° E. 46.95' 6" R. PINE SPIKE

POB ENTRANCE RD. 3/4" PIPE
N. 45° E. 14.15' 12" W. PINE SPIKE
S. 58° E. 59.33' POWER POLE @
BEND IN LINE SPIKE

BENCH MARK DATA
B.M. #11 ELEV. 628.35
PK. NUT 4" DIA. W. ROOT OF 15" W. PINE
24" LT. STA. 5+90 20' EAST POWER LINE

NOTE: PLAN GRADE IS TOP OF 6" COMPACTED GRAVEL @ E. ROAD

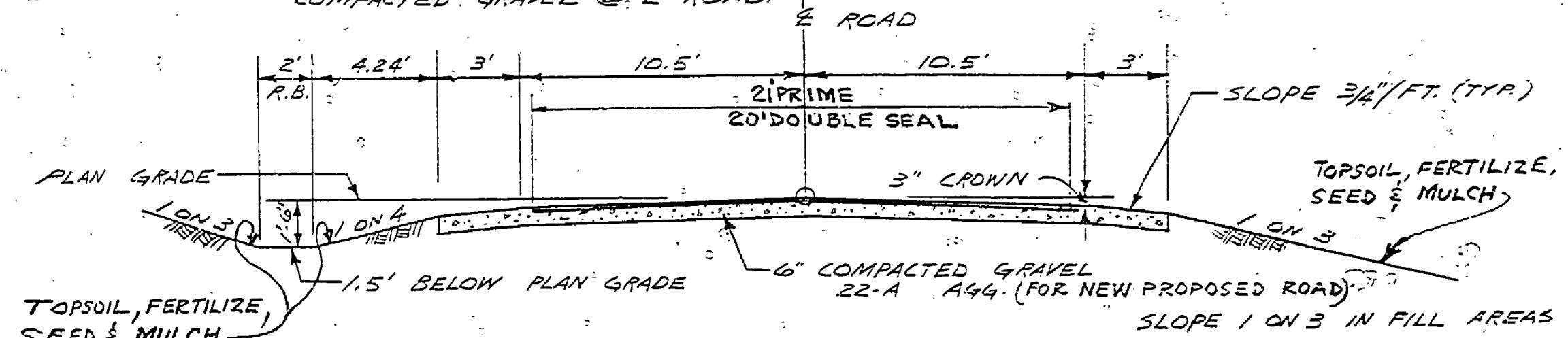

TYPICAL SECTION ENTRANCE ROAD

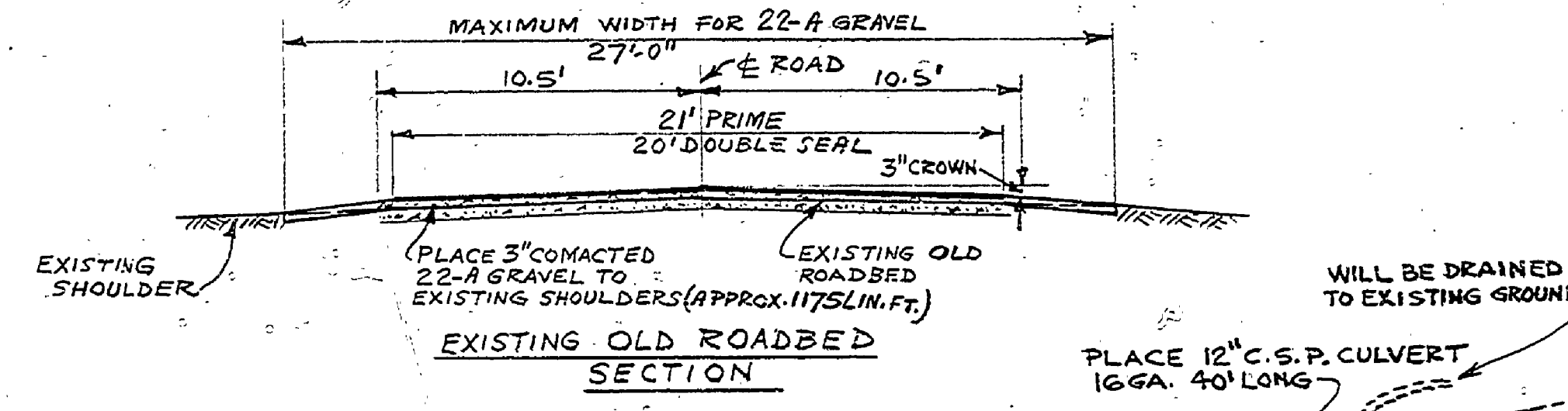

NOTE
EXISTING ROADBED TO BE UP GRADED.
USE 3" COMPACTED 22-A GRAVEL BASE
AND PRIME AND DOUBLE-SEAL
SURFACE COAT APPROXIMATELY FITS
(SEE EXISTING OLD ROADBED SECTION)

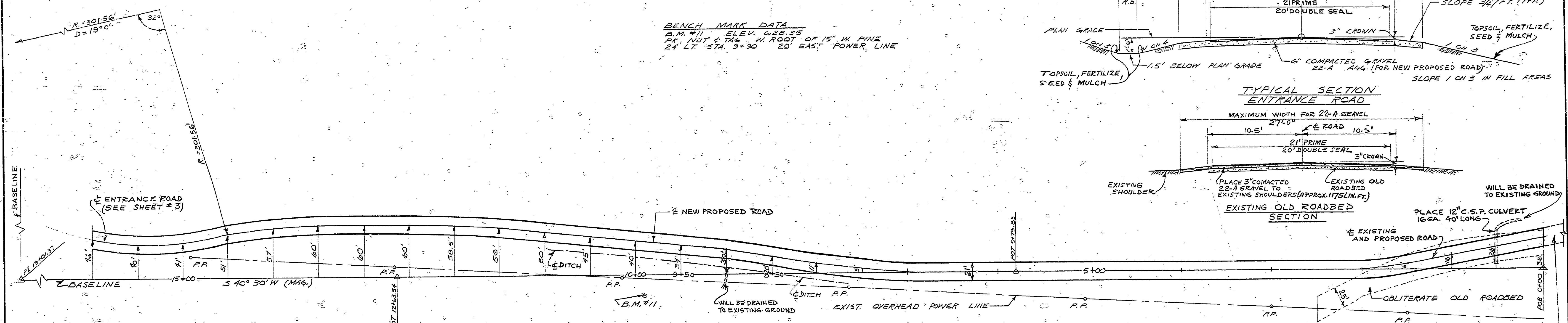

PLAN
SCALE: 1"=50'

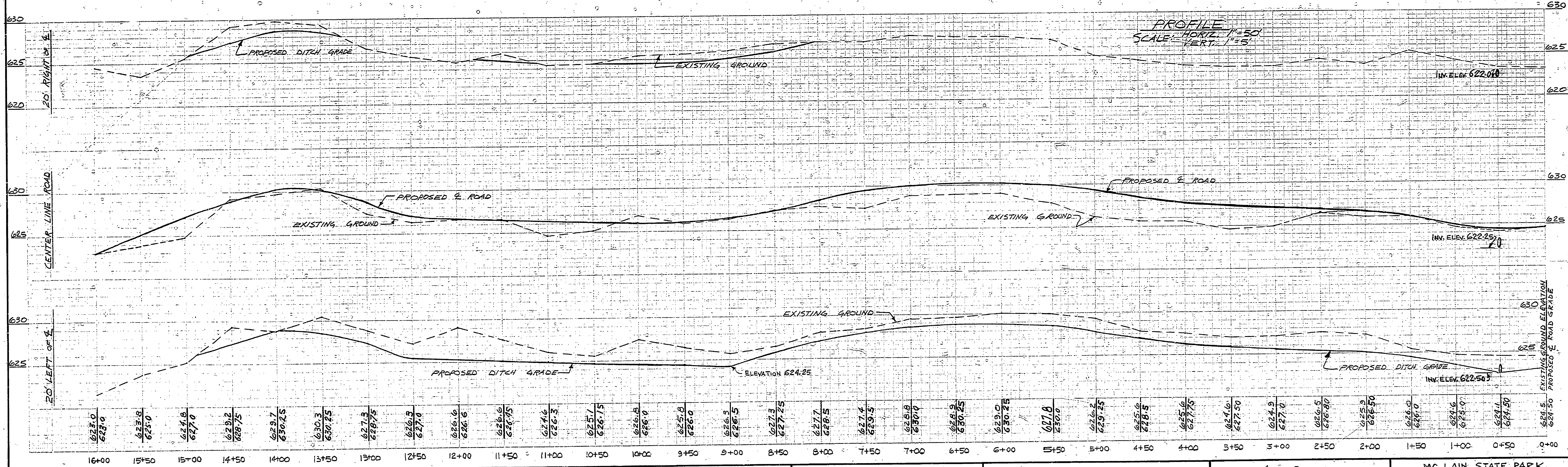

SURVEYED BY D. BISSELL	5-70	DRAWN BY B. BOYCE	10-70	NO. 1	DATE	BY	REVISIONS	NO. 2	DATE	BY	REVISIONS	MICHIGAN DEPARTMENT OF CONSERVATION	ENTRANCE ROAD PLAN & PROFILE	SHEET NO. 4 OF 8	MC LAIN STATE PARK DAY-USE EXTENSION
DESIGNED BY A. PETRANCIUS	10-70	CHECKED BY		1.				2.						FOR PROJECT NO. 24-1090	PLAN NO. E-109
DATE		DATE		3.				4.							