

**BENCH MARK DATA**  
 B.M. # 12 ELEV. 621.49  
 PK, NUT & TAG IN N. ROOT OF 16" W. PINE 25' N.  
 OF E. ROAD OF MOUTH OF PORTAGE RIVER, ABOUT  
 300' EAST OF RIVER BANK.

B.M. # 12 ELEV. 621.49  
 PK, NUT & TAG IN N.E. ROOT 12" OAK 5' RT.  
 STA. 6+06 PARKING LOT BASELINE.

B.M. # 4.S.B. ELEV. 629.97  
 AT INTERSECTION OF 5 ROADS 200' N.W.  
 OF CANAL COUNTRY STORE BESIDE STOP  
 SIGN SMALL HOLE IN SQUARE STONE SCRIBED U.S.B.

**WITNESSES TO SURVEY POINTS**

- P.O.B. @ STA. 0+00. PARKING LOT BASELINE 5/8" PIPE  
 S 82° W, 30.32', 10" R. PINE, SPIKE  
 S 23° E, 88.69', 10" W. PINE, PK, NUT & TAG, (B.M. # 12)
- P.O.T. 2+46.13 5/8" PIPE  
 N 56° E, 11.60', 11" R. PINE, SPIKE  
 N 41° W, 12.76', 9" R. PINE, SPIKE
- P.O.T. 10+64.97 5/8" PIPE  
 S 10° E, 19.56', 9" OAK, SPIKE.  
 S 28° W, 39.09', 15" R. PINE, SPIKE.
- P.O.E. 11+99.70 5/8" PIPE  
 N 70° W, 38.71', TWIN 2-5", 3" W. BIRCH, SPIKE  
 N 50° E, 76.75', 6" OAK, SPIKE
- P.I. 19+01.37 3/4" PIPE  
 N 87° W, 3.01', 10" R. PINE, SPIKE  
 N 20° E, 9.61', 6" OAK, SPIKE
- K.O.T. 22+13.21 HUB  
 S 39° W, 63.02', 6" & 8" TWIN W. PINE, SPIKE  
 N 68° E, 54.00', 8" R. PINE, SPIKE
- P.O.E. 24+31.07 5/8" PIPE  
 N 61° E, 6.45', 12" OAK, SPIKE (B.M. # 12)  
 N 47° W, 24.79', 8" W. BIRCH, SPIKE.

CODE	RADIUS	CURBING	REQ.
Q		DRAINAGE 8"	22.6
T		STANDARD 6"	2.2
C		50" R. DEVELOPED ENDS	1.8
D	45' R	" 8"	2.6
E	40' R	" 8"	7
F	30' R	" 8"	3.0
H	20' R	" 8"	1.2
S		5" R. CORNER	2
R		SHOE BLOCK	2

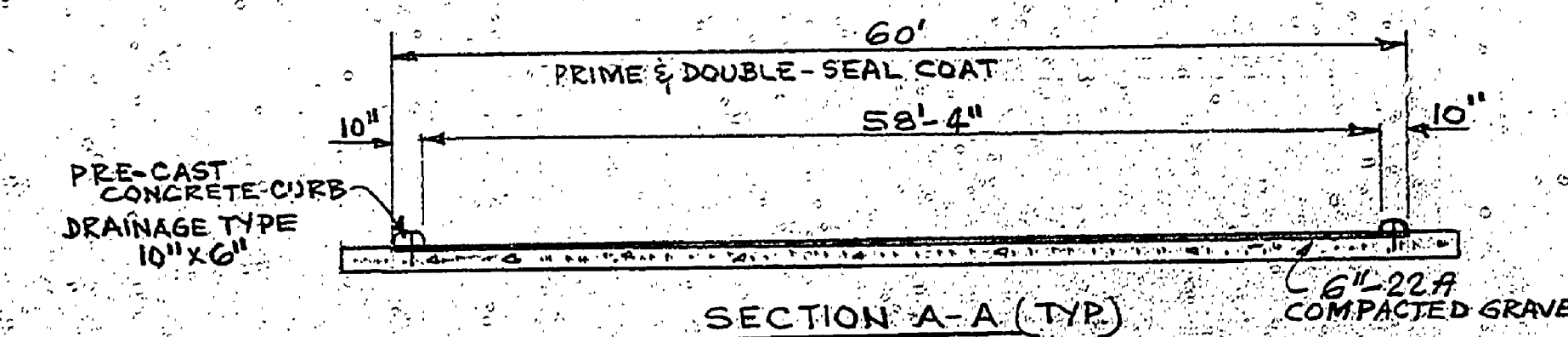
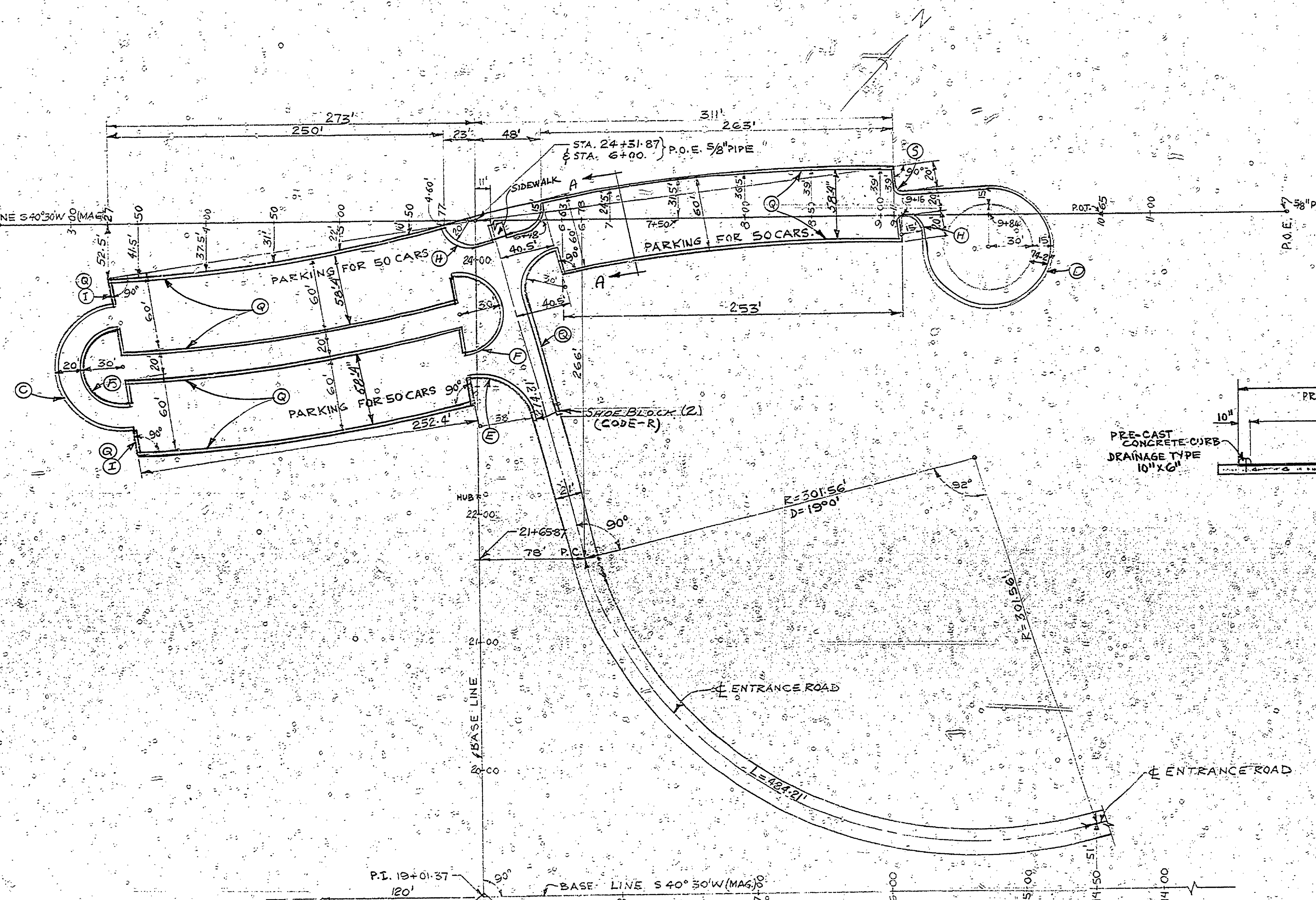

**PLAN**  
 SCALE: 1"=50'

**LEGEND**  
 [Symbol] EXISTING ROAD & PARKING  
 [Symbol] PROPOSED PRE-CAST DRAINAGE TYPE CONCRETE CURBS

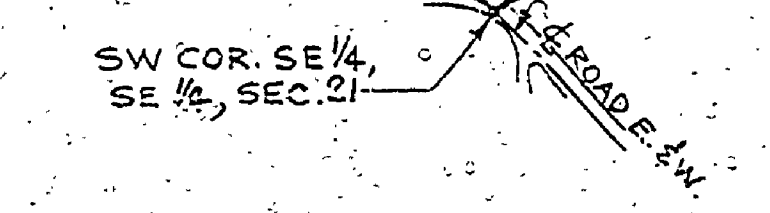

<b>BUILDING COMMITTEE APPROVAL</b>	
BY: _____	DATE: _____
DESIGN RECOMMENDED FOR APPROVAL: <i>W.E. Parker</i> 2-29-72 DESIGNER: _____ DATE: _____	
FOR APPROVAL: <i>S.J. Porecki</i> 2-27-72 PROGRAM & PLANNING COORDINATOR: _____ DATE: _____	
DIVISION APPROVAL BY: _____ DATE: 7-8-72 DIVISION CHIEF: _____	
MICHIGAN DEPARTMENT OF NATURAL RESOURCES APPROVED: <i>A. MacLean</i> 2-27-72 CHIEF ENGINEER: _____ DATE: _____	
PLAN NO. _____	PROJECT NUMBER _____
PROJECT: MC LAIN STATE PARK DAY USE EXTENSION	
PROJECT NO. 24-1105	
SHEET 7 OF 1	PLAN NO. E-110

SURVEYED BY	DATE	DRAWN BY	DATE	CHECKED BY	DATE	NO.	DATE	BY	REVISIONS
D. BISSELL	5-70	A. PETRACIVICUS	10-70			1.	3-71	G.M.	ADDED CURBING
A. PETRACIVICUS	8-70					2.			

MICHIGAN DEPARTMENT OF NATURAL RESOURCES	PRE-CAST CONCRETE CURBING	MC LAIN STATE PARK
	SHEET TITLE	AREA OR PARK
		PROJECT