

DESIGNED BY	JACK A. DREW ASSOC., INC.	LAITALA & NUCHESTERLEIN ASSOC., INC.	BOLTON & HELVESTON ENGINEERS	INDIAN LAKE STATE PARK	SCALE	MICHIGAN DEPARTMENT OF CONSERVATION	GRADING PLAN	SHEET NO. 10	PLAN NO. 1056
DRAWN BY	LANDSCAPE ARCHITECTS	ARCHITECTS	CONSULTING ENGINEERS	WEST SHORE SECTION	1" = 50' - 0"	PARKS AND RECREATION DIVISION	NORTH CAMP CLUSTER	OF 24	
CHECKED BY	LANSING MICHIGAN	LANSING, MICHIGAN	LANSING MICHIGAN						
DATE	REVIEWED	DATE	APPROVED	DATE NO. DATE BY	REVISIONS	DATE BY			
	ARCHITECTURAL			1					
	ENGINEERING			2					
	LANDSCAPE			3					
					4				
					5				
					6				

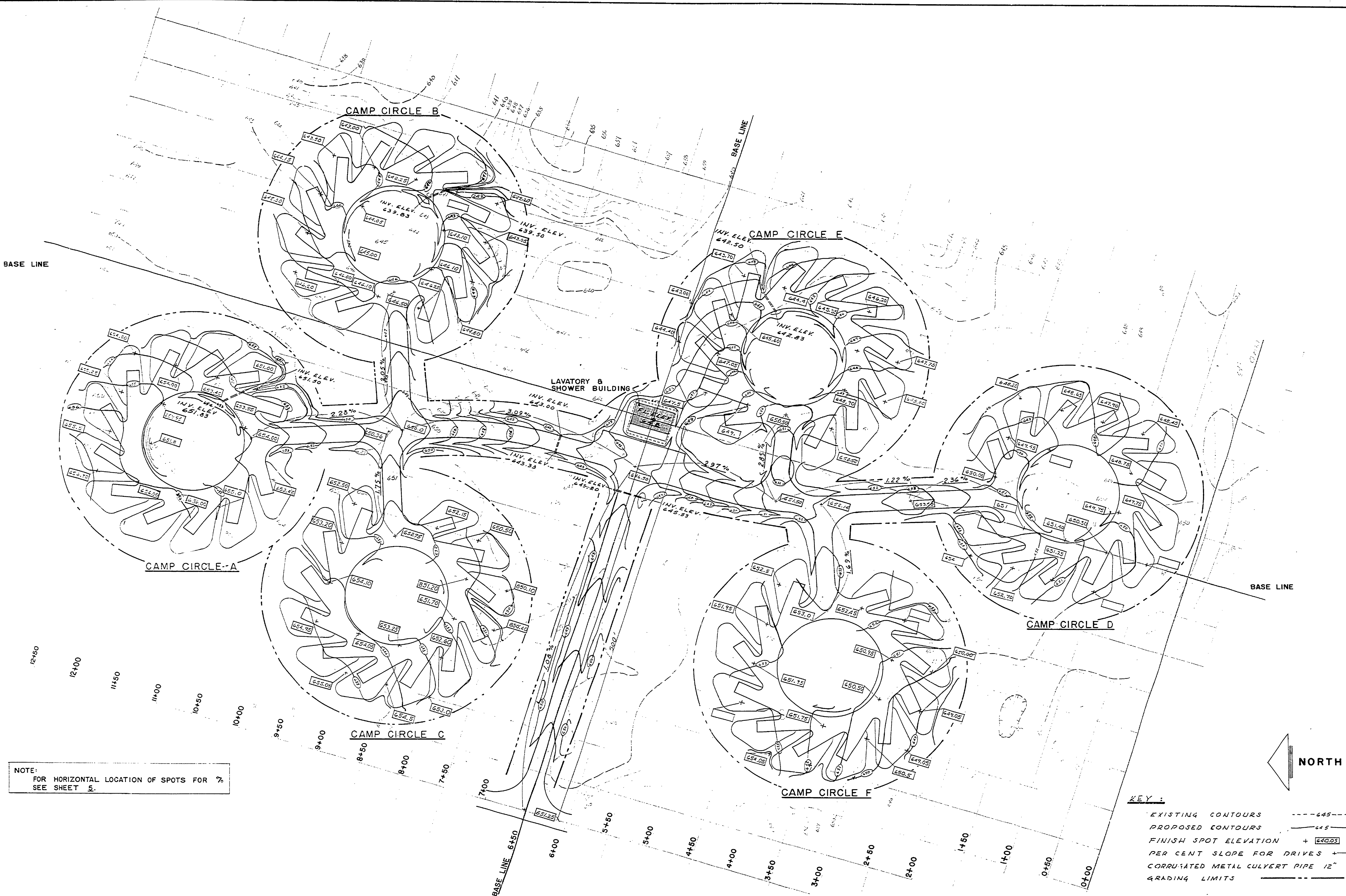

NOTE:  
FOR HORIZONTAL LOCATION OF SPOTS FOR %  
SEE SHEET 5.

KEY:  
 EXISTING CONTOURS ---  
 PROPOSED CONTOURS ———  
 FINISH SPOT ELEVATION + 640.00  
 PER CENT SLOPE FOR DRIVES 1.00 %  
 CORRUGATED METAL CULVERT PIPE 12" ==  
 GRADING LIMITS . . . . .