

REVISIONS	DATE	BY
4		
5		
6		

APPROVED	DATE	NO.	DATE	BY
		1		
		2		
		3		

DESIGNED BY	DATE	REVIEWED
JACK F.A. DREW ASSOC., INC.		ARCHITECTURAL
LANDSCAPE ARCHITECTS		ENGINEERING
LANSING, MICHIGAN		LANDSCAPE

DESIGNED BY	DATE	REVIEWED
LAITALA & NUENCHTERLEIN ASSOC., INC.		ARCHITECTS
ARCHITECTS		
LANSING, MICHIGAN		

DESIGNED BY	DATE	REVIEWED
BOLTON & HELVESTON ENGINEERS		ENGINEERS
CONSULTING ENGINEERS		
LANSING, MICHIGAN		

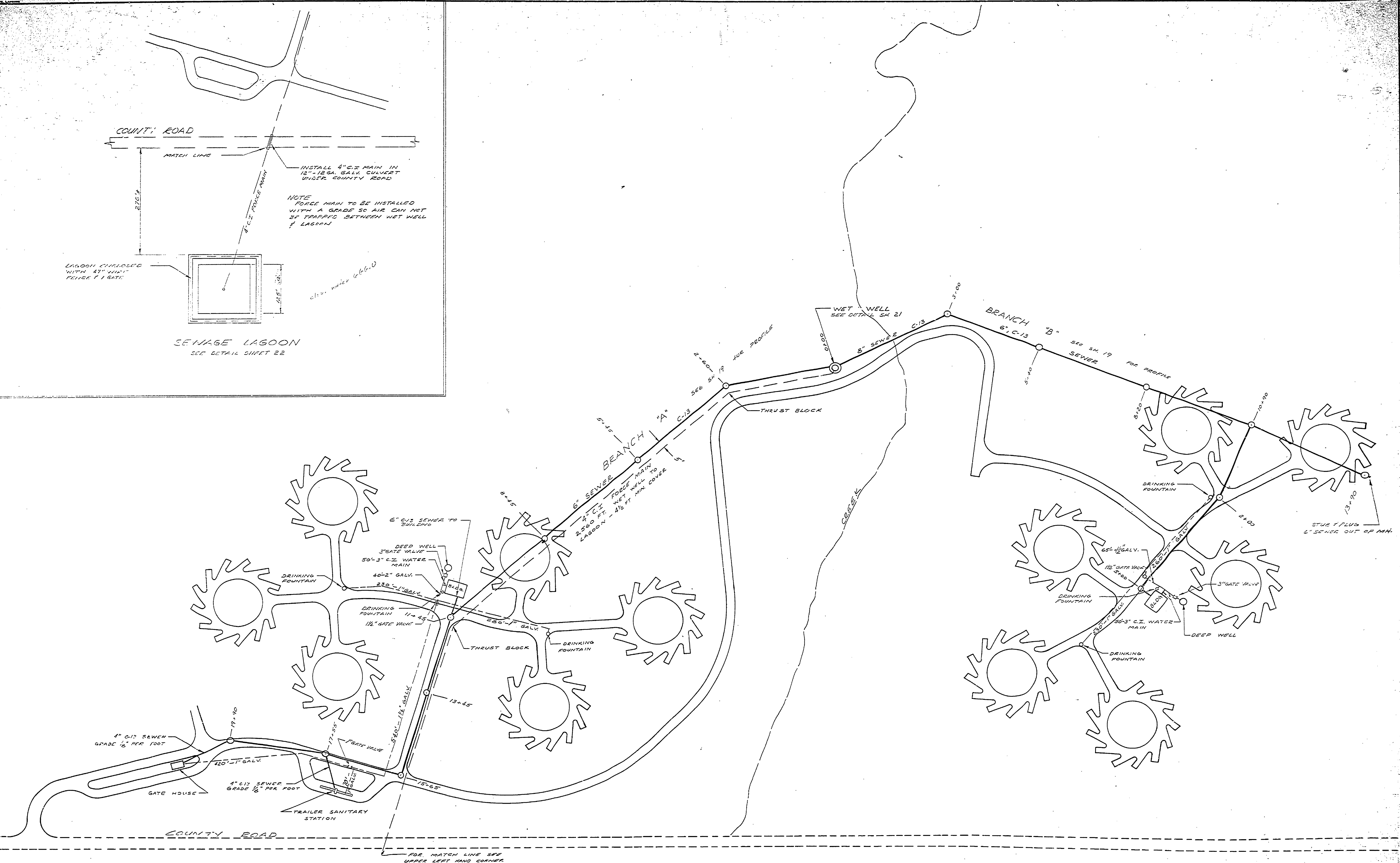

JACK F.A. DREW ASSOC., INC. LANDSCAPE ARCHITECTS LANSING, MICHIGAN  
 LAITALA & NUENCHTERLEIN ASSOC., INC. ARCHITECTS LANSING, MICHIGAN  
 BOLTON & HELVESTON ENGINEERS CONSULTING ENGINEERS LANSING, MICHIGAN  
**INDIAN LAKE STATE PARK WEST SHORE SECTION**  
**SCALE 1" = 100' - 0"**  
 MICHIGAN DEPARTMENT OF CONSERVATION PARKS AND RECREATION DIVISION  
**MECHANICAL UTILITIES**  
 SHEET NO. 18 OF 24  
 PLAN NO. 1056  
 PRG7-258-300-003-C2

E-116