

NO.	DATE	BY	REVISIONS
1	11-11	J.P.F.	1
2			2
3			3
4			4
5			5
6			6

DRAWN BY: J.W.F.
 CHECKED BY: J.W.F.
 DATE: 12-11-47

REVIEWED BY SECTIONS:
 ARCHITECTURAL: J.W.F.
 ENGINEERING: H.C.H.
 LANDSCAPE: J.J.R.

APPROVED BY: *[Signature]*
 CHIEF IN CHARGE: *[Signature]*
 OF DESIGN: DATE: 12-12-47

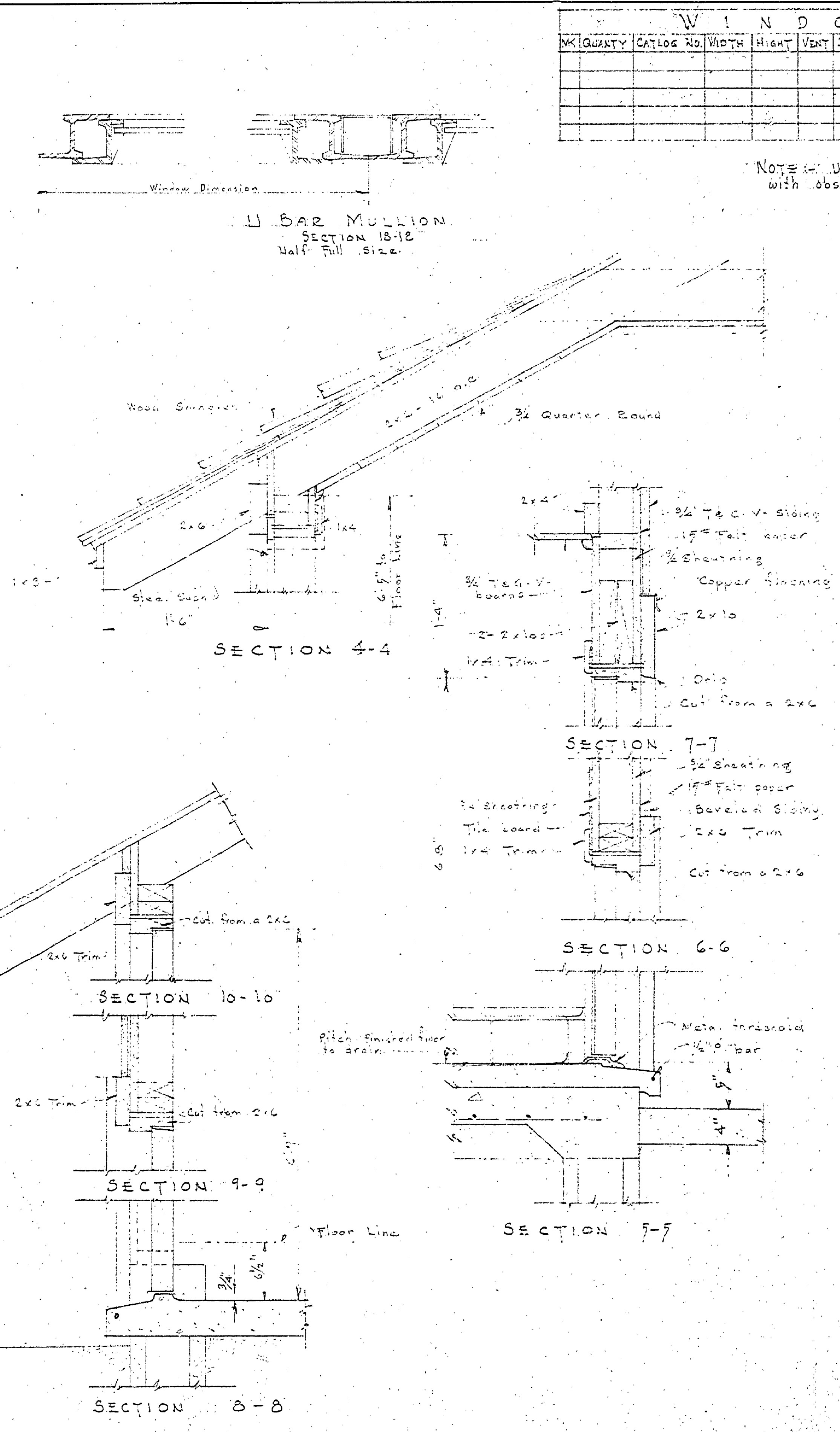
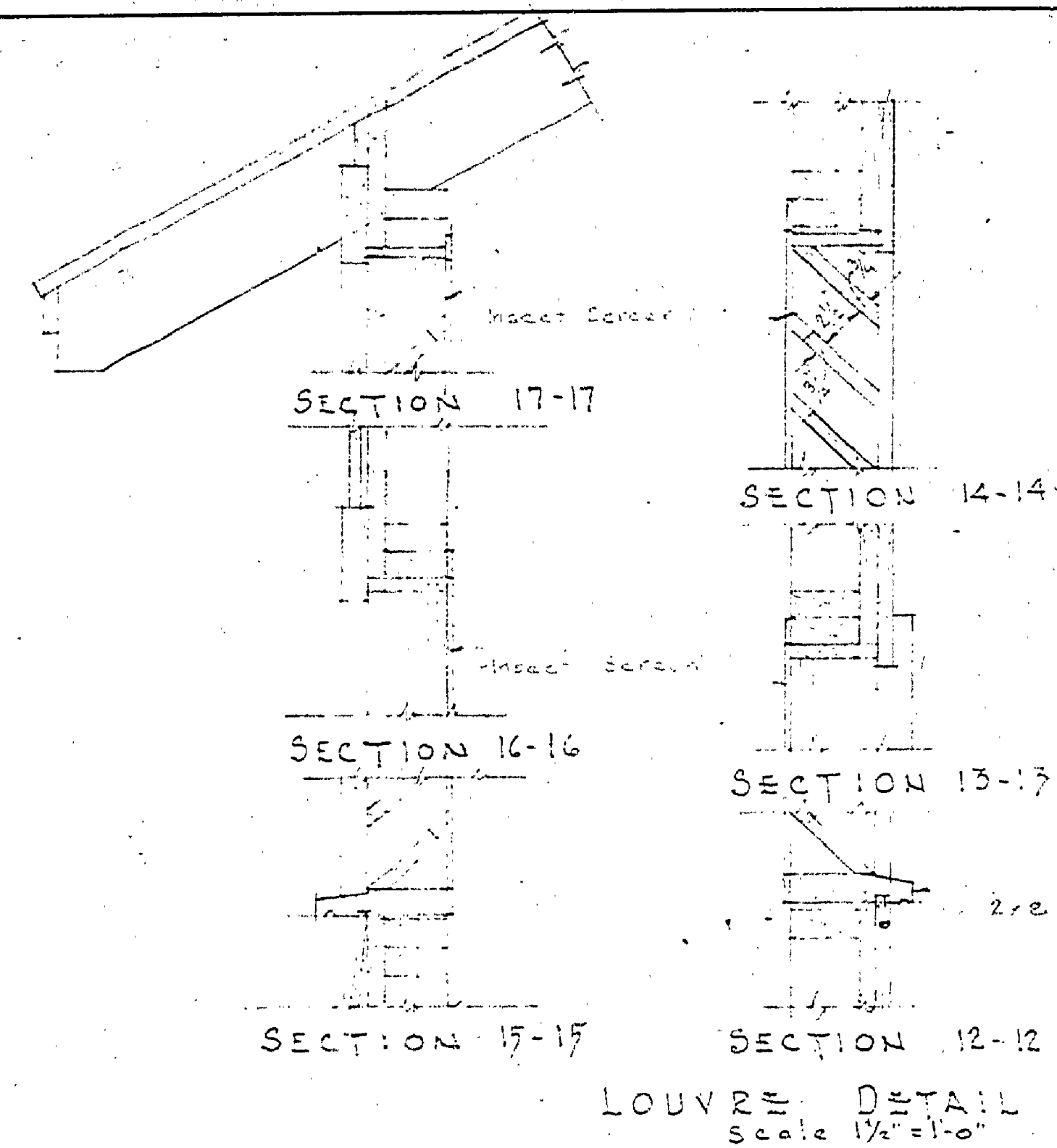
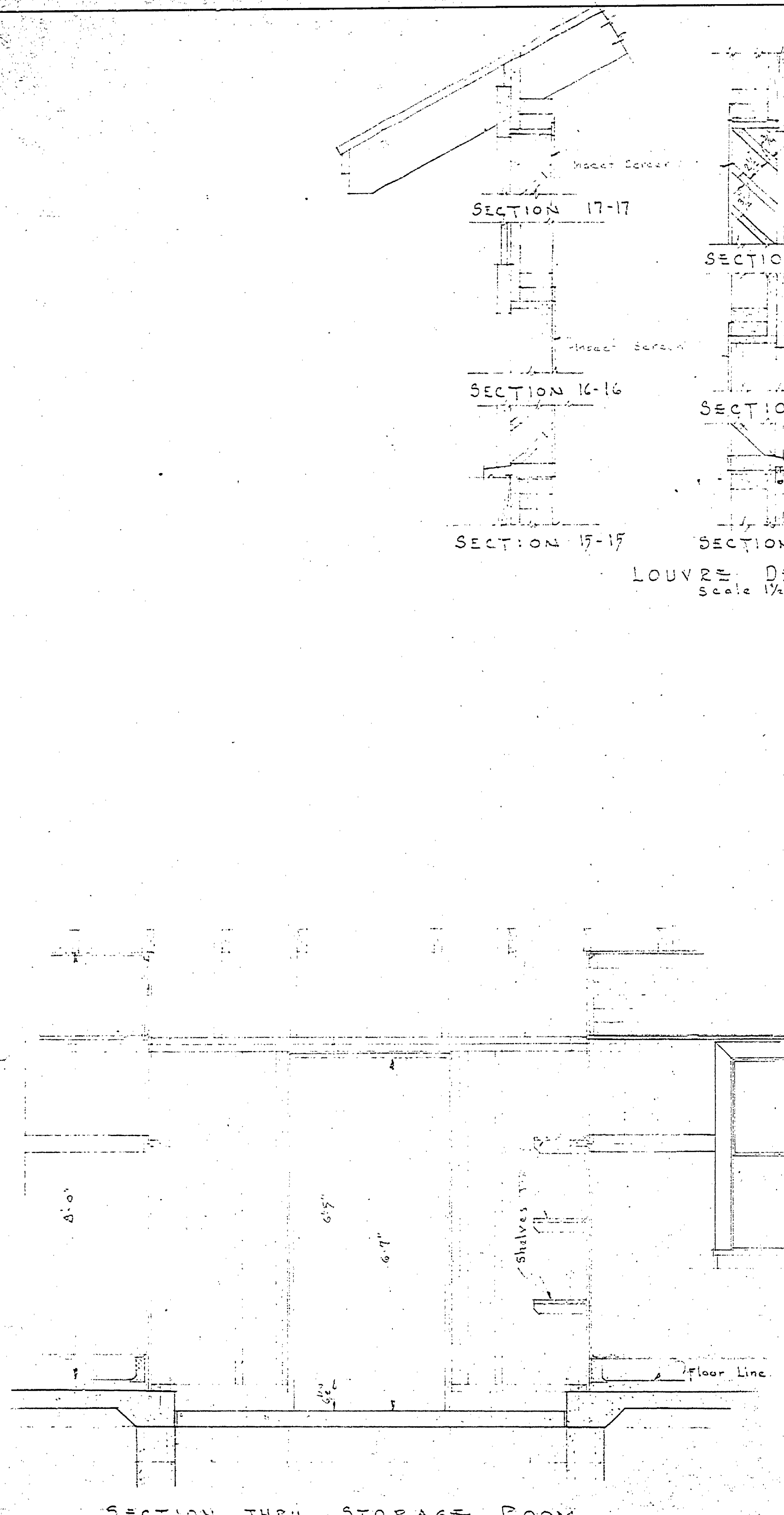

WINDOW SCHEDULE									
NO.	QUANTITY	CATALOG NO.	WIDTH	HEIGHT	VENT	SCREEN	MULLION	REMARKS	

NOTE: Utility Windows (3'-1 1/2" x 3'-4 1/2") with obscure glass through out.

