

NO.	DATE	BY	REVISIONS
1	8-28-68	RM	Final contract parking area
2	11-68	RM	BITUMINOUS SURFACING
3			
4			
5			
6			

REVIEWED BY SECTIONS	DATE	APPROVED BY
ARCHITECTURAL	3-1-67	ASSISTANT CHIEF IN CHARGE
ENGINEERING	3-1-67	OF DESIGN
LANDSCAPE	3-1-67	

DATE	CHECKED BY	TRACED BY	DRAWN BY
4-15-57			L.M.C.

BM #25 Elev. 589.94  
M.S.H.D. Tag in N. roof of  
15" W. Pine 109' Rt. of  
Sta. 178+21

TRAVERSE CITY STATE PARK  
GRAND TRAVERSE CO.

BITUMINOUS SURFACING - BEACH  
PARKING LOT

PROJECT NO. PA 108-5124-300-053-C4

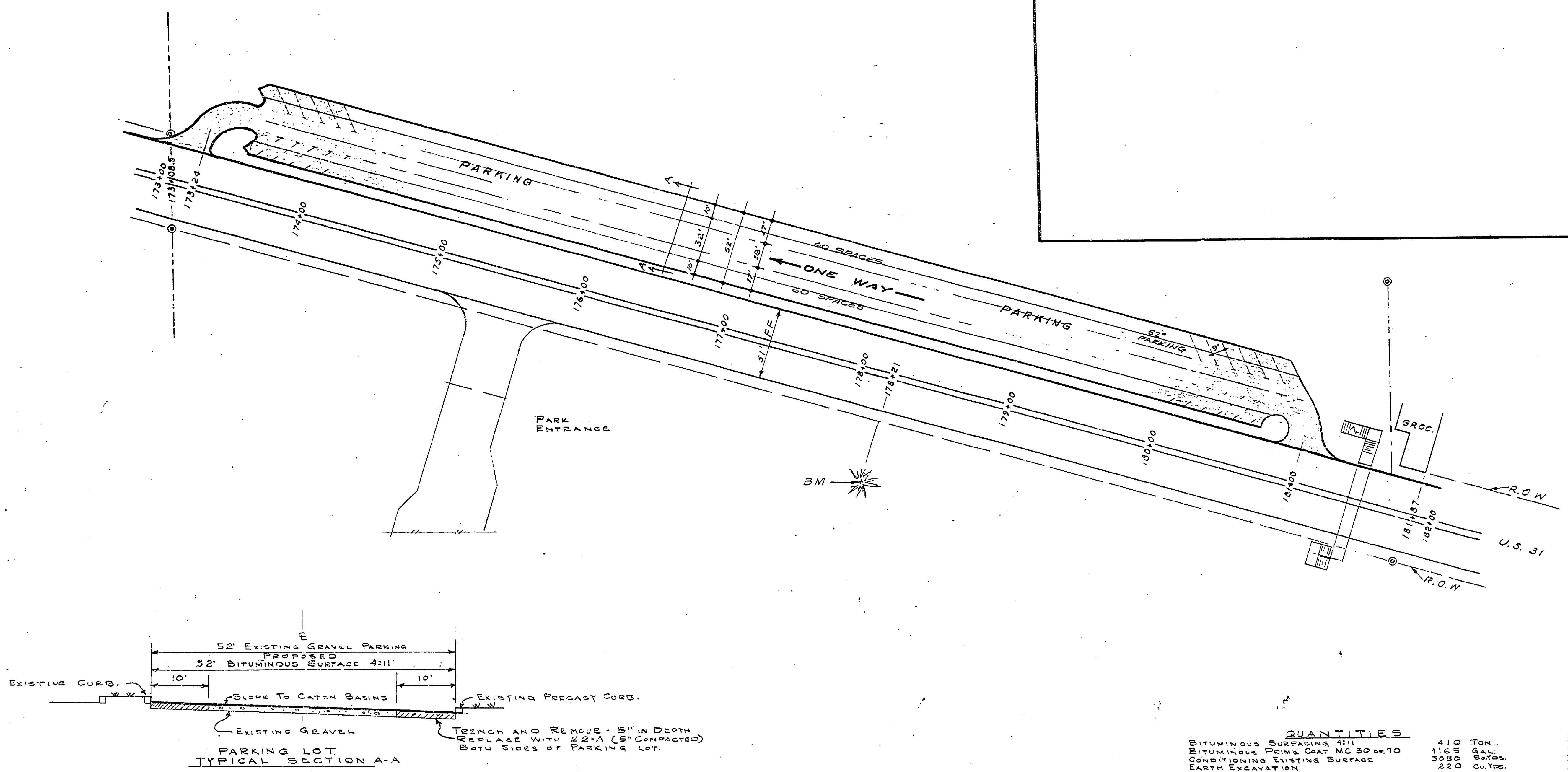

QUANTITIES	
BITUMINOUS SURFACING 4:11	410 TON.
BITUMINOUS PRIME COAT NO 30 @ 70	1165 GAL.
CONDITIONING EXISTING SURFACE	3050 Sq.Yds.
EARTH EXCAVATION	220 Cu.Yds.
22-A GRAVEL (5" COMPACTED)	1600 Sq.Yds.

DESIGN  
RECOMMENDED: *W.E. Parker 6/19/68*  
FOR APPROVAL: *W.E. Parker 6/19/68*  
DESIGNER: *W.E. Parker* DATE: *6-19-68*  
RECOMMENDED: *S.J. P... 6-19-68*  
FOR APPROVAL: *S.J. P... 6-19-68*  
IN CHARGE OF DESIGN: *S.J. P...* DATE: *6-19-68*  
DIVISION APPROVAL  
BY: *R. O. D...* DIVISION CHIEF DATE: *6-24-68*

MICHIGAN  
DEPARTMENT OF CONSERVATION  
APPROVED: *H.E. M... 6-24-68*  
CHIEF ENGINEER DATE: *6-24-68*

PLAN NO.	PROJECT NUMBER	SHEET
		NO. OF

SCALE - 1" = 40'

MICHIGAN  
DEPARTMENT OF CONSERVATION  
PARKS AND RECREATION DIVISION

TRAVERSE CITY STATE PARK  
BEACH PARKING AREA  
BITUMINOUS SURFACING

PLAN NO. E-105  
SHEET NO. OF