

REVISIONS	NO.	DATE	BY
	1		
	2		
	3		
	4		
	5		
	6		

ADDITIONAL FOR CONSTN. AT BAY CITY STATE PARK
 Construction plans will be made from this Architectural design.
 This building will be lengthened sufficient for two additional water closets for each the men and womens sides.

COMMISSION ADVL. *J.P. Reilly* DATE 1-0-52
 CHIEF PARKS & RECR. DIV. *Richard Glaser* DATE 10/10/51

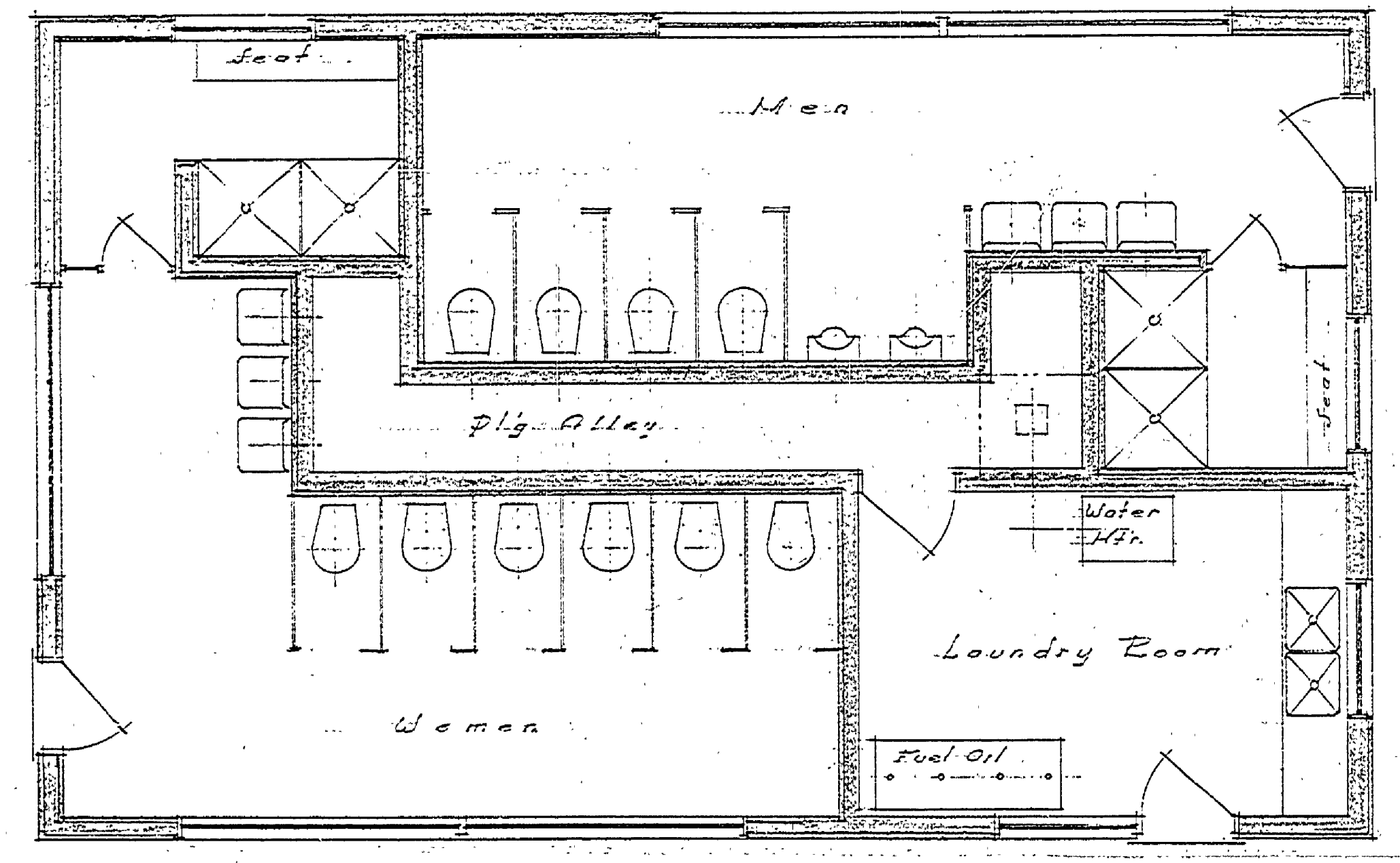

— FLOOR PLAN —
 — Scale 1/4" = 1' —

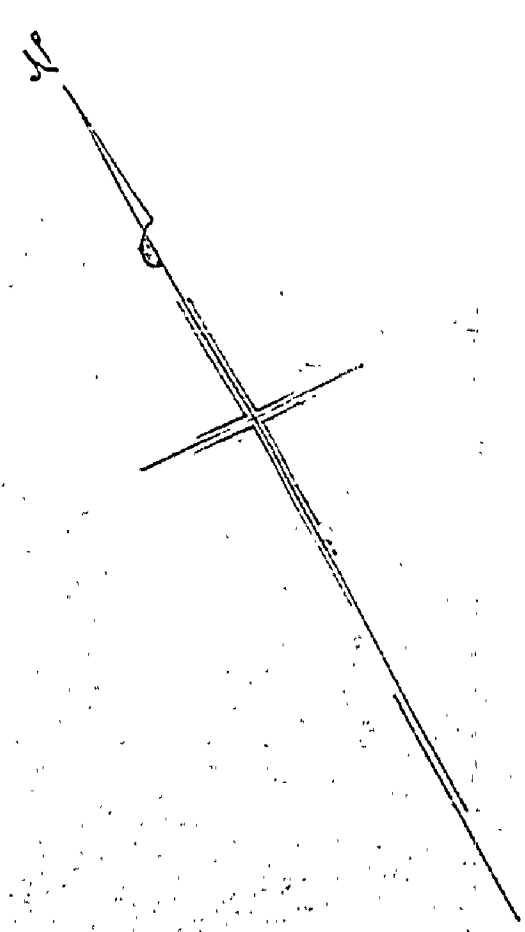

ADVL. FOR CONSTN. AT BAY CITY STATE PARK
 COMMISSION ADVL. *J.P. Reilly* DATE 2-18-52
 CHIEF, PARKS & RECR. DIV. *Richard Glaser* DATE 2/10/51
 Designed 1-5-52 JDC

MICHIGAN
 DEPARTMENT OF CONSERVATION
 PARKS AND RECREATION DIVISION

SHEET NO. 109 OF 109
 PLAN NO. A-109