

NOTE: All tile to be laid with one-quarter inch (1/4) joints. Joints to be covered with tarred paper as shown.

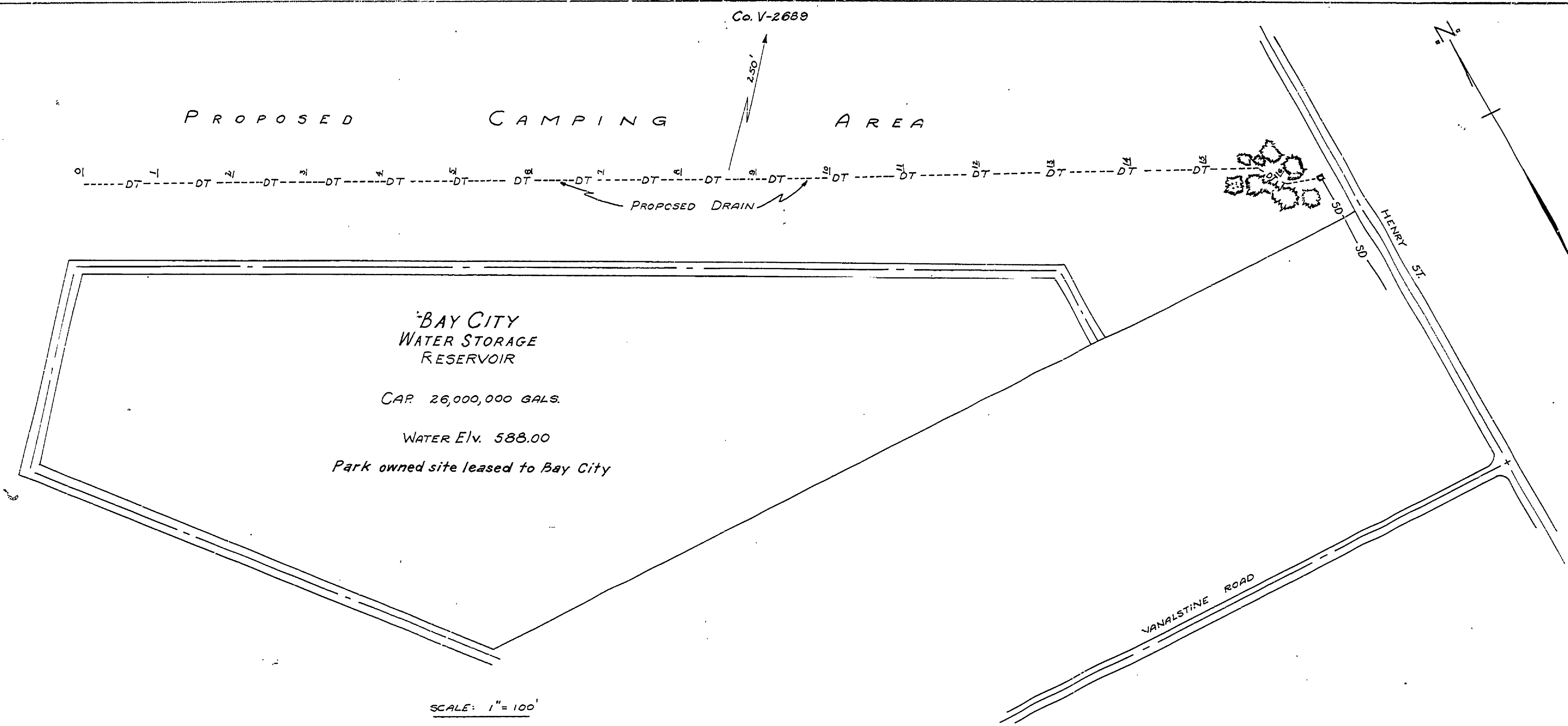

TYPICAL CROSS-SECTION

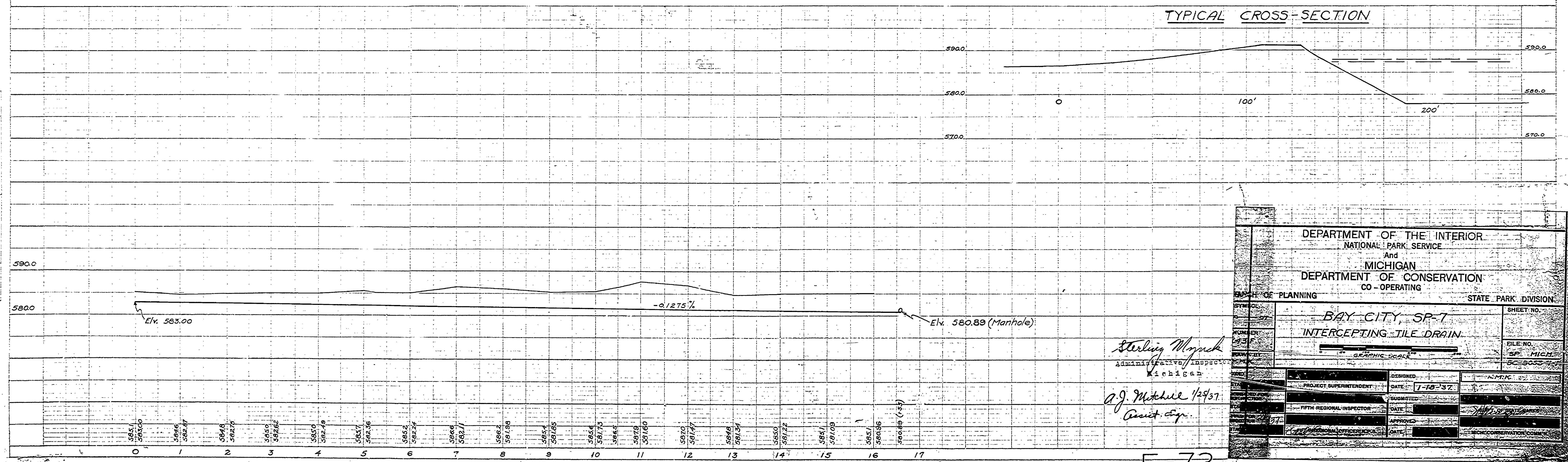

DATE: 1-15-37
BY: M.A.K.
CHECKED: M.A.K.
DESIGNED: M.A.K.
PROJECT: INTERCEPTING TILE DRAIN
SHEET NO. 1

DATE: 1-15-37
BY: M.A.K.
CHECKED: M.A.K.
DESIGNED: M.A.K.
PROJECT: INTERCEPTING TILE DRAIN
SHEET NO. 1

DEPARTMENT OF THE INTERIOR
NATIONAL PARK SERVICE
And
MICHIGAN
DEPARTMENT OF CONSERVATION
CO-OPERATING

STATE PARK DIVISION

**BAY CITY, SP-7
INTERCEPTING TILE DRAIN**

DESIGNED: *Sterling Myrick*
ADMINISTRATIVE INSPECTOR
MICHIGAN

DATE: 1-15-37

PROJECT SUPERINTENDENT: _____
DESIGNED: _____
FIFTH REGIONAL INSPECTOR: _____
APPROVED: _____

FILE NO. SP MICH 5055-7A

E-73