

REVISIONS	NO.	DATE	BY
4			
3			
6			

APPROVED BY	DATE	REVIEWED BY SECTIONS
<i>[Signature]</i>	1-14-52	ARCHITECTURAL
ASSISTANT CHIEF IN CHARGE	11-14-51	ENGINEERING
OF DESIGN	1-16-52	LANDSCAPE

DRAWN BY	TRACED BY	CHECKED BY	DATE
<i>[Signature]</i>	<i>[Signature]</i>	<i>[Signature]</i>	1-16-52

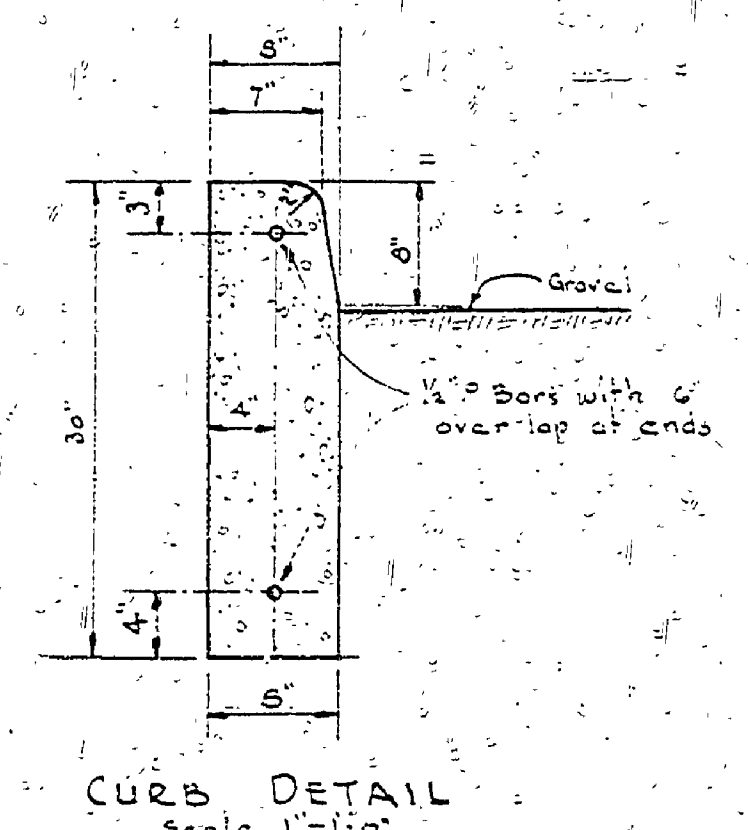
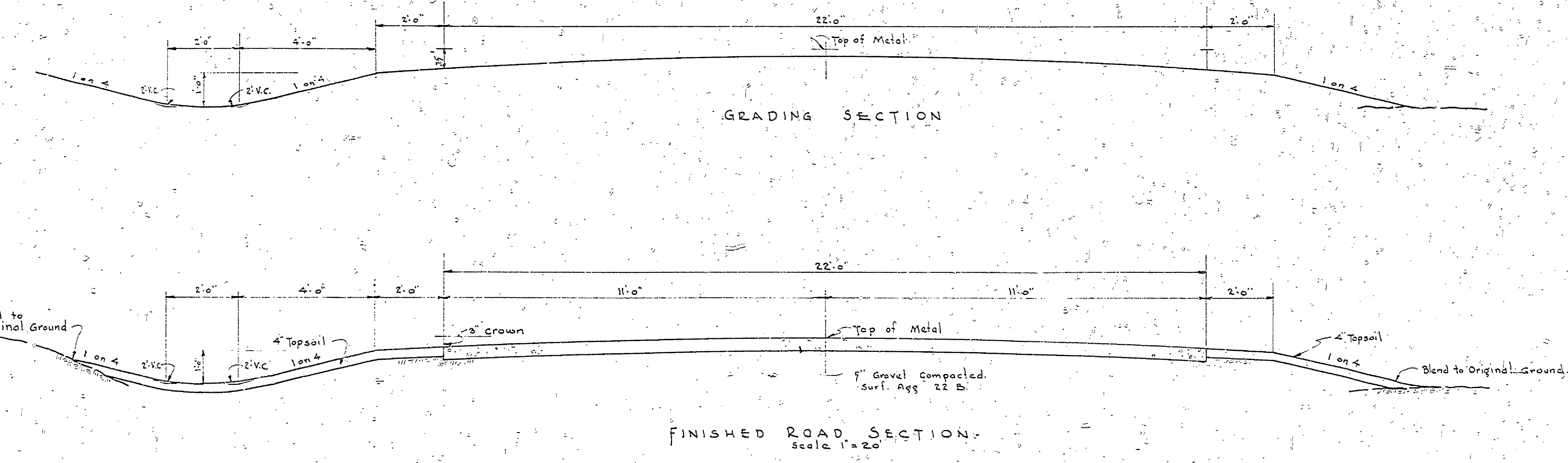
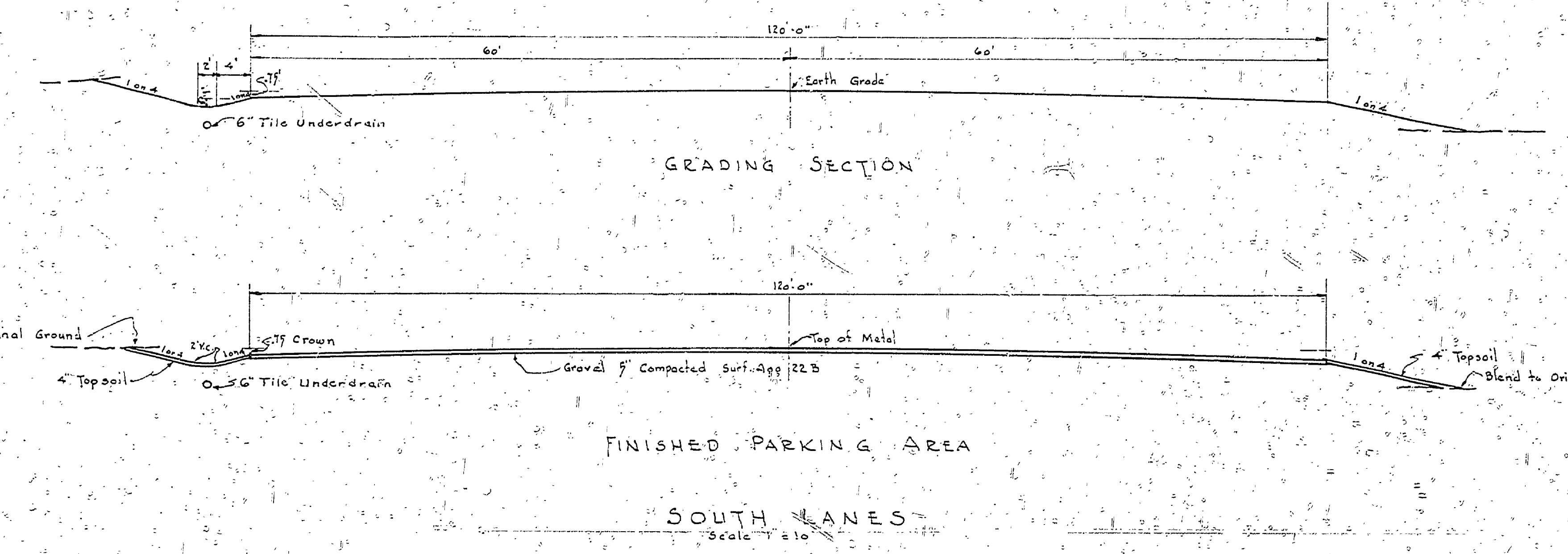
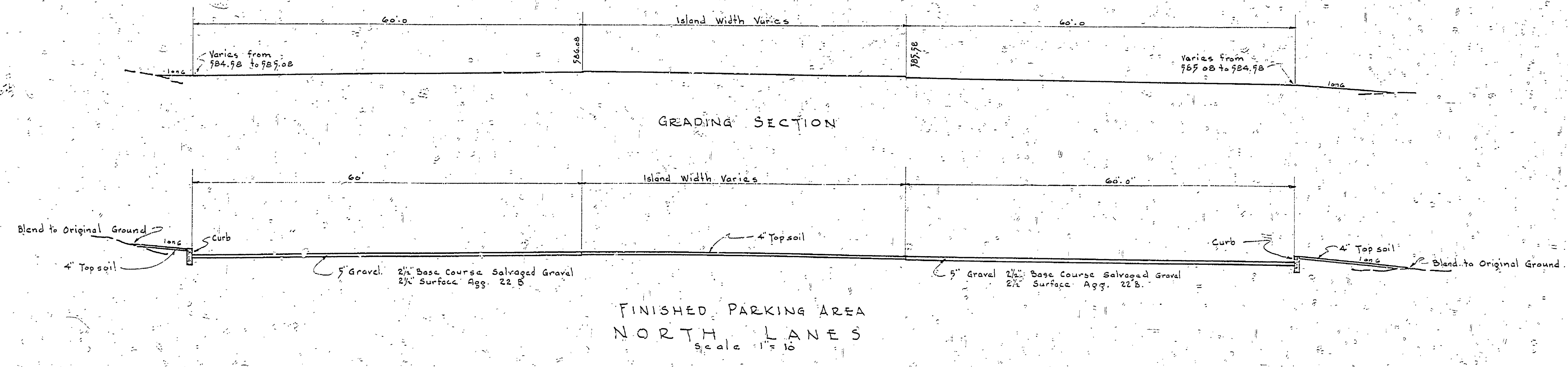

MICHIGAN
DEPARTMENT OF CONSERVATION
PARKS AND RECREATION DIVISION

BAY CITY STATE PARK
WEST PARKING AREA
TYPICAL CROSS SECTIONS
PROJECT NO. 75-204-1C

SHEET NO. 4 OF 11
PLAN NO. L-108