

BURT LAKE STATE PARK TOILET BUILDING 24-1315

WITNESSES TO R.O.B.
3/4" PIPE, FLUSH WITH GROUND
N 52° E, 14.00', 10" OAK, PK & TAG
N 52° E, 12.75', 13" OAK, PK & TAG
- 3 32" R, 15.00', 6" J.P.I.F.E.

R.M.C. ELEV. 608.01
A 1/2" SIZED SQUARE IN EAST
WINGWALL OF BATHHOUSE

WITNESSES TO R.O.B.
3/4" PIPE, FLUSH WITH GROUND
N 52° E, 12.00', 13" OAK, PK & TAG
S 60° E, 29.20', 6" OAK, PK & TAG
S 57° W, 28.00', 6" OAK, PK & TAG

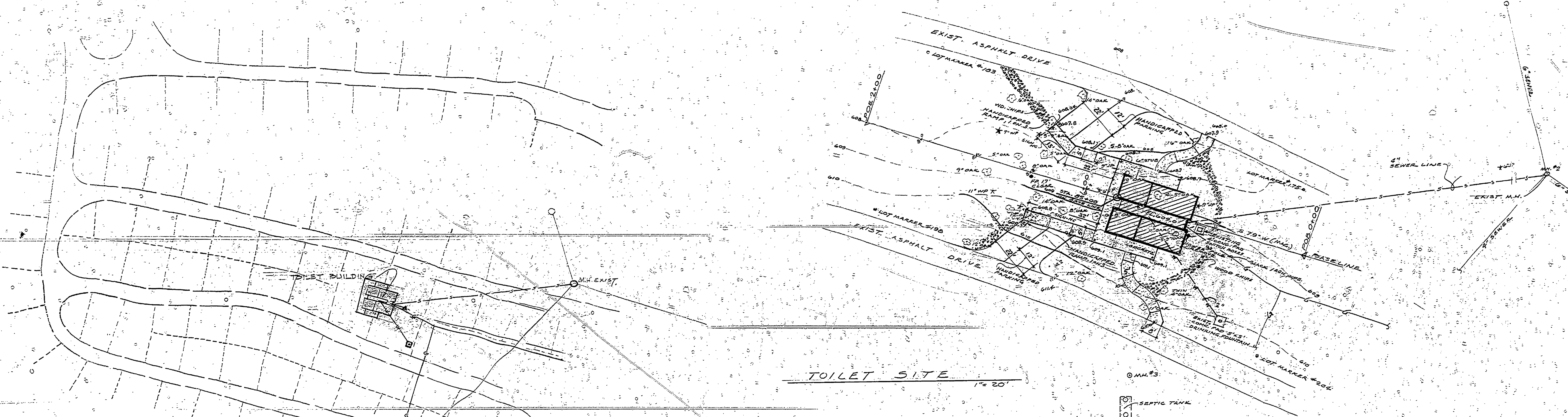

CAMPGROUND SITE
1" = 50' @

TOILET SITE
1" = 20'

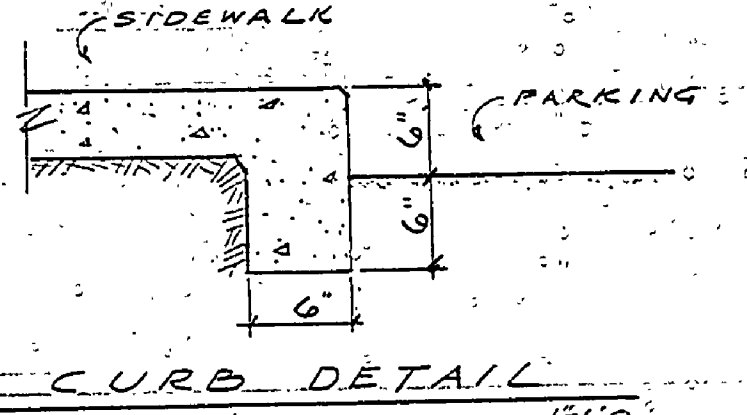
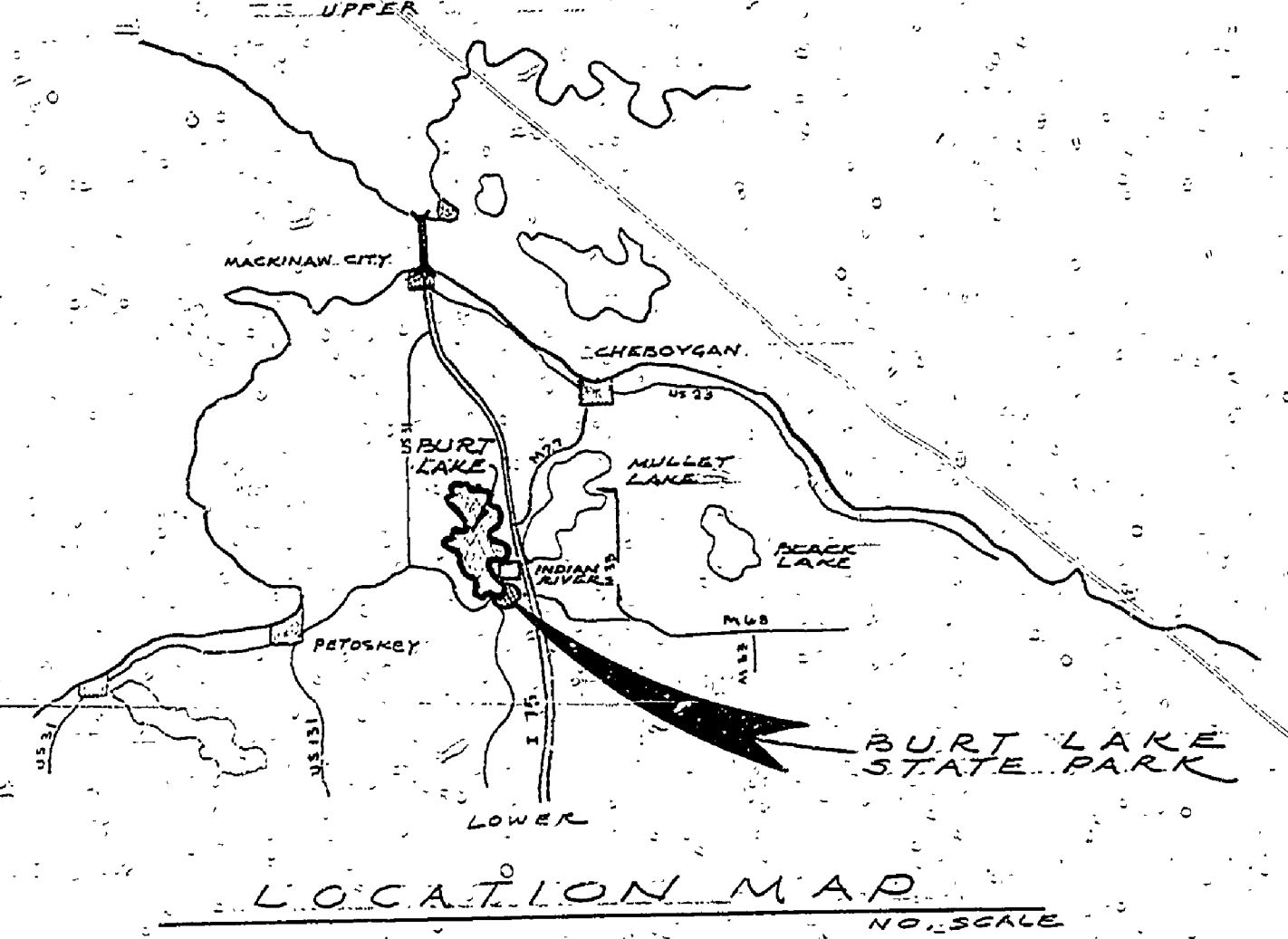

BUILDING COMMITTEE APPROVAL	
BY:	DATE:
DESIGNER	DATE
RECOMMENDED FOR APPROVAL	DATE
DESIGNER	DATE
RECOMMENDED FOR APPROVAL	DATE
DESIGNER & ARCHITECT	DATE
DIVISION APPROVAL	DATE
DIVISION CHIEF	DATE
MICHIGAN DEPARTMENT OF NATURAL RESOURCES	
APPROVED:	DATE
SUPERVISOR	DATE
PLAN NO.	PROJECT NUMBER
	SHEET OF

SURVEYED BY	DRAWN BY	DATE	NO.	DATE	BY	REVISIONS	NO.	DATE	BY	REVISIONS
	Z.L.	9/15/72	1.				3.			
DESIGNED BY	CHECKED BY	DATE	2.				4.			

MICHIGAN DEPARTMENT OF NATURAL RESOURCES

SITE PLAN TOILET BUILDING SHEET TITLE

BURT LAKE AREA OR PARK
PROJECT NO. 24-1315

PROJECT NO. SHEET 3 OF 3 PLAN NO. A-110