

# BURT LAKE STATE PARK CONSTRUCTION PLANS FOR BLACKTOP ROADS

PROJECT NO. PR61-999-976-005

CONSERVATION COMMISSION APPROVAL	
BY: _____	DATE: _____
RECOMMENDED DESIGN FOR APPROVAL: <i>H. J. Stone</i> 1-17-65	DATE
RECOMMENDED FOR APPROVAL: _____	DATE
SECTION APPROVAL	
BY: _____	DATE: _____
SECTION CHIEF	
MICHIGAN DEPARTMENT OF CONSERVATION	
APPROVED: _____	DATE: _____
CHIEF ENGINEER	DATE
PLAN NO. _____	PROJECT NUMBER _____
_____	SHEET OF _____

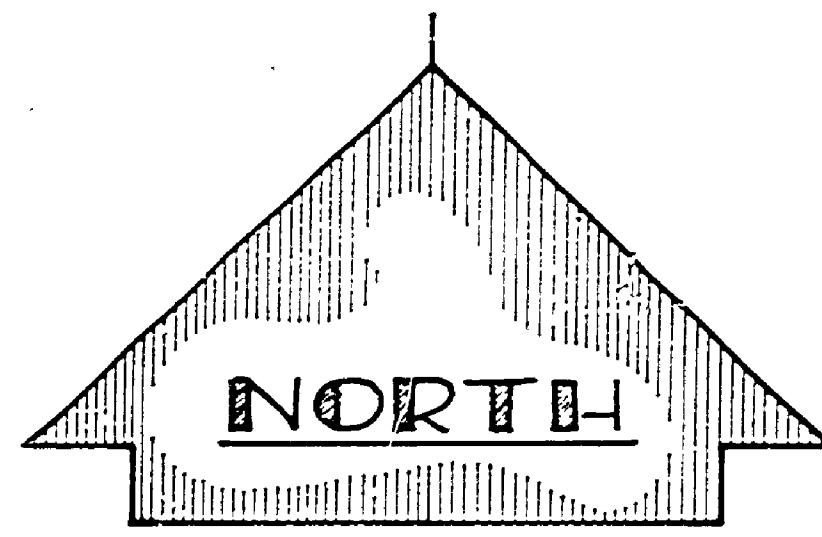

SCALE 1" = 200'

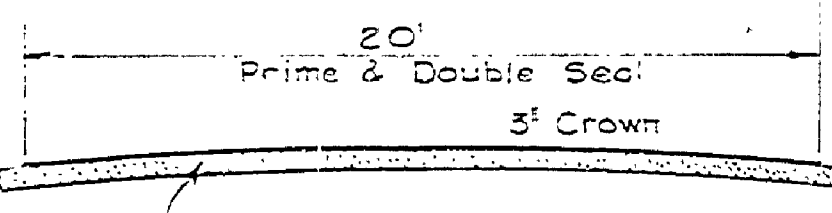
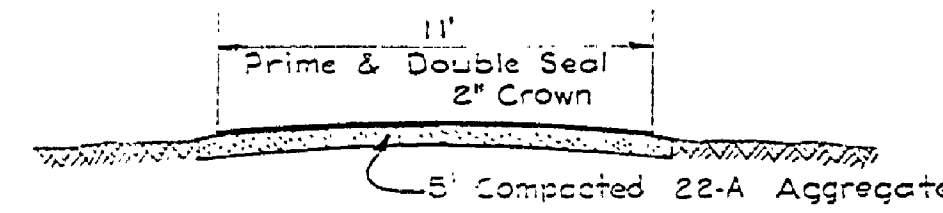

PROPOSED SURFACING THIS CONTRACT  
18,800 SQ. YDS. PRIME & DOUBLE SEAL  
100 TONS 22-A AGGREGATE, M.S.H.D SPECIFICATION.

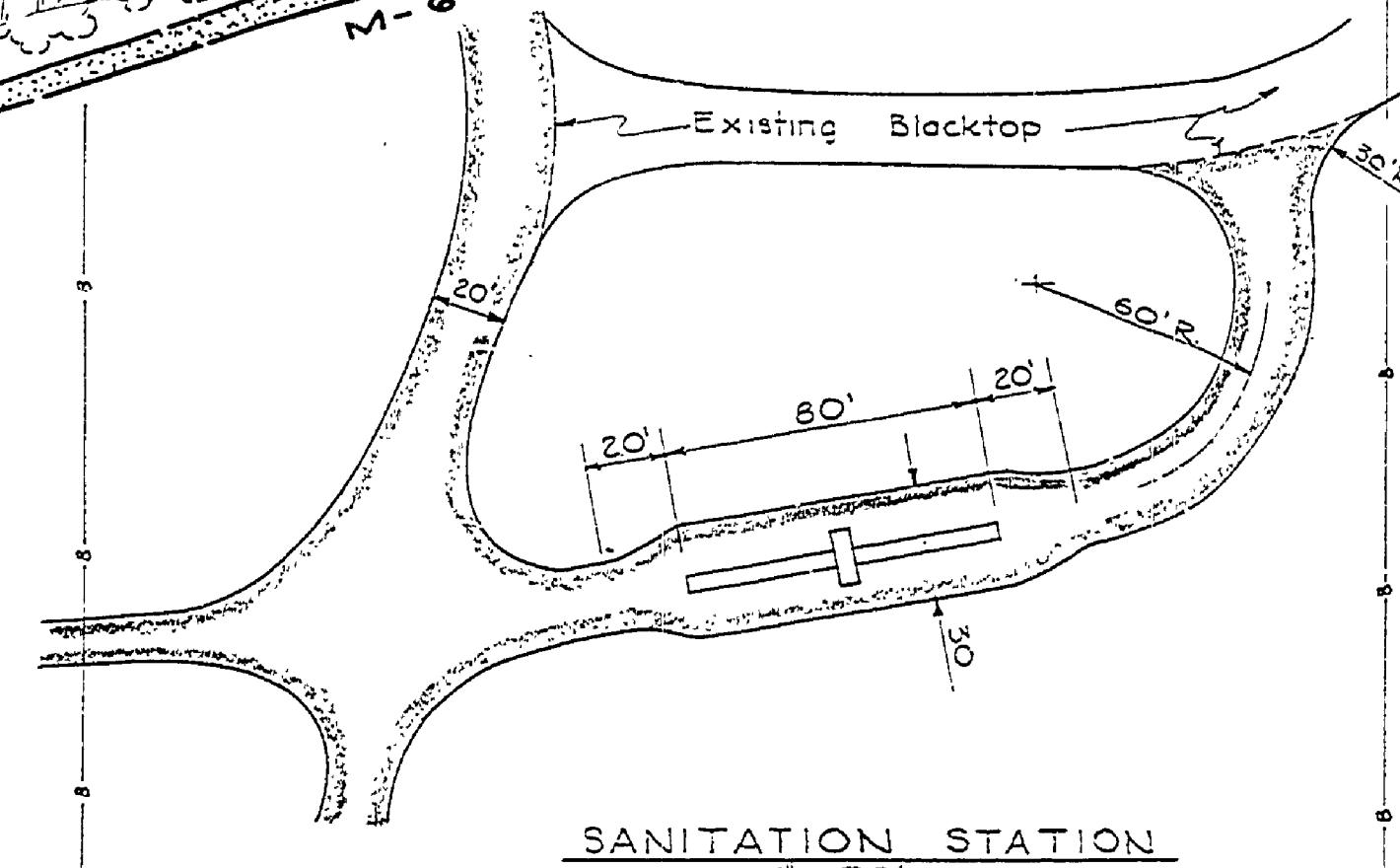
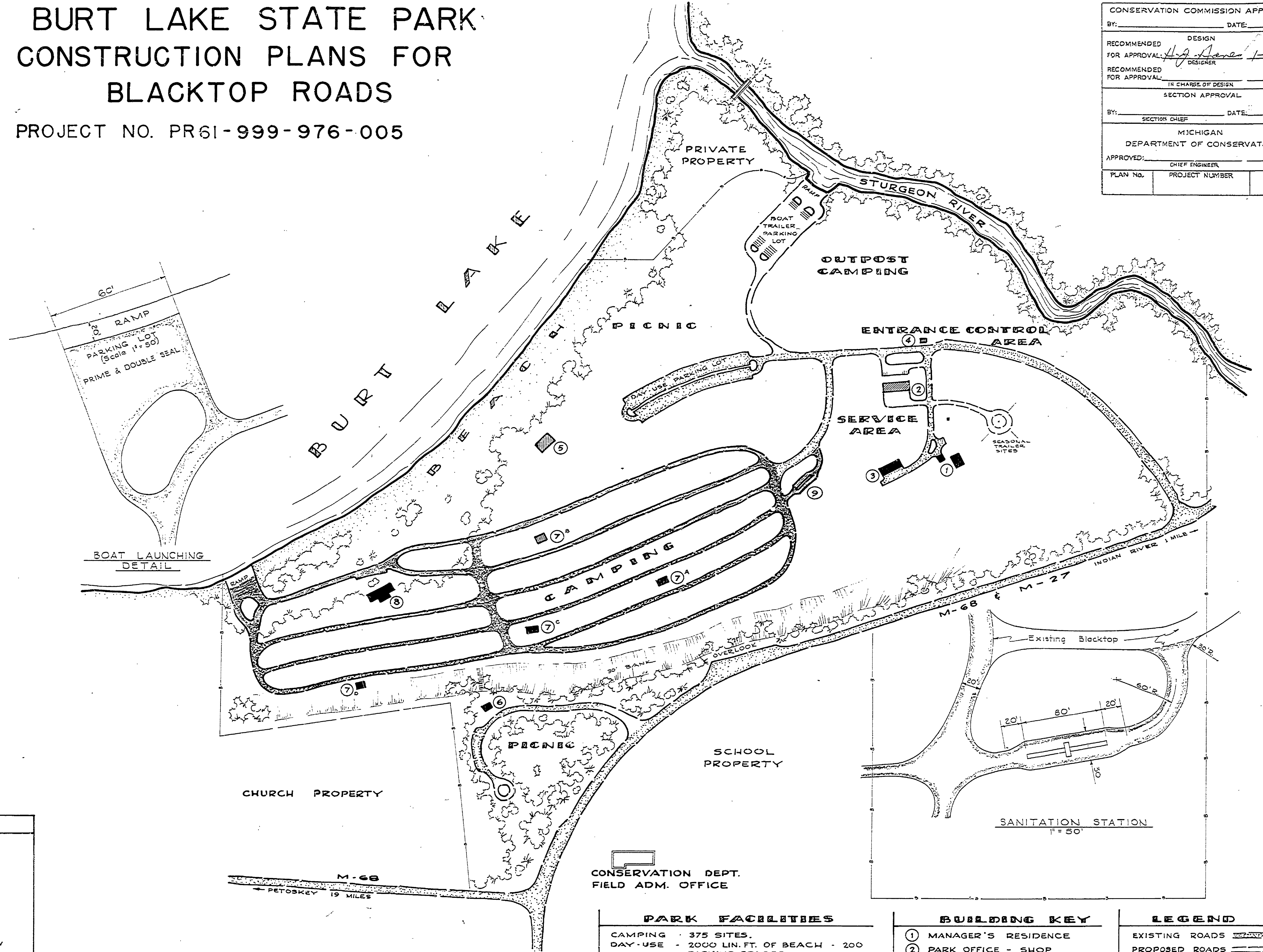

## LOCATION MAP

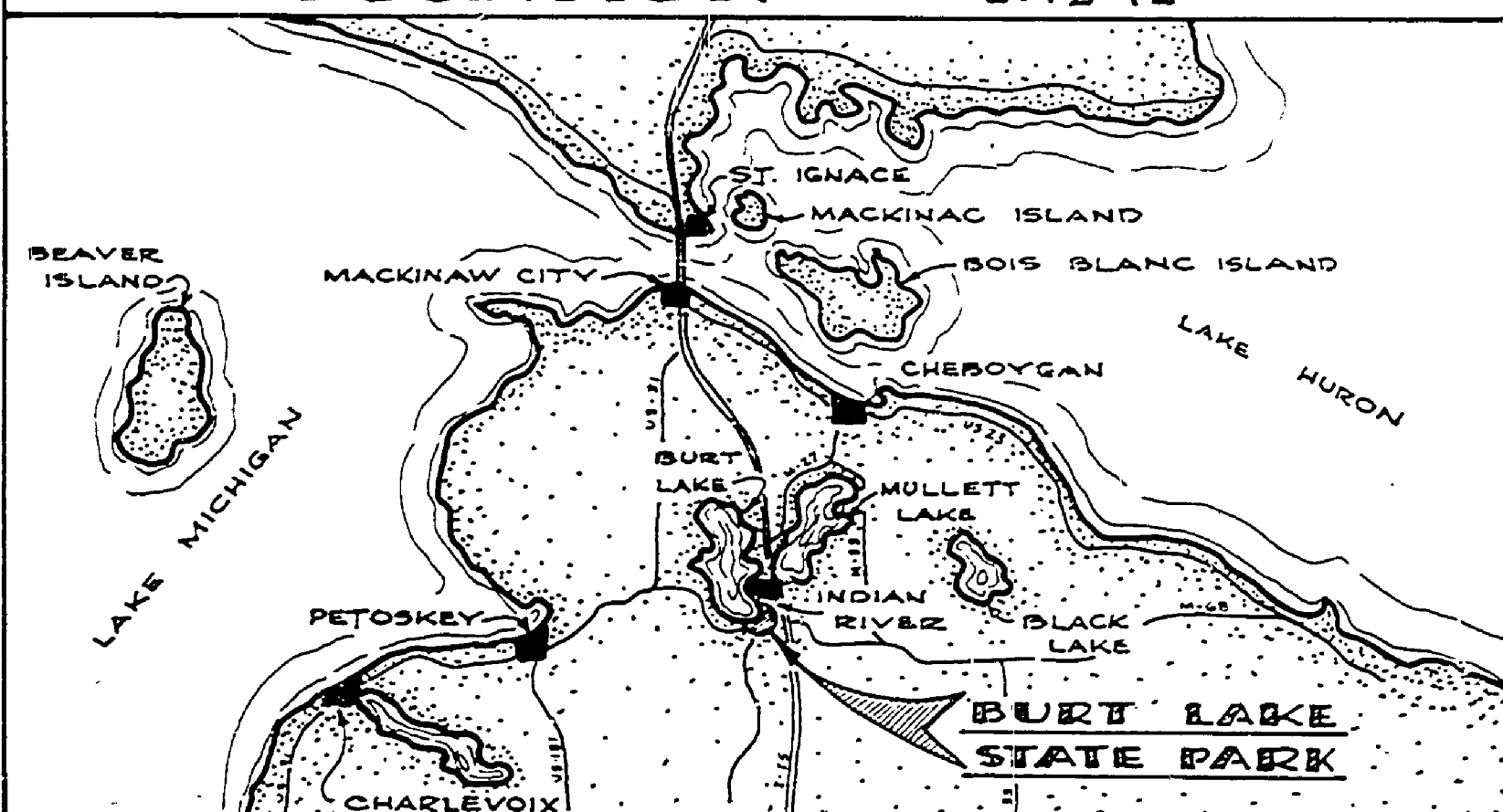

CONSERVATION DEPT.  
FIELD ADM. OFFICE

### PARK FACILITIES

CAMPING - 375 SITES.  
DAY-USE - 2000 LIN. FT. OF BEACH - 200 PARKING SPACES.  
BOATING - 2 RAMPS - 50 TRAILER PARKING SPACES.  
USE AREA - 150 ACRES.

### BUILDING KEY

- 1 MANAGER'S RESIDENCE
- 2 PARK OFFICE - SHOP
- 3 GARAGE - SHOP
- 4 ENTRANCE CONTROL OFFICE
- 5 BATHHOUSE - PARK STORE
- 6 PICNIC TOILET
- 7 CAMPGROUND TOILET
- 8 ACTIVITIES CENTER
- 9 TRAILER SANITATION STATION

### LEGEND

- EXISTING ROADS
- PROPOSED ROADS
- EXISTING BUILDINGS
- PROPOSED BUILDINGS
- PARK BOUNDARY
- FOLIAGE
- SAND
- WATER

MICHIGAN DEPARTMENT OF CONSERVATION  
PARKS AND RECREATION DIVISION

BURT LAKE STATE PARK  
BLACKTOP ROADS

SHEET NO. 1 OF 1  
PLAN NO. E-116

DATE	REVIEWED	APPROVED	DATE	NO.	DATE	BY	REVISIONS
3-65	ARCHITECTURAL			1			4
3-65	ENGINEERING			2			5
	LANDSCAPE			3			6
DESIGNED BY F. G. F.							
DRAWN BY D. M. C.							
CHECKED BY							