

NO.	DATE	BY	REVISIONS
1	1/25/58	J.R.R.	ADDED WALKWAY TO WEST SIDE OF STATION # 1
2	1/25/58	J.R.R.	ADDED WALKWAY TO EAST SIDE OF STATION # 1
3	1/25/58	J.R.R.	ADDED WALKWAY TO WEST SIDE OF STATION # 2
4	1/25/58	J.R.R.	ADDED WALKWAY TO EAST SIDE OF STATION # 2
5	1/25/58	J.R.R.	ADDED WALKWAY TO WEST SIDE OF STATION # 3
6	1/25/58	J.R.R.	ADDED WALKWAY TO EAST SIDE OF STATION # 3

DATE	APPROVED BY	DATE	APPROVED BY
1/25/58	J.R.R.	1/25/58	J.R.R.
1/25/58	J.R.R.	1/25/58	J.R.R.
1/25/58	J.R.R.	1/25/58	J.R.R.

DRAWN BY L.M.C.  
 TRACED BY L.M.C.  
 CHECKED BY W.N.G.  
 DATE

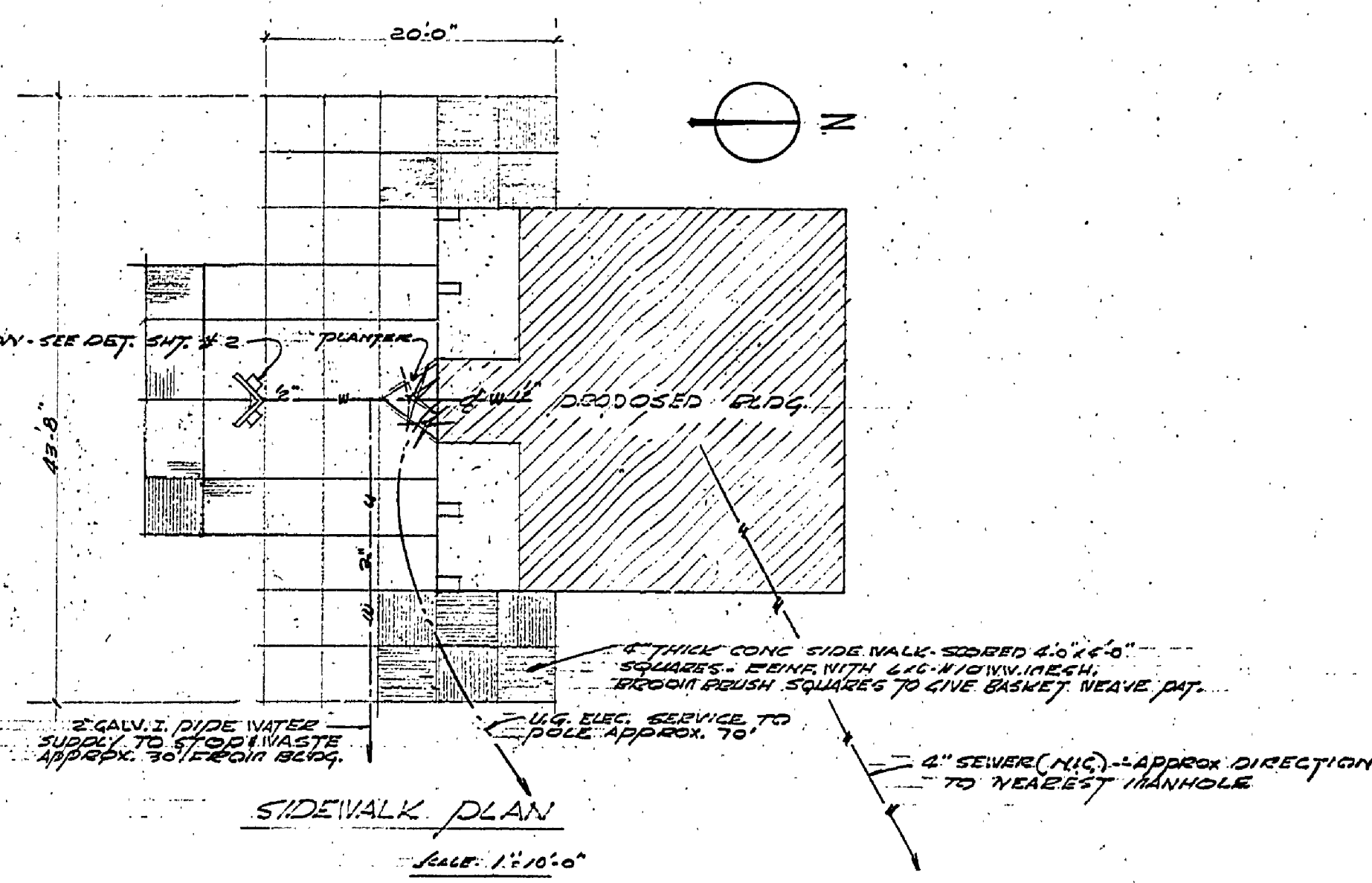
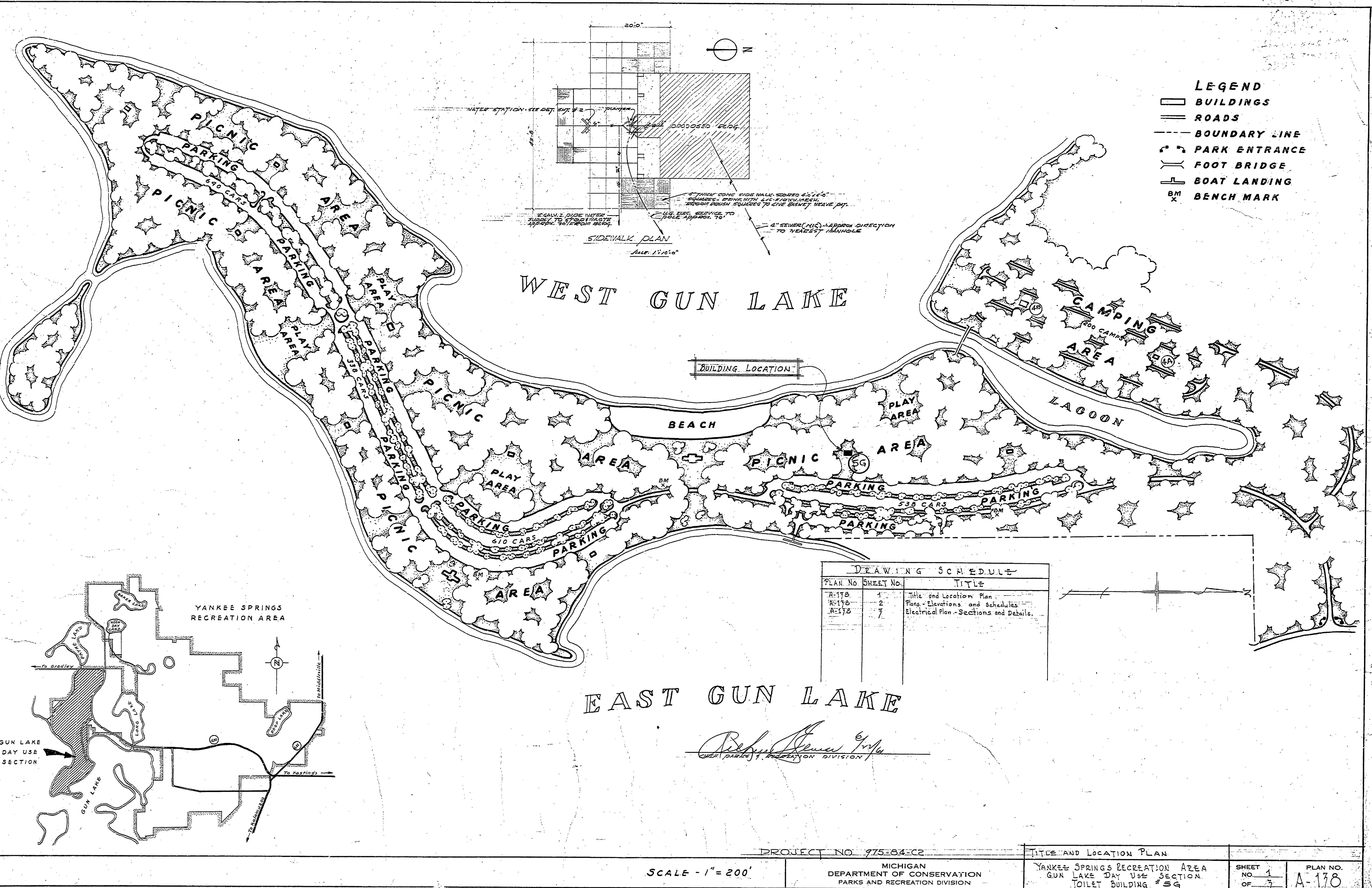

**LEGEND**

- BUILDINGS
- ROADS
- BOUNDARY LINE
- PARK ENTRANCE
- FOOT BRIDGE
- BOAT LANDING
- BENCH MARK

PLAN No.	SHEET No.	TITLE
A-178	1	Title and Location Plan
A-178	2	Plans - Elevations and Schedules
A-178	7	Electrical Plan - Sections and Details

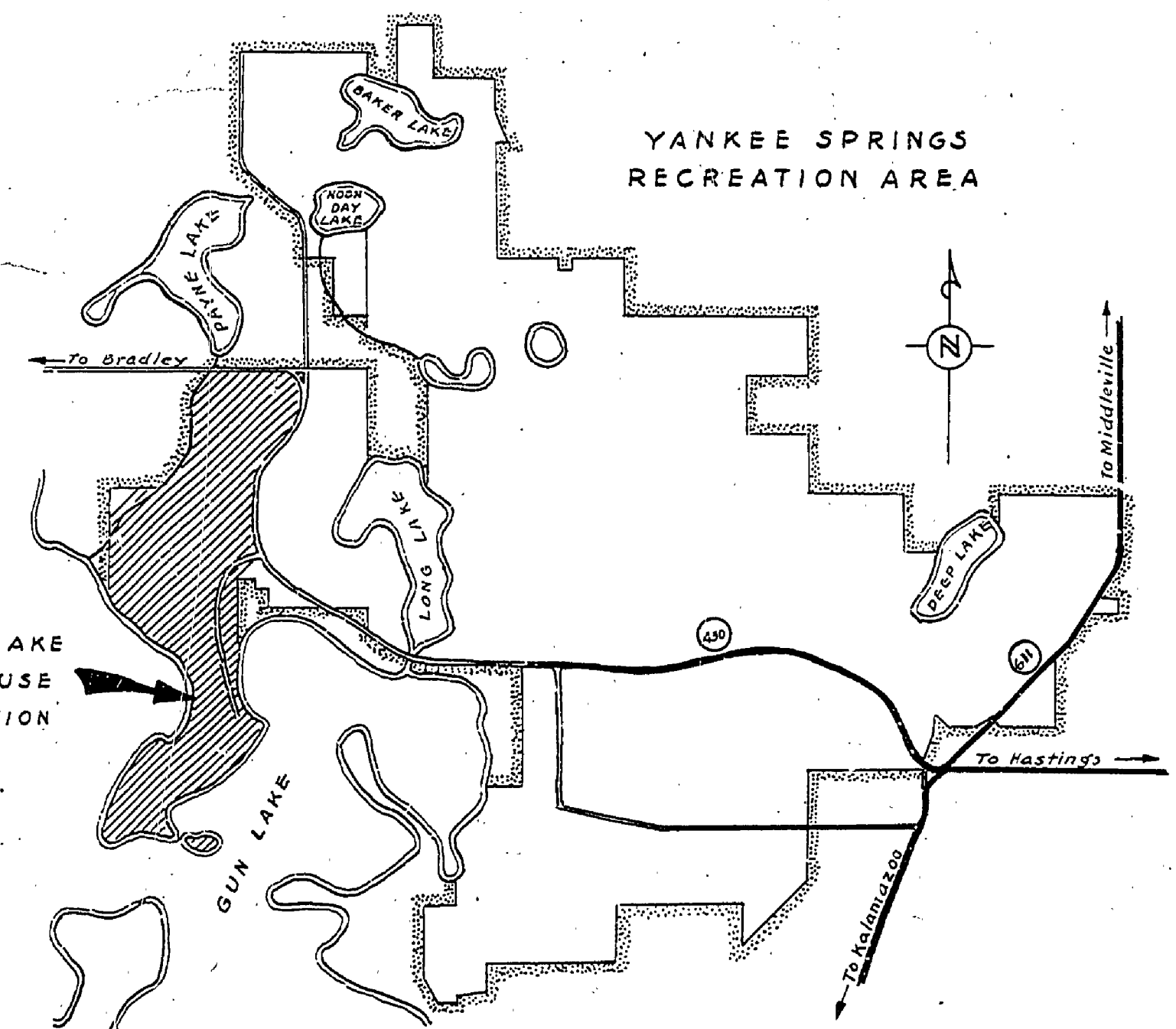

**EAST GUN LAKE**

*Richard J. ...*  
 CHIEF, PARKS & RECREATION DIVISION

PROJECT NO. 975-84-C2	TITLE AND LOCATION PLAN	SHEET NO. 1 OF 7	PLAN NO. A-178
SCALE - 1" = 200'	MICHIGAN DEPARTMENT OF CONSERVATION PARKS AND RECREATION DIVISION	YANKEE SPRINGS RECREATION AREA GUN LAKE DAY USE SECTION TOILET BUILDING # 59	