

UNIT LATRINE #1

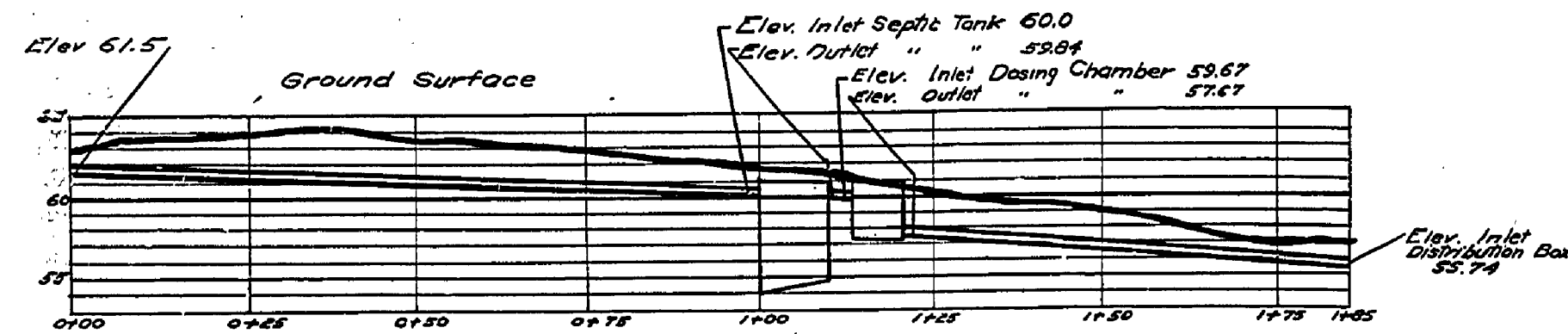

UNIT LATRINE #2

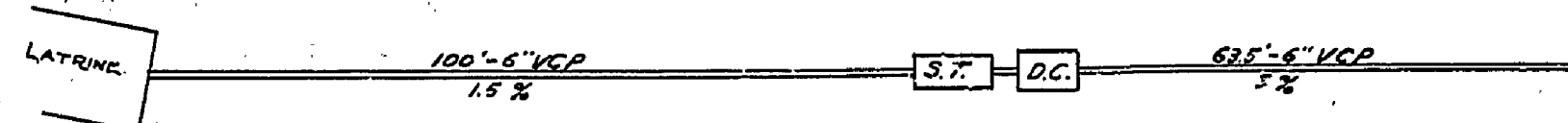
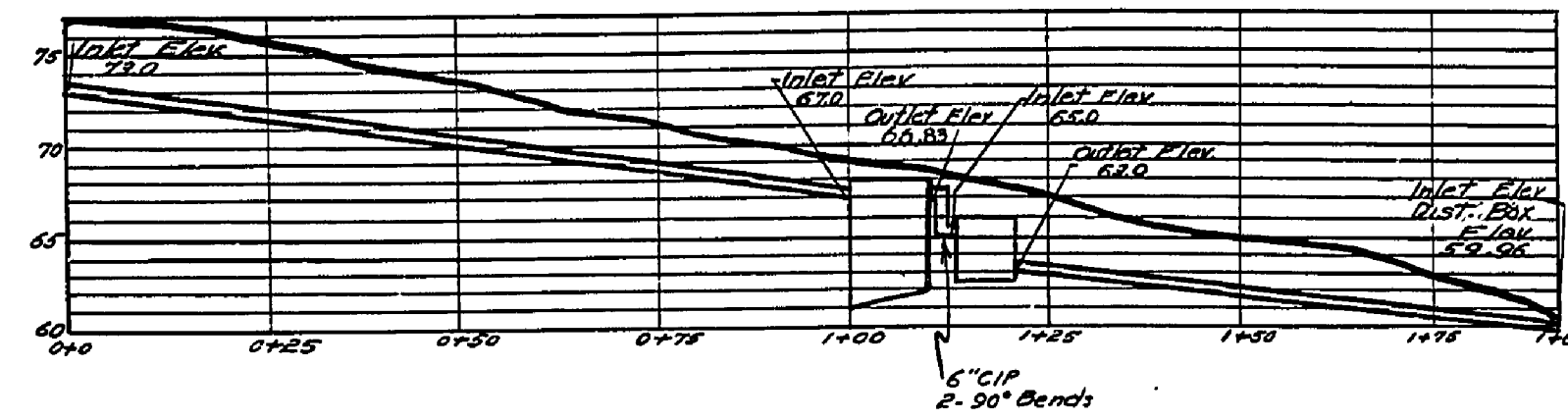
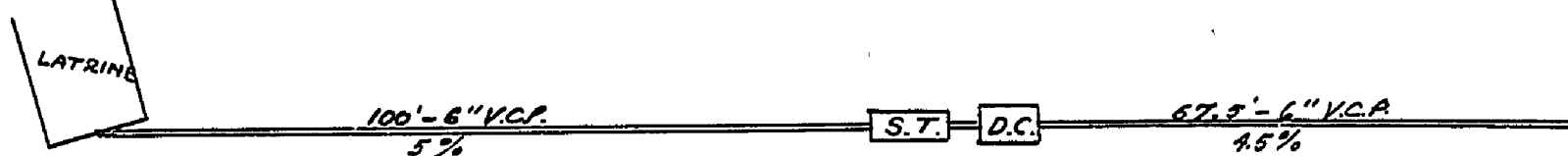

UNIT LATRINE #3

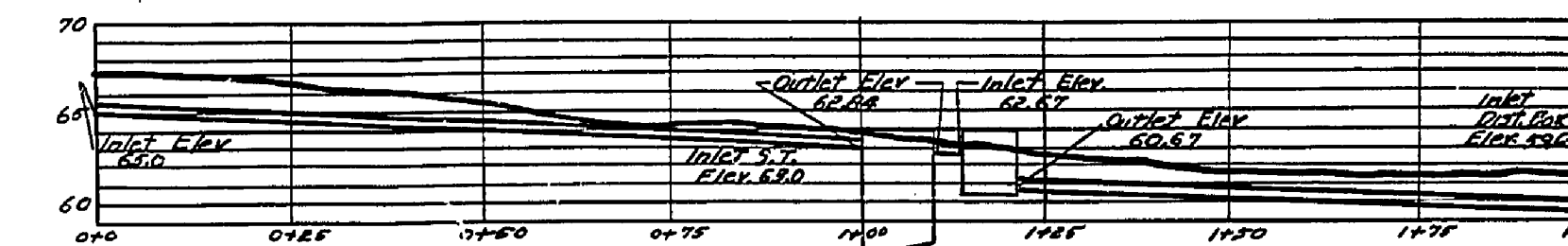
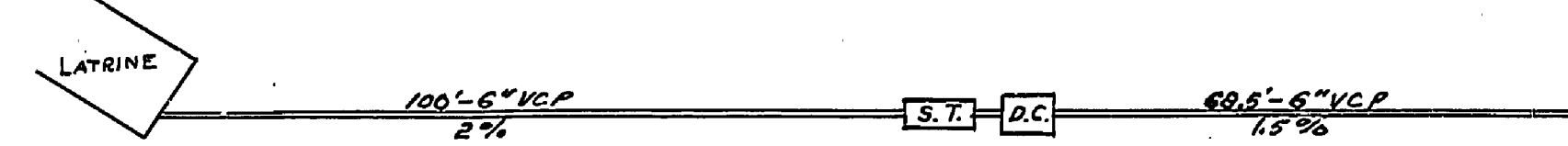

UNIT LATRINE #4

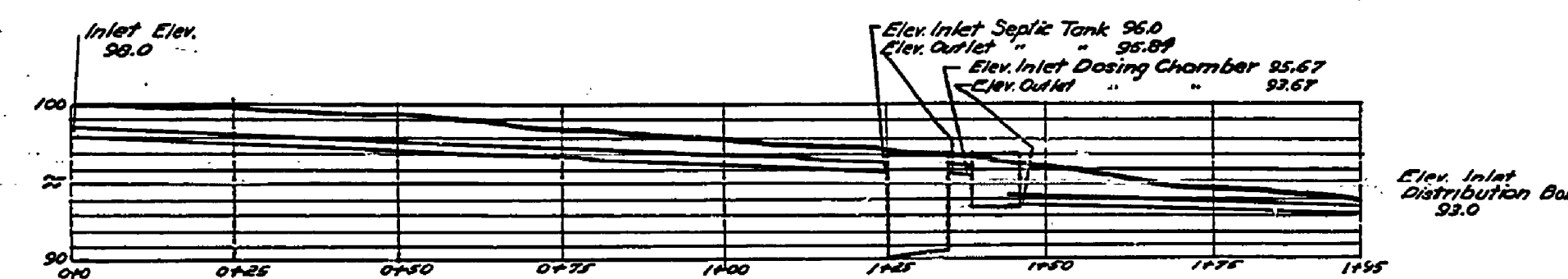
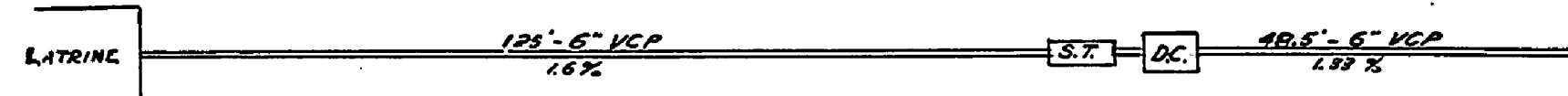

INFIRMARY

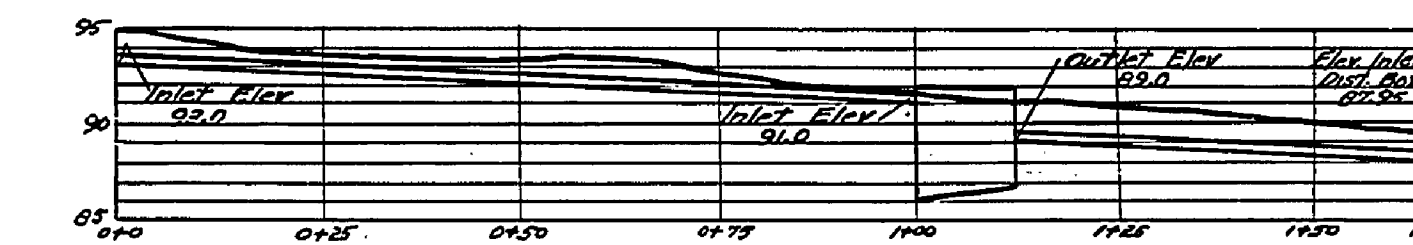

MAN HOLE #1 INTERPOSED IN SEWER LINE

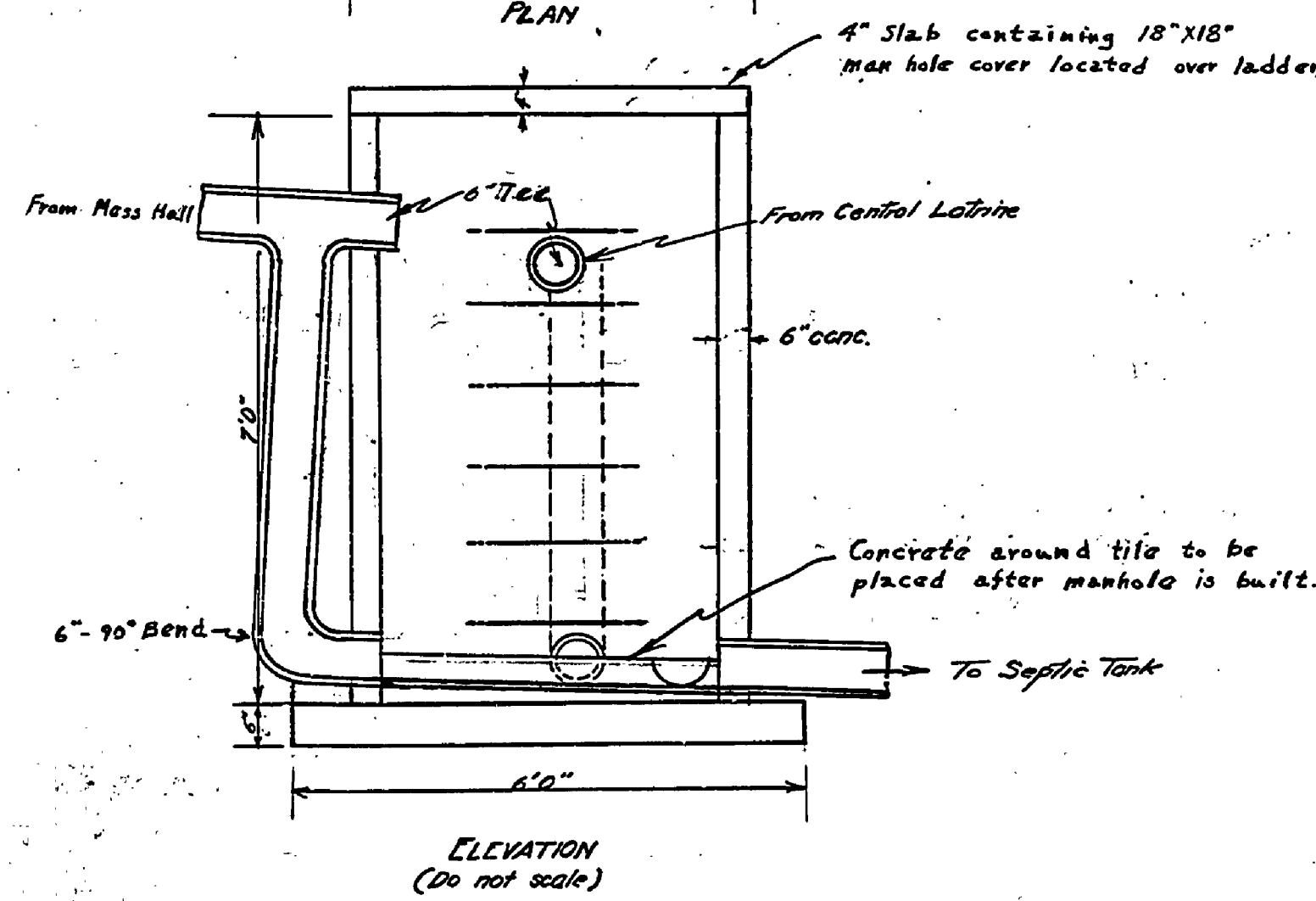
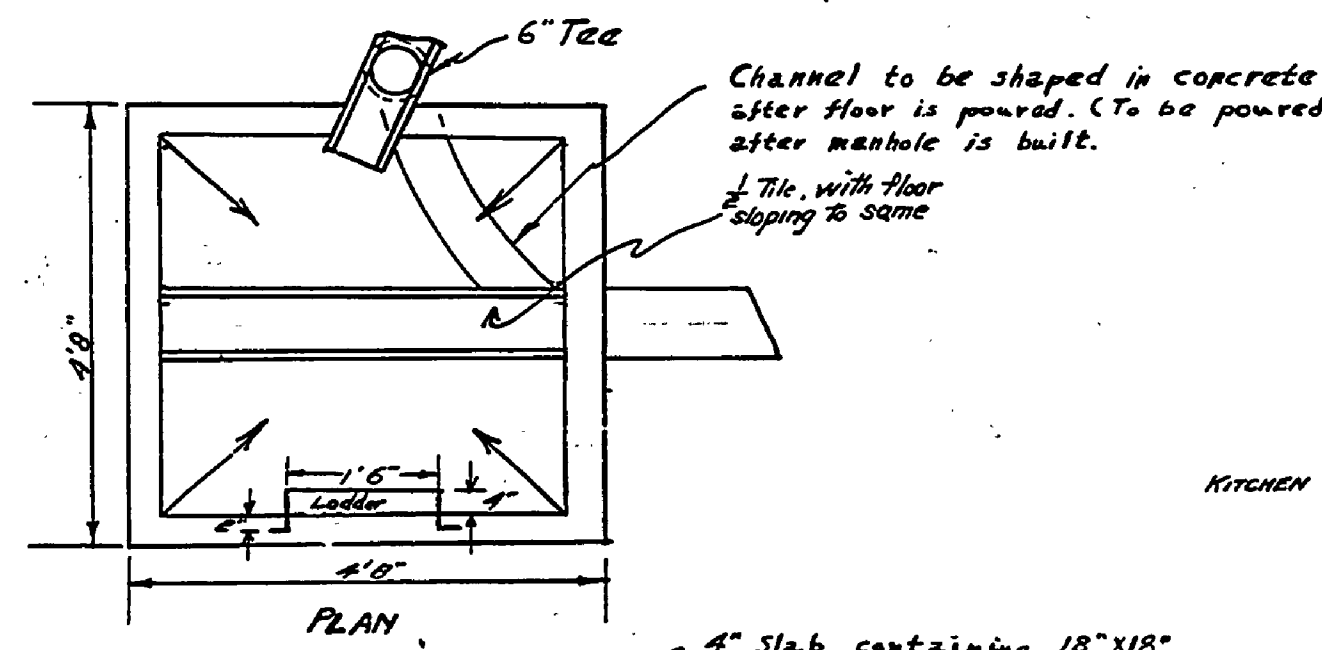

MESS HALL AND CENTRAL LATRINE

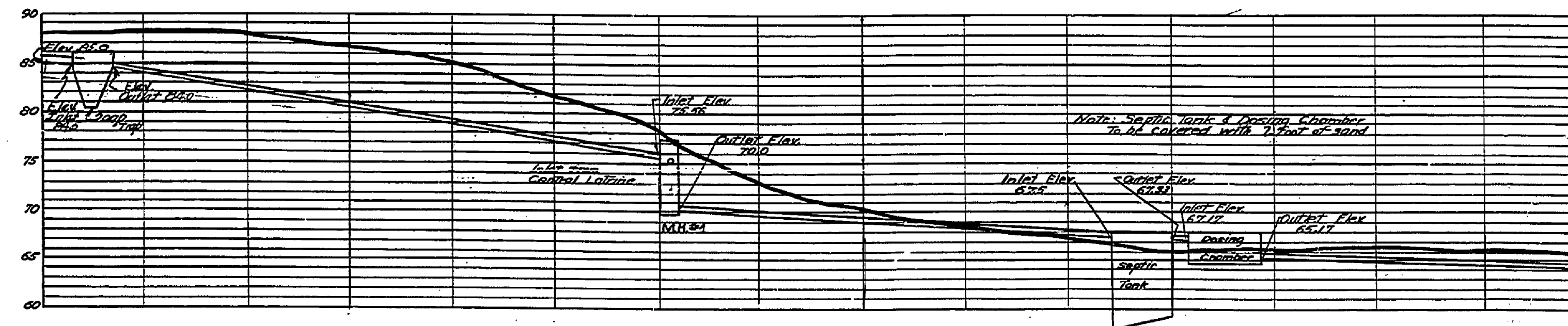
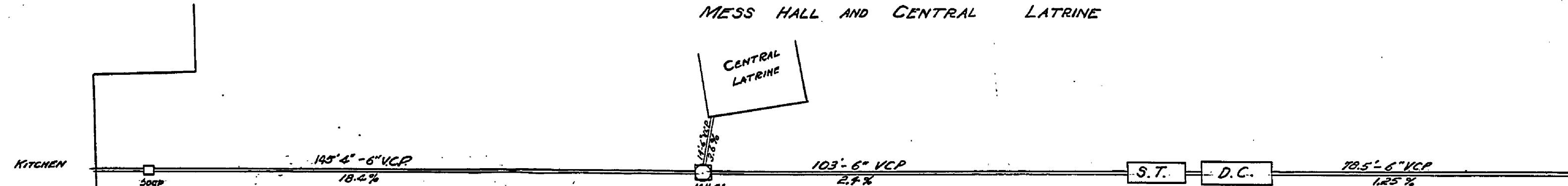

CENTRAL LATRINE TO MAN HOLE

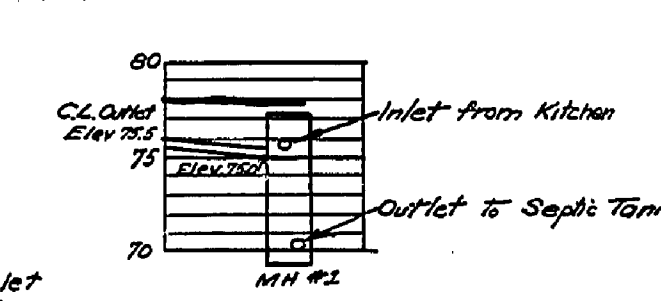

Note: All sewer lines to have a minimum of 3' of cover.

APPROVED BY
MICHIGAN DEPT. OF HEALTH
Edward S. Rich
DIRECTOR BUREAU OF ENGINEERING

APPROVED BY
INSPECTOR

APPROVED BY
MICHIGAN CONSERVATION COM'N.
J. S. ...
SUPT. OF STATE PARKS

UNITED STATES
DEPARTMENT OF THE INTERIOR
NATIONAL PARK SERVICE
COOPERATING WITH
MICHIGAN CONSERVATION COMMISSION

DRAWN BY
G.L.C.

DESIGNED BY
G.L.C.

CHECKED BY
F.L.H.

PREPARED BY
[Signature]

RECOMMENDED
Carl C. ...

APPROVED BY
[Signature]

YANKEE SPRINGS
LONG LAKE
SEWER PROFILES

GRAPHIC SCALE
20' 40' 60' 80' 100'

DATE
May 10-37

DATE
5-3-37

DATE
MAY 7, 1937

DATE
MAY 7, 1937