

YANKEE SPRINGS RECREATION AREA CONSTRUCTION PLANS FOR

PRIMARY SERVICE PRELIMINARY STUDY

KEY TO POWER LINES
 ——— PROPOSED PRIMARY
 - - - FUTURE PRIMARY
 - - - EXISTING PRIMARY
 - - - PROPOSED SECONDARY
 - - - FUTURE SECONDARY

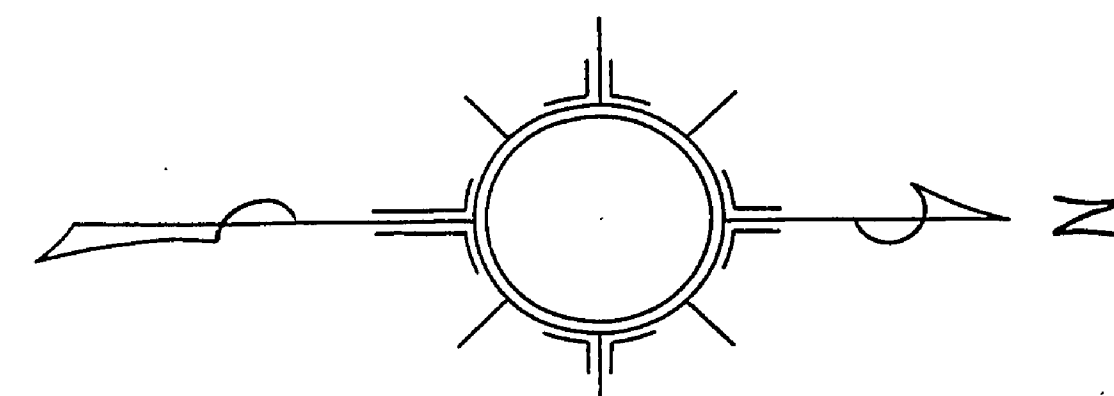

WEST GUN LAKE

EAST GUN LAKE

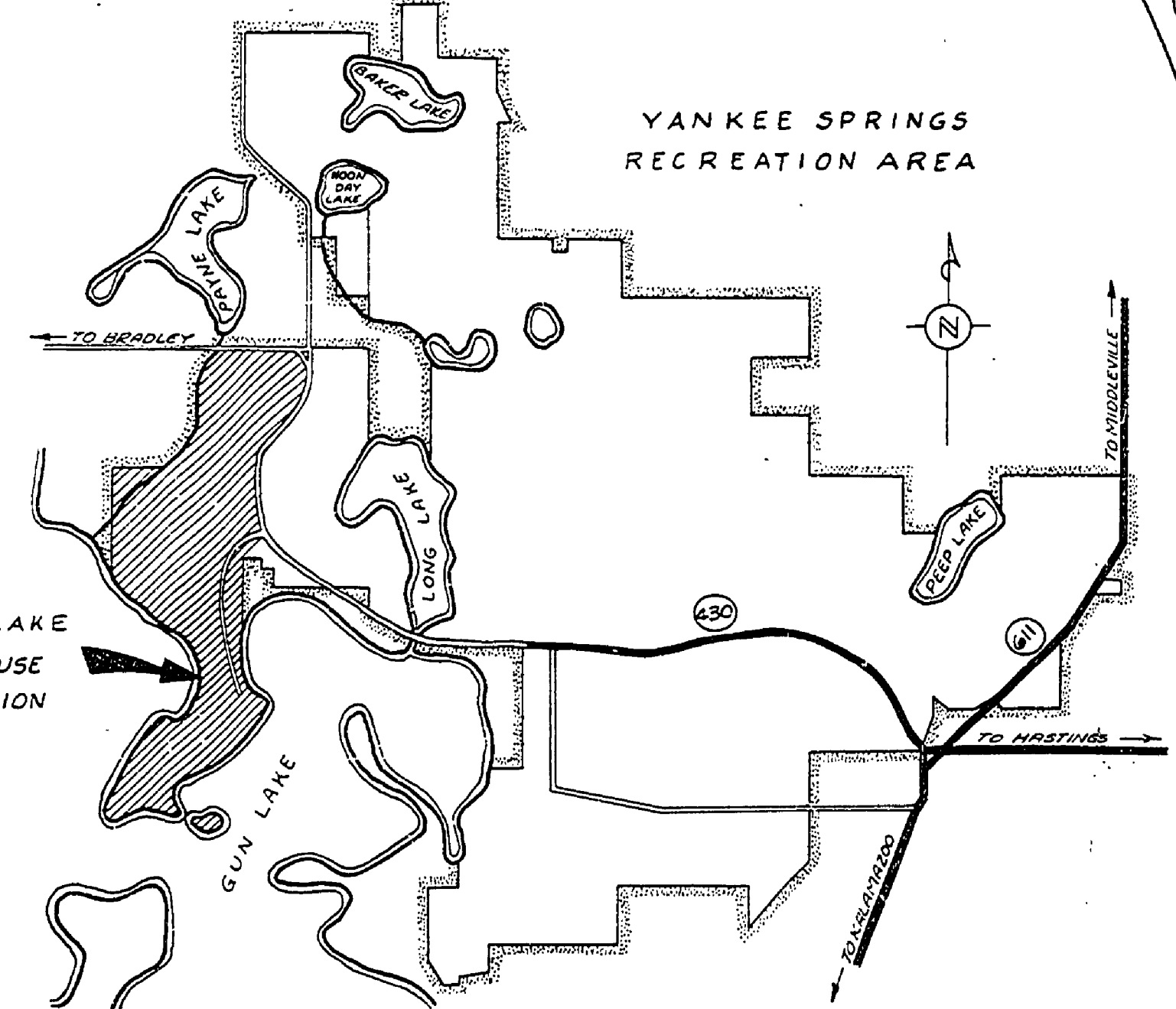
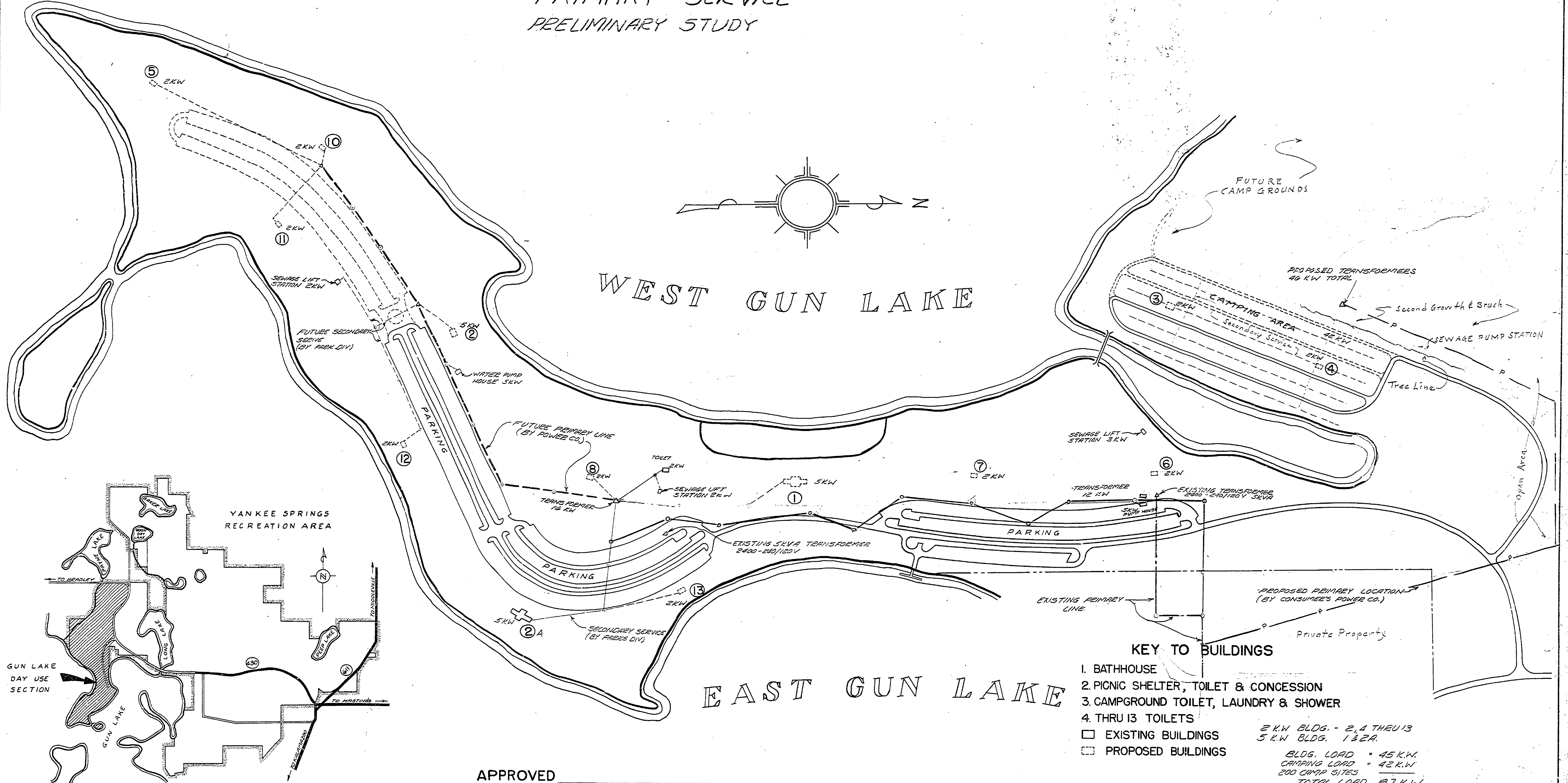

KEY TO BUILDINGS

- 1. BATHHOUSE
- 2. PICNIC SHELTER, TOILET & CONCESSION
- 3. CAMPGROUND TOILET, LAUNDRY & SHOWER
- 4. THRU 13 TOILETS
- EXISTING BUILDINGS
- ▣ PROPOSED BUILDINGS

2 KW BLDG. - 2, 4 THRU 13
 5 KW BLDG. - 1 & 2A.
 BLDG. LOAD = 45 KW.
 CAMPING LOAD = 42 KW.
 200 CAMP SITES
 TOTAL LOAD 87 KW

APPROVED _____
 CHIEF, PARK AND RECREATION DIVISION

SCALE 1"=200'

MICHIGAN
 DEPARTMENT OF CONSERVATION
 PARKS AND RECREATION DIVISION

YANKEE SPRINGS RECREATION AREA
 GUN LAKE DAY USE SECTION
 ELECTRICAL DIST.

SHEET NO. _____
 OF _____
 PLAN NO. E-133

| | | | | | | | | | | | | | | | |
|------------------------------|-----------|------------|----------------|----------------------|-------------|-----------|-------------|-------------------------------------|------|-------------|---|---|-----------|---|---|
| DRAWN BY E.C. BENNETT EAP | TRACED BY | CHECKED BY | DATE 5.7.56 | REVIEWED BY SECTIONS | | | APPROVED BY | | | NO. DATE BY | | | REVISIONS | | |
| | | | | ARCHITECTURAL | ENGINEERING | LANDSCAPE | DATE | ASSISTANT CHIEF IN CHARGE OF DESIGN | DATE | 1 | 2 | 3 | 4 | 5 | 6 |