

BRUNING 82170	REVISIONS	
NO.	DATE	BY
1		
2		
3		
4		
5		
6		

DRAWN BY	B. H. G.
CHECKED BY	E. S. P.
DATE	29 Jan. 1962
APPROVED	<i>[Signature]</i>

REVIEWED BY SECTIONS	DATE	APPROVED BY
ARCHITECTURAL	W.N.G. 2-13-62	<i>[Signature]</i>
ENGINEERING	E.S.P. 1-21-62	ASSISTANT CHIEF IN CHARGE
LANDSCAPE	W.N.G. 2-13-62	BY DESIGN DATE

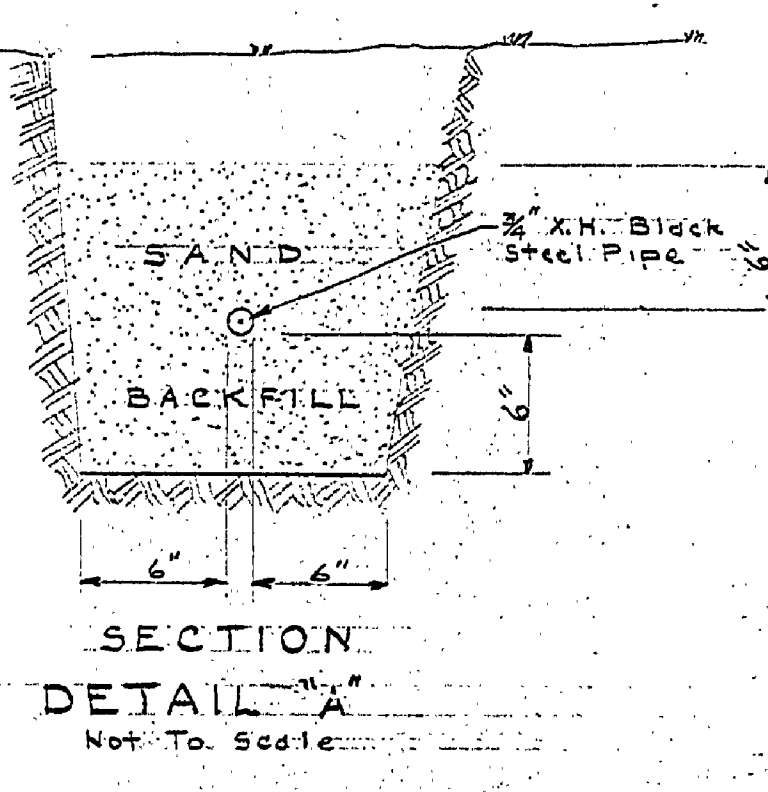
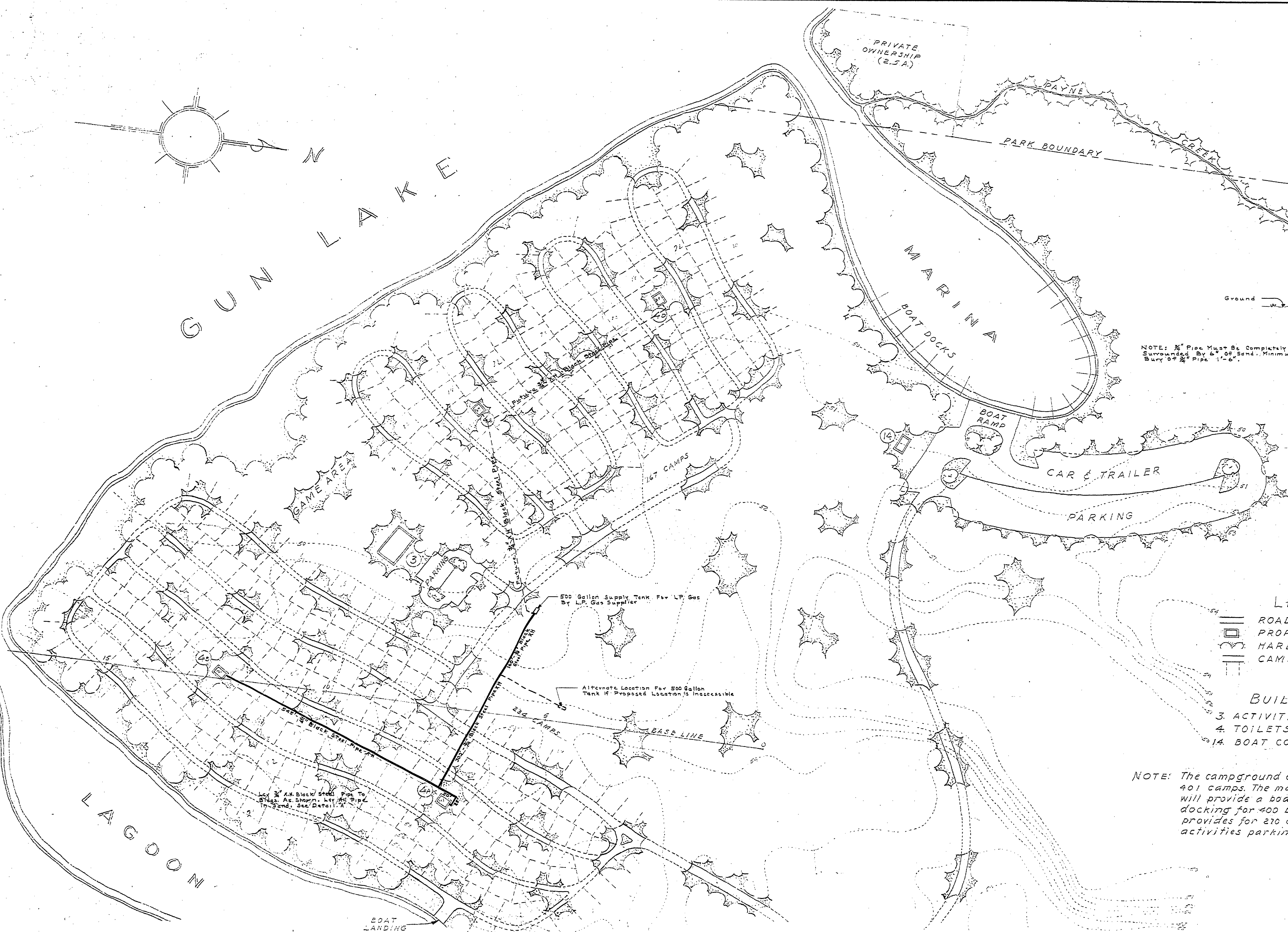

NOTE: 2" Pipe Must Be Completely Surrounded By 6" of Sand. Minimum Bury 6" 2" Pipe 1'-6".

- LEGEND**
- ROADS
 - PROPOSED BUILDINGS
 - HARDWOOD COVER
 - CAMPSITES

- BUILDING KEY**
- 3. ACTIVITIES CENTER
 - 4. TOILETS & SHOWERS
 - 14. BOAT CONCESSION

NOTE: The campground of 40 acres will accommodate 401 camps. The marina with an area of 6 acres will provide a boat launching ramp and docking for 400 boats. The marina parking provides for 270 cars and trailers. The activities parking will park 28 cars.

SCALE: 1"=100'

MICHIGAN DEPARTMENT OF CONSERVATION PARKS AND RECREATION DIVISION

YANKEE SPRINGS RECREATION AREA GUN LAKE CAMPGROUND L.P. GAS DISTRIBUTION

SHEET NO. 1 OF 1 PLAN NO. E-137