

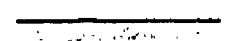



CONSERVATION COMMISSION	
BY: _____	DATE: _____
RECOMMENDED FOR APPROVAL: <i>H. J. Adams</i>	DESIGNER DATE: 7-13-66
RECOMMENDED FOR APPROVAL: <i>E. J. P. Taylor</i>	IN CHARGE OF DESIGN DATE: 7-14-66
SECTION APPROVAL	
BY: <i>Robert D. Dwyer</i>	DATE: 8-9-66
MICHIGAN DEPARTMENT OF CONSERVATION	
APPROVED: <i>E. C. MacLennan</i>	CHIEF ENGINEER DATE: 8-9-66
PLAN NO. E-142	PROJECT NUMBER PR152-258-1004-300-956
SHEET 1 OF 1	

### LEGEND

-  EXISTING ROADS & PARKING
-  PROPOSED ROADS & PARKING
-  EXISTING BUILDINGS
-  PROPOSED BUILDINGS
-  CAMPSITES
-  MIXED FOLIAGE

### KEY

- ③ ACTIVITIES CENTER
- ④ TOILET & SHOWERS
- ⑤ CAMPGROUND OFFICE
- ⑥ CONTROL BOOTH

### NOTES

THE CAMPGROUND OF 40 ACRES ACCOMMODATES 401 CAMPS, ACTIVITIES PARKING FOR 28 CARS, STORAGE & VISITOR PARKING FOR 29 CARS AND TRAILERS.

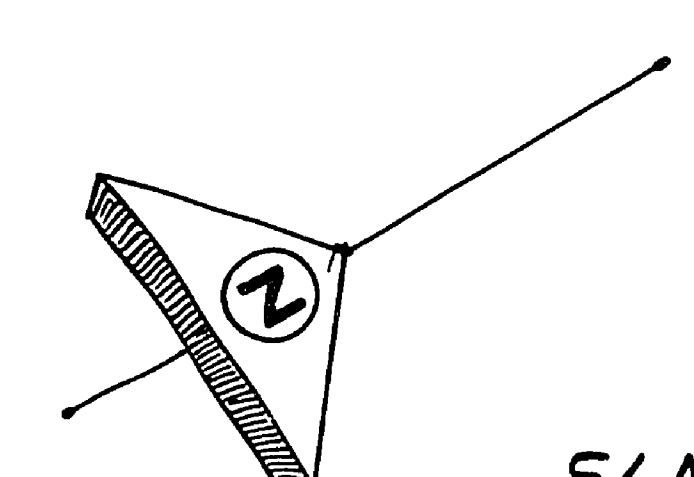
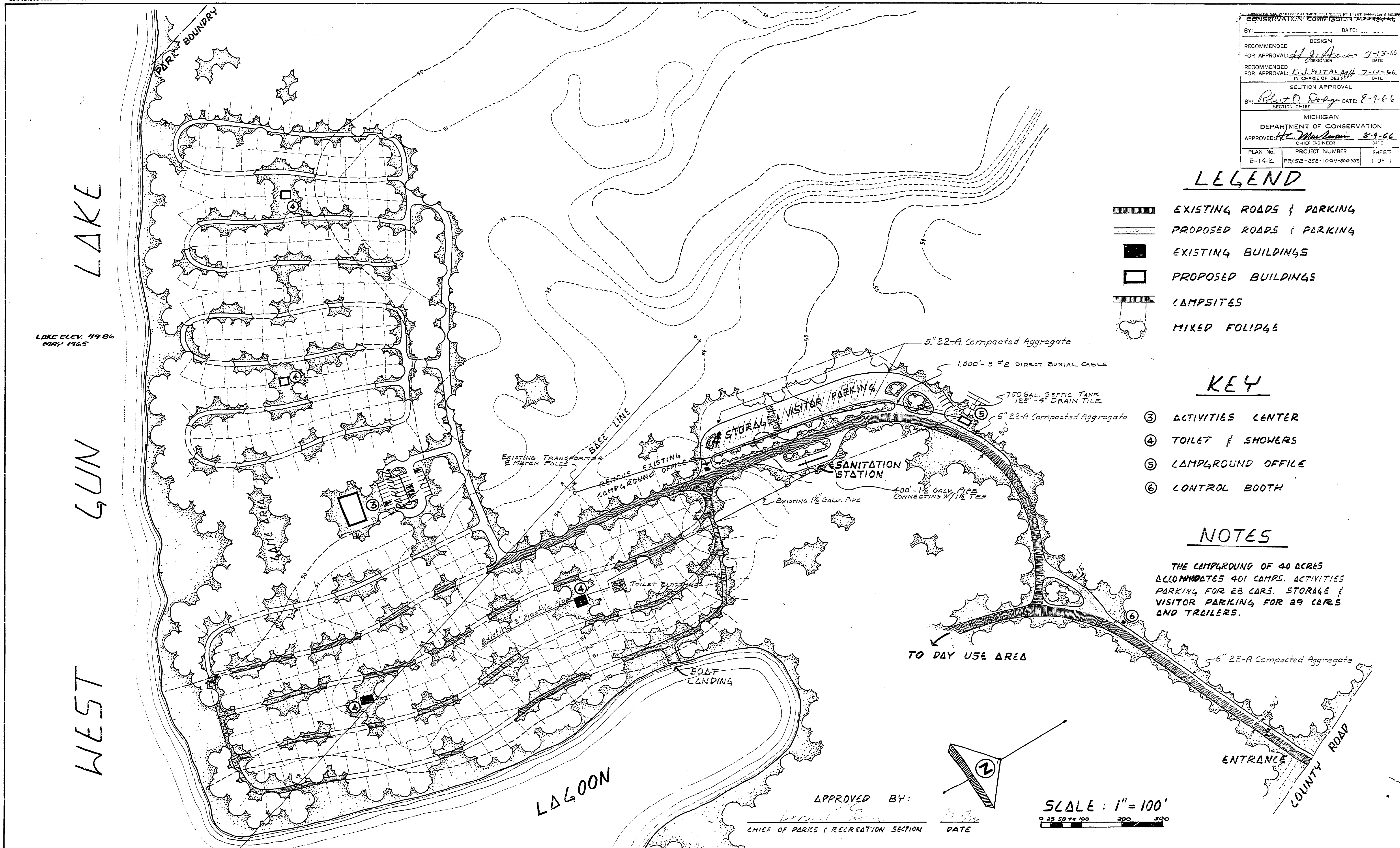

APPROVED BY: \_\_\_\_\_

CHIEF OF PARKS & RECREATION SECTION

DATE \_\_\_\_\_

SCALE: 1" = 100'

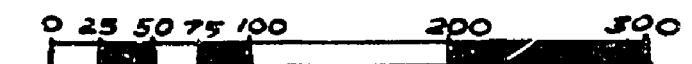

SURVEYED BY	DRAWN BY <b>A. D. CRONIN</b>	12-65	NO.	DATE	BY	REVISIONS	NO.	DATE	BY	REVISIONS
DESIGNED BY <i>F.G.F. &amp; W.J.P.</i>	7-11-66	CHECKED BY	1.				3.			
DATE	DATE	DATE	2.				4.			

MICHIGAN DEPARTMENT OF CONSERVATION

CONTROL BOOTH UTILITIES VISITORS PARKING ENTRANCE WIDENING

SHEET NO. \_\_\_\_\_ OF \_\_\_\_\_  
FOR PROJECT NO. PR 152-258-1004-300-956

YANKEE SPRINGS RECREATION AREA  
SHEET 1 OF 1 PLAN NO. E-142